

Product data sheet

LUHR 12

Linear ball bearing unit without seals

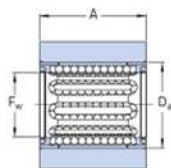

LUHR
With double lip seal

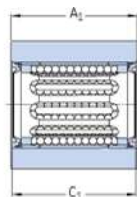

LUHR
With shaft seals

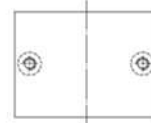
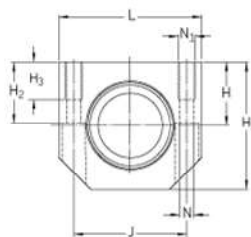

A [mm]:	28
D = Da [mm]:	19
Fw [mm]:	12
H [mm]:	17
H1 [mm]:	33
H2 [mm]:	16
H3 [mm]:	11
J [mm]:	29
L [mm]:	40
N [mm]:	4.3
N1:	M5
Ball rows [#]:	5
Cdyn [N]:	695

Date: 21/05/2020

The contents of this report are the copyright of the publisher and may not be reproduced (even extracts) unless permission is granted. Every care has been taken to ensure the accuracy of the information contained in this report but no liability can be accepted for any loss or damage whether direct, indirect or consequential arising out of the use of the information contained herein.

Product data sheet

LUHR 12

Linear ball bearing unit without seals

C0 [N]:	510
Weight [kg]:	0.08
A1[mm]:	35
C1[mm]:	34

Date: 21/05/2020

The contents of this report are the copyright of the publisher and may not be reproduced (even extracts) unless permission is granted. Every care has been taken to ensure the accuracy of the information contained in this report but no liability can be accepted for any loss or damage whether direct, indirect or consequential arising out of the use of the information contained herein.