

Features

- RS PRO 10 A male crimp contact.

RS PRO Industrial Power Connectors

RS Stock No.: 0630934, 0630935



RS Professionally Approved Products bring to you professional quality parts across all product categories. Our product range has been tested by engineers and provides a comparable quality to the leading brands without paying a premium price.

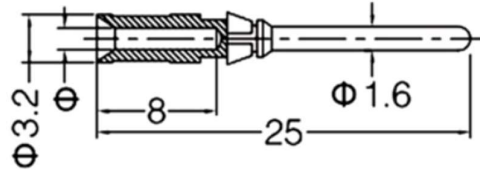

Part Code	Wire Gauge		d	Stripping length
	mm ²	AWG		
0630934	0.5	20	1.1	8 mm
0630935	0.75	18	1.3	8 mm

Technical Specification

Material	Copper alloy
Surface	Hard-silver plated
Rated current	10A
Contact resistance	≤ 3mΩ
Wire gauge	0.14-4 mm ²
Mating cycles	≥ 500
For stranded fine wire acc. to	IEC 60228-5