



External power supplies



AC/DC Single Output Desk top Type

16~36 Watts Max.

EA1024 Series



Features

- CEC level VI
- RoHS compliance
- Over voltage and over current protection
- Over temperature and short circuit protection
- Protection type: auto recovery
- MTBF: >30,000 hours
- No load power consumption <0.1W

Electrical Specifications

RS STOCK NO.	MODEL OUTPUT	VOLTAGE (Vo)	MAX. LOAD (Lo)	POWER (Watts)	LOAD REGULATION	LINE REGULATION	RIPPLE & NOISE
904-8474	EA1024C(01)	5V	4.0A	20W	+/- 5%	+/- 1%	2%
904-8483	EA1024C1(02)	6V	4.0A	24W	+/- 5%	+/- 1%	2%
904-8486	EA1024P1(11)	12V	3.0A	36W	+/- 5%	+/- 1%	1.5%
904-8509	EA1024R1(02)	24V	1.5A	36W	+/- 5%	+/- 1%	1.5%

NOTE:

- 1: Ripple & noise is measured by using 20MHz bandwidth limited oscilloscope and terminated each output with a 0.1uf ceramic capacitor & parallel with 47uF aluminum capacitor at full load and nominal line.
- 2: Line regulation is defined by changing $\pm 10\%$ of input voltage from nominal line at rated load.

Electrical Specifications

INPUT

- Input range: 100 to 240 VAC
- Frequency: 50 to 60Hz
- Input current: $\leq 1A$
- Inrush current: $\leq 60A$ at cold start
- Efficiency: meets CEC Level VI
- Hold up time: $\geq 8.3mS$
- Turn on time: $\leq 3s$

OUTPUT

- Over voltage protection: auto recovery
- Short circuit protection: auto recovery

ENVIRONMENTAL

- Operating temperature: 0 to 40°C
- Storage temperature: -20 to 85 °C
- Operating humidity: 10% to 90%

SAFETY

- UL/cUL UL60950-1, EN/IEC60950-1, TUV/SUD, GS, CB, CE, FCC

Mechanical Specification

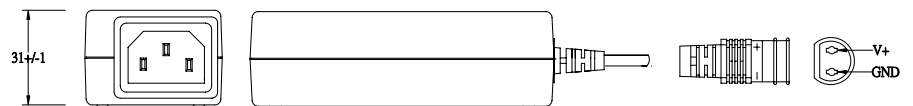
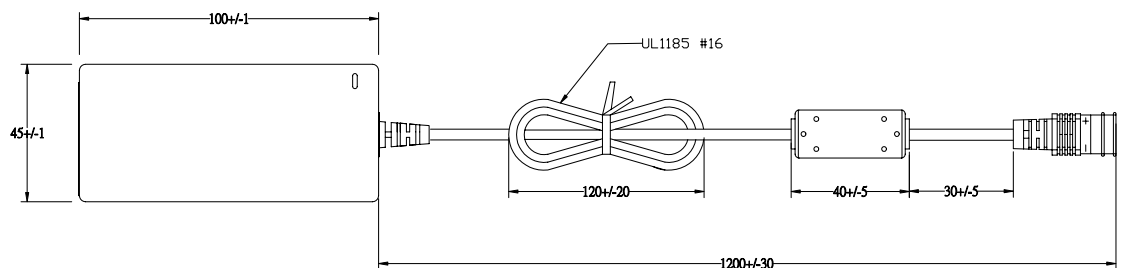

- Case Size: 100Lx45Wx31H (mm)
- AC Inlet: C14
- Weight: 200g

4.75 / 1.75 / 11.00mm

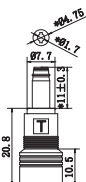

5.5 / 2.1 / 10.50mm

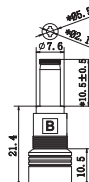

5.5 / 2.5 / 12.5mm

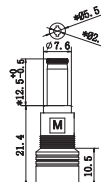

6.3 / 3.0 / 12.00mm

