



Relays & Contactors > Electromechanical Relays



Relay & Contactor Type: **General Purpose Power Relay**

Current Type: **DC**

Coil Magnetic System: **Non-Polarized, Monostable**

Contact Arrangement: **3 Form X**

Contact Current Rating: **25 A**

Features

Product Type Features

Relay & Contactor Type	General Purpose Power Relay
------------------------	-----------------------------

Configuration Features

Contact Arrangement	3 Form X
---------------------	----------

Electrical Characteristics

Coil Resistance	160 Ω
Contact Current Rating	25 A
Coil Voltage Rating	28 VDC

Body Features

Enclosure Type	Hermetically Sealed
----------------	---------------------

Contact Features

Contact Material	Silver Cadmium Oxide
Terminal Plating	Tin-Lead

Termination Features

Main Termination & Connection Type	Screw Terminals
Coil Termination & Connection Type	Screw Terminals

Mechanical Attachment

Product Mounting Feature Type	Mounting Brackets
-------------------------------	-------------------



Product Mount Type	Panel Mount
--------------------	-------------

Usage Conditions

Operating Temperature Range	-70 – 125 °C[-94 – 257 °F]
Environmental Ambient Temperature (Max)	125 °C[257 °F]

Operation/Application

Vibration Resistance	10G's, 5 – 1000Hz
Shock Resistance	50G's, 11ms
Current Type	DC
Coil Magnetic System	Non-Polarized, Monostable

Product Compliance

For compliance documentation, visit the product page on TE.com>

EU RoHS Directive 2011/65/EU	Not Compliant
EU ELV Directive 2000/53/EC	Not Compliant
China RoHS 2 Directive MIIT Order No 32, 2016	Restricted Materials Above Threshold
EU REACH Regulation (EC) No. 1907/2006	Current ECHA Candidate List: JAN 2025 (247) Candidate List Declared Against: JAN 2025 (247) SVHC > Threshold: Cd (10% in Component Part) Article Safe Usage Statements: Use personal protective equipment as required. Do not eat, drink or smoke when using this product. Recycle if possible and dispose of the article by following all applicable governmental regulations relevant to your geographic location.
Halogen Content	Low Halogen - Br, Cl, F, I < 900 ppm per homogenous material. Also BFR/CFR/PVC Free
Solder Process Capability	Not lead free process capable

Product Compliance Disclaimer

This information is provided based on reasonable inquiry of our suppliers and represents our current actual knowledge based on the information they provided. This information is subject to change. The part numbers that TE has identified as EU RoHS compliant have a maximum concentration of 0.1% by weight in homogenous materials for lead, hexavalent chromium, mercury, PBB, PBDE, DBP, BBP, DEHP, DIBP, and 0.01% for cadmium, or qualify for an exemption to these limits as defined in the Annexes of Directive 2011/65/EU (RoHS2). Finished electrical and electronic equipment products will be CE marked as required by Directive 2011/65/EU. Components may not be CE marked. Additionally, the part numbers that TE has identified as EU ELV compliant have a maximum concentration of 0.1% by weight in homogenous materials for lead, hexavalent chromium, and mercury, and 0.01% for cadmium, or qualify for an exemption to these limits as defined in the Annexes of Directive 2000/53/EC (ELV). Regarding the REACH Regulations, TE’s information on SVHC in articles for this part number is still based on the European Chemical Agency (ECHA) ‘Guidance on requirements for substances in articles’(Version: 2, April 2011), applying the 0.1% weight on weight concentration threshold at the finished product level. TE is aware of the European Court of Justice ruling of September 10th, 2015 also known as O5A (Once An Article Always An Article) stating that, in case of ‘complex object’, the threshold for a SVHC must be applied to both the product as a whole and simultaneously to each of the articles forming part of its composition. TE has evaluated this ruling



based on the new ECHA “Guidance on requirements for substances in articles” (June 2017, version 4.0) and will be updating its statements accordingly.

Compatible Parts

TE Part # 1617807-3
FC-335-SY3=RELAY, 3PST

TE Part # 9-1617803-3
FC-335-CW3= RELAY 3PST

TE Part # 1-1617827-6
FCC-360-TU9 =60A CONTACTOR,TH
TRM AUX AC

TE Part # 1617807-5
FC-335-SY8= RELAY, 3PST

TE Part # 1-1617827-4
FC-360-TU9 =60A CONTACTOR,TH
TERM AC

TE Part # 1-1617827-5
FCC-360-TU4 =60A CONTACTOR,TH
TERM W/AUX

TE Part # 1-1617827-3
FC-360-TU4 =60A CONTACTOR,
THREADED TERM

Also in the Series | CII FC-325

AC Relays(8)

DC Relays(8)

Electromechanical Relays(16)

Customers Also Bought

TE Part #320575
TERMINAL,PIDG R 16-14 5/16

TE Part #193495-000
D-150-0179

TE Part #110219-000
CTA-1160

TE Part #2-1617088-4
3SAM6015M2 = RELAY



TE Part #2-323975-3
SPLICE, BUTT, PIDG, 24-20, T&R



TE Part #1393118-2
KUP-14A55-24=KU



TE Part #CAT-C7901-AL82
COPALUM Sealed: Butt Splices



TE Part #3-1617019-7
FW1120G01 = M5757/10-039

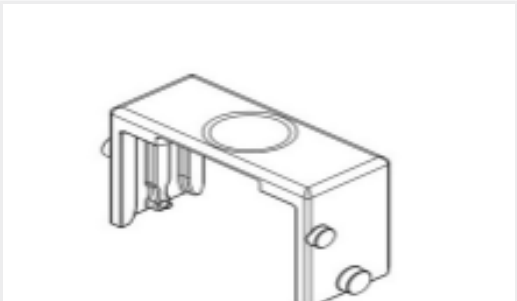

TE Part #1877800-1
CAM, SLIDE, PLUG-N-PLAY

Documents

Product Drawings

FC-325-5=MS27418-2B

English

CAD Files

3D PDF

3D

Customer View Model

ENG_CVM_CVM_3-1617806-6_A.2d_dxf.zip

English

Customer View Model

ENG_CVM_CVM_3-1617806-6_A.3d_igs.zip

English

Customer View Model

ENG_CVM_CVM_3-1617806-6_A.3d_stp.zip

English

By downloading the CAD file I accept and agree to the [Terms and Conditions](#) of use.

Datasheets & Catalog Pages

CII FC-325 Series Relay

English