

Rittal
SK

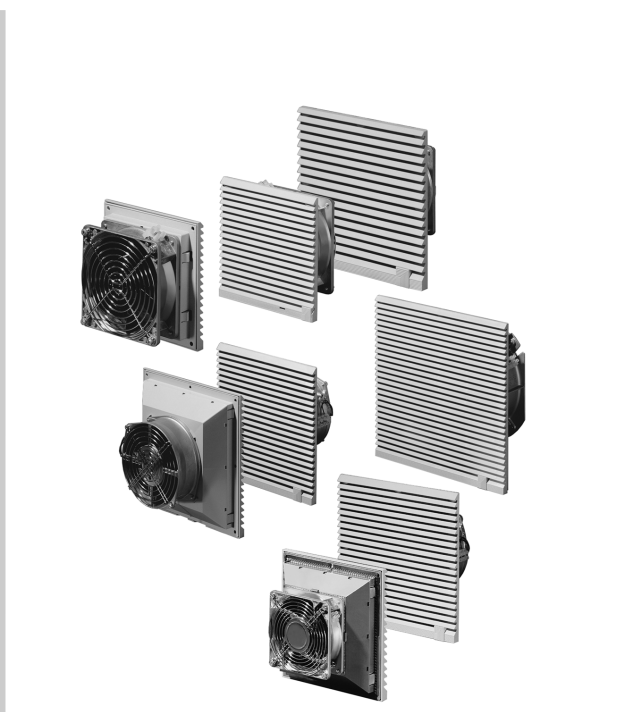

Filterlüfter

**Fan-and-filter
units**

**Ventilateur
à filtre**

Ventilator

Filterfläkt

Ventilatore-filtro

**Ventilador
con filtro**

SK 3321.xxx

SK 3327.xxx

Montageanleitung

Assembly instructions

Notice de montage

Montage-instructie

Montageanvisning

Istruzioni di montaggio

Instrucciones de montaje

取扱説明書

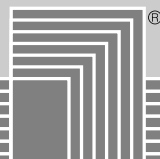

Umschalten auf Perfektion RITTAL

Model No. fan-and-filter units SK	3321.100 3321.107 3321.600	3321.115 3321.117 3321.615	3321.024 3321.027	3321.048 3321.047	3327.100 3327.600	3327.115 3327.615	3327.140
Rated voltage Volt/Hz	230/50/60	115/50/60	24 (DC)	48 (DC)	230/50/60	115/50/60	400/50/60, 3~
Air throughput unimpeded airflow	20/25 m ³ /h				700/720 m ³ /h <small>460/60/3~</small>		
Axial fan	self-starting shaded pole motor		DC motor		self-starting shaded pole motor		AC motor
Rated current	69 mA/ 58 mA	138 mA/ 115 mA	125 mA	0.09 A	0.65 A/ 0.95 A	1.50 A/ 2.00 A	0.27 A/ 0.33 A
Nominal output	12.5 W/10.3 W		3.0 W	4.1 W	155 W/212 W	167 W/230 W	146 W/205 W
Noise level	41/46 dB (A)				70/72 dB (A)		
Spare filter mats	3321.700	3321.700	3321.700	3321.700	3327.700	3327.700	3327.700
Fine filter mat	-	-	-	-	3183.100	3183.100	3183.100
Hose-proof hood	3321.800	3321.800	3321.800	3321.800	3326.800	3326.800	3326.800
Temperature range	- 10 °C to + 55 °C						
Protection category to EN 60 529/10.91	IP 54 by using of filter mat IP 55 by using of filter mat and hose-proof hood. Complies with NEMA 1.						

2. Assembly

Observe sequence of assembly 1 – 4, and mounting position!

Airflow direction can be changed by reversing the fitting of fan. Quick-assembly system for fan-and-filter units and outlet filter.

Simply snap into place, and that's it.

3. Electrical connection

Supply voltage and frequency must correspond to the rated values stated on the nameplate. The relevant requirements of the local electricity board must be observed.

Electrical connection and repair must be carried out by authorised specialist personnel only.

Use original spares only.

4. Filter replacement and cleaning

The frequency of filter replacements should be determined individually, depending on dust accumulation and operating period.

Note: Filter replacement must be carried out in good time.

A soiled filter mat will cause the temperature to rise inside the enclosure!

The filter mat can be regenerated by washing or blowing out.

5. Supply includes

1 fan-and-filter unit, ready for connection,
1 drilling template.

6. Guarantee

We will guarantee this unit, if used correctly, for 1 year in respect of materials and manufacturing faults, from the date of its supply.

7. Waste disposal

The plastic material used in the components can be recycled.

8. Accessories

8.1 Spare filter mats, fine filter mats

8.2 Hose-proof hood

8.3 Thermostat SK 3110.000

8.4 Temperature indicator with switch contact
SK 3114.000 (only for 230 V AC fan)

8.5 Speed control SK 3120.000
(only for 230 V AC fan).

9. Colour

RAL 7032: SK 33xx.100 / .115 / .048 / .024 / .140

RAL 7035: SK 33xx.107 / .117 / .047 / .027

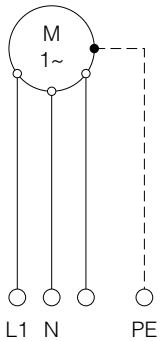
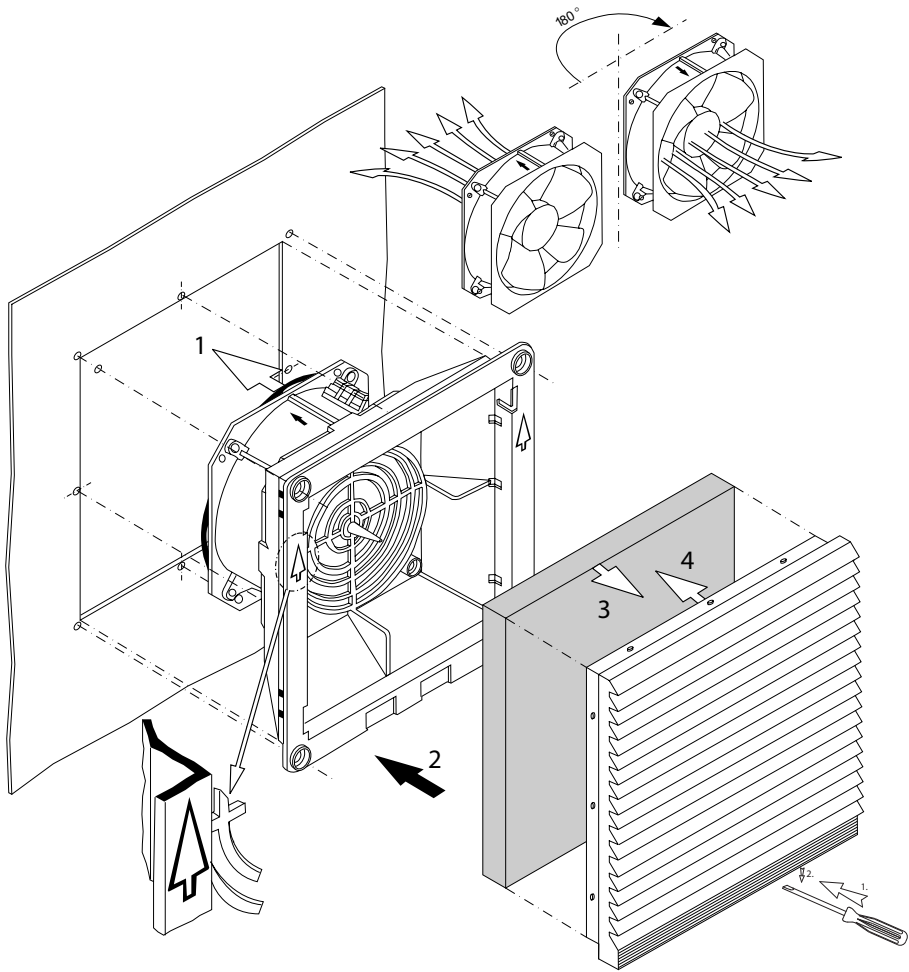

SK 3321. . . .

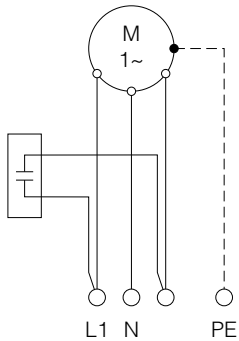

SK 3327.100 / .600
SK 3327.115 / .615

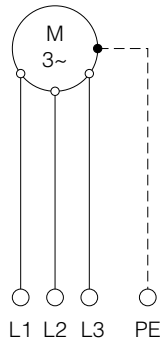

SK 3327.140



Schaltschrank-Systeme
Industrial Enclosures
Systèmes d'armoires électriques
Schackelkastsystemen
Apparatskåpsystem
Systemi di armadi per quadri di comando
Sistemas de armarios de distribución
エンクロージャシステム



Elektronik-Aufbau-Systeme EL
Electronic Packaging EL
Systèmes d'intégration électronique EL
Elektronica opbouwsystemen EL
Elektronikuppbyggnad och inkapsling EL
Systemi di allestimento per l'elettronica industriale EL
Sistemas para electrónica EL
エレクトロニクスシステム EL



System-Klimatisierung SK
System Climate Control SK
Systèmes de climatisation SK
Systemklimatisering SK
Systemklimatisering SK
Soluzioni di climatizzazione per quadri di comando SK
Climatización de sistemas SK
システム空調製品 SK

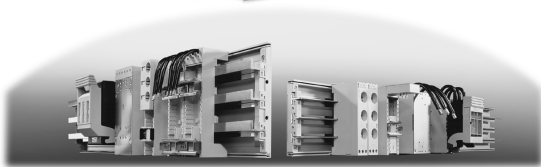

Stromverteilung SV
Power Distribution SV
Distribution du courant SV
Stroomverdeling SV
Strömfördelning SV
Distribuzione di corrente SV
Distribución de corriente SV
ブスバー分電・配電システム SV



IT-Solutions
IT Solutions
Solutions IT
IT-Solutions
IT-lösningar
Soluzioni per IT
Soluciones TI
IT ソリューションシステム



Communication Systems CS
Communication Systems CS
Solutions Télécom CS
Outdoor-behauzungen CS
Utomhuskåp CS
Soluzioni outdoor CS
Sistemas para comunicaciones CS
通信用エンクロージャシステム CS

Rittal GmbH & Co. KG · Postfach 1662 · D-35726 Herborn
Telefon (02772) 505-0 · Telefax (02772) 505-2319 · eMail: Info@rittal.de · www.rittal.de