

CHARACTERISTICS

ELECTRICAL:

RATINGS:		SEA LEVEL	
LOAD	28 VDC	115 VAC	
RESISTIVE	10 AMPS	10 AMPS	
INDUCTIVE	5 AMPS	5 AMPS	
LAMP	3 AMPS	3 AMPS	
DWV	1050 VRMS		

CENTER CONTACTS: 3 AMPS. MAX.
ELECTRICAL LIFE: 100,000 CYCLES AT FULL LOAD.

MECHANICAL:

TRAVEL TRAVEL: .075±.015
OVERTRAVEL: .012 MIN. ■
RESET TRAVEL: .012 MIN. ■
MOVEMENT DIFFERENTIAL: .015 MIN.
OPERATING FORCE: 2.5± .5 LBS. (B)
RESET FORCE: .75 LB. MIN.
MECHANICAL LIFE: 1,000,000 CYCLES

PHYSICAL:

TEMPERATURE RANGE: -55°C TO +85°C
ENCLOSURE DESIGN: WATERTIGHT PER IP68S,
1 METER

BUTTON: NYLON, RED
CASE: BLACK ANODIZED
ALUMINUM ALLOY

MARK: OTTO, 21649,
P3-D000048
DATE CODE(YYWW)

MOUNTING HARDWARE: HEXNUT & LOCKWASHER

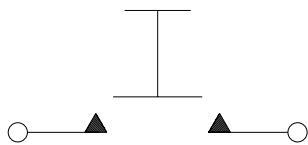

■ MANUFACTURING

▲ SPC

UNLESS OTHERWISE SPECIFIED:
DIMENSIONS ARE IN INCHES.
TOLERANCES ARE AS LISTED.
MUST BE FREE FROM BURRS
AND SHARP EDGES.

TOLERANCES
.XX ±.03
.XXX ±.010
ANGLES ±2°
DO NOT SCALE DRAWING.
THIRD ANGLE PROJECTION

OTTO CONTROLS
DIVISION OF
OTTO ENGINEERING INC.
CARPENTERSVILLE, ILLINOIS USA

THIS DOCUMENT IS THE CONFIDENTIAL
PROPERTY OF OTTO ENGINEERING, INC..
IT IS PROVIDED ON A RESTRICTED
BASIS AND IS NOT TO BE USED IN ANY
WAY DETRIMENTAL TO THE INTERESTS
OF OTTO ENGINEERING, INC..

DESCRIPTION
**P3, RAISED DOME
N.O. SWITCH**

DRWN. KS	SIZE	FSCM NO	DRAWING NO.	REV.
CHKD. REO	A	21649	P3-D000048	C
APPD. DR				
DATE 06-Jun-02	WT.		Scale 1:1	Sheet 1 OF 1

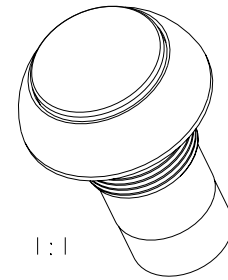

SCALE 1:1

P3-D000048

REV	OCN #	DATE	APR
A	013315	06 JUN 02	REO
B	013845	22 JUL 02	REO
C	015726	18 DEC 02	REO

