

# XTRA

**XTRA offers a range of rugged and tough surface metalclad accessories for any industrial or commercial project.**



The coverplates are produced from high quality steel with epoxy powder coating for corrosion resistance.

Essential Supply products are offered enabling circuits to be highlighted effectively with unmistakable red identification in the form of red rockers and fuse drawers without compromising their suiting with other standard accessories.

Blank plates	131
Fused connection units	128-129
Coverplates - grid/Options/ voice/data	131-132
Essential supply products	126
Fan isolator switch	129
RCD sockets	128
Sockets, 13amp	125-126
Sockets, outboard 13amp	125-126
Sockets - 13amp non-standard/ clean earth	125-126

Sockets - 5/15amp	127
Switches - 10amp	129
Switches - 20amp	130
Switches - 32amp TP&N	130
Switches - 50amp	131
Telephone outlets	131
Technical information	134-137

## Socket Outlets

### 13A Socket Outlets



NEW REF: OLD REF:

**X111MG** 1G socket (FM3041)

**X112MG** 2G socket (FM3042)

### 13A Non Standard/Clean Earth Socket Outlets

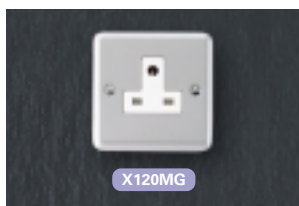

NEW REF: OLD REF:

**X130MG** (FM4120)

1G clean earth socket

**X120MG** (FM4121)

1G non-standard/clean earth socket

**F3368** Non-standard plug top

#### To BS 1363:Part 2:1995

Terminals capable of accepting up to 3 x 4mm<sup>2</sup> or 2 x 6mm<sup>2</sup> conductors.

Non-standard socket interface to BS 5733 with clean earth facility.

Standard socket interface to BS 1363 with clean earth facility.

Dimensions:

1G - 86mm x 86mm

2G - 86mm x 146mm

Fixing centres:

1G - 60.3mm

2G - 120.7mm

Complete with mounting box.

### 13A SP Switched Sockets

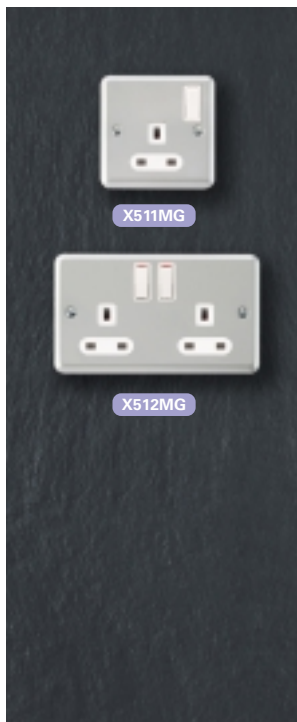

**X511MG** 1G

**X512MG** 2G

#### To BS 1363:Part 2:1995

Terminals capable of accepting up to 3 x 4mm<sup>2</sup> or 2 x 6mm<sup>2</sup> conductors.

Dimensions:

1G - 86mm x 86mm

2G - 86mm x 146mm

Fixing centres:

1G - 60.3mm

2G - 120.7mm

Complete with mounting box.

### 13A DP Switched Sockets 2 E Terminals Inboard Rockers



**X521MG** 1G

**X521NMG** 1G + neon

**X521NRRMG** 1G + neon + red rockers

**X521RRMG** 1G + red rockers

**X522MG** 2G

**X522NMG** 2G + neon

**X522NRRMG** 2G + neon + red rockers

**X522RRMG** 2G + red rockers

#### To BS 1363:Part 2:1995

Terminals capable of accepting up to 3 x 4mm<sup>2</sup> or 2 x 6mm<sup>2</sup> conductors.

Dimensions:

1G - 86mm x 86mm

2G - 86mm x 146mm

Fixing centres:

1G - 60.3mm

2G - 120.7mm

Complete with mounting box.

### 13A 2G DP Outboard Switched Sockets

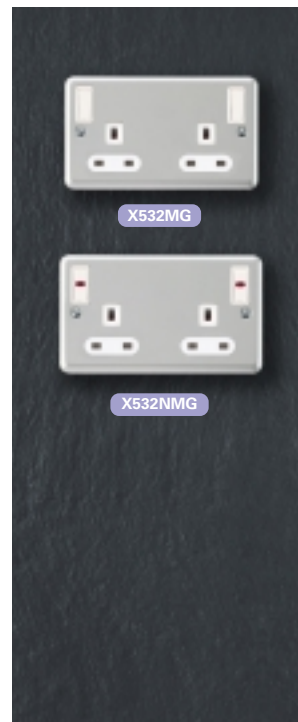

**X532MG** 2G with 2 earth terminals

**X532NMG** 2G with 2 earth terminals + neon

#### To BS 1363:Part 2:1995

Terminals accept up to 3 x 4mm<sup>2</sup> or 2 x 6mm<sup>2</sup> conductors.

Dimensions:

2G - 86mm x 146mm

Fixing centres:

2G - 120.7mm

Complete with mounting box.



## Socket Outlets

### 13A 2G DP Outboard Switched Sockets

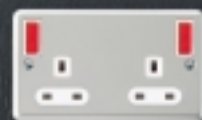

X532RRMG



X532NRRMG

**X532RRMG** 2G with 2 earth terminals + red rockers

**X532NRRMG** 2G with 2 earth terminals + red rockers + neon

### 13A 1G DP Non-Standard/Clean Earth Switched Sockets



X551NMG

**X551MG** 1G

**X551NMG** 1G with neon

**X551RRMG** 1G with red rocker

**X551NRRMG** 1G with red rocker + neon

**F3368** Non-standard plug top

Non-standard socket interface to **BS 5733** with clean earth facility.

Dimensions:  
1G - 86mm x 86mm

Fixing centres:  
1G - 60.3mm

Complete with mounting box.

### 13A 2G DP Clean Earth/Non-Standard Switched Sockets Outboard Rockers



X552MG

**X552MG** 2G with 2 earth terminals

**X552NMG** 2G with 2 earth terminals + neon

**X552RRMG** 2G with 2 earth terminals + red rockers + neon

**X552NRRMG** 2G with 2 earth terminals + red rockers + neon

Non-standard socket interface to **BS 5733** with clean earth facility.

Dimensions:  
2G - 86mm x 146mm

Fixing centres:  
2G - 120.7mm

Complete with mounting box.

### 13A 1G DP Clean Earth Switched Sockets



X571MG



X571NMG

**X571MG** 1G

**X571NMG** 1G with neon

**X571RRMG** 1G with red rockers

**X571NRRMG** 1G with red rockers + neon

2 clean earth terminals and 2 standard earth terminals on each product.

Standard socket interface to **BS 1363** with clean earth facility.

Dimensions:  
1G - 86mm x 86mm

Fixing centres:  
1G - 60.3mm

Complete with mounting box.

### 13A 2G DP Clean Earth Standard Sockets Outboard Rockers



X572MG



X572NMG

**X572MG** 2G with 2 earth terminals

**X572NMG** 2G with 2 earth terminals + neon

**X572RRMG** 2G with 2 earth terminals + red rockers

**X572NRRMG** 2G with 2 earth terminals + red rockers + neon

2 clean earth terminals and 2 standard earth terminals on each product.

Standard socket interface to **BS 1363** with clean earth facility.

Dimensions:  
2G - 86mm x 146mm

Fixing centres:  
2G - 120.7mm

Complete with mounting box.

Essential Service Products - red rockers

■ Highlights essential supply circuits where extra safety is a vital consideration.

- Hospitals
- Laboratories
- Computer installations

■ Circuits can be quickly and easily identified.

To **BS 1363:Part 2:1995**

Terminals accept up to 3 x 4mm<sup>2</sup> or 2 x 6mm<sup>2</sup> conductors.

Dimensions:  
2G - 86mm x 146mm

Fixing centres:  
2G - 120.7mm

Complete with mounting box.

## Sockets Outlets

### 5A Sockets

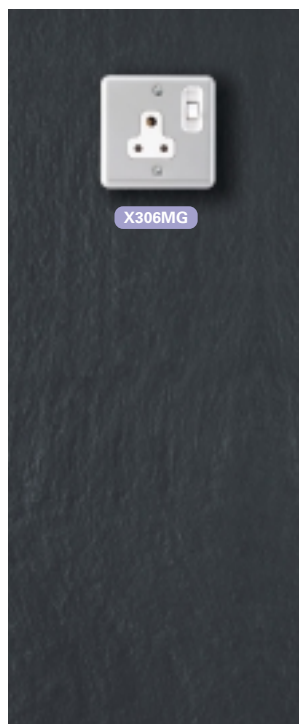

X306MG

NEW REF:	OLD REF:
<b>X306MG</b>	(FM4022)
1G switched	
<b>X305MG</b>	(FM3084)
1G unswitched	

**To BS 546:1950**  
 Dimensions:  
 1G - 86mm x 86mm  
 Fixing centres:  
 1G - 60.3mm  
 Complete with mounting box.

### 15A Sockets

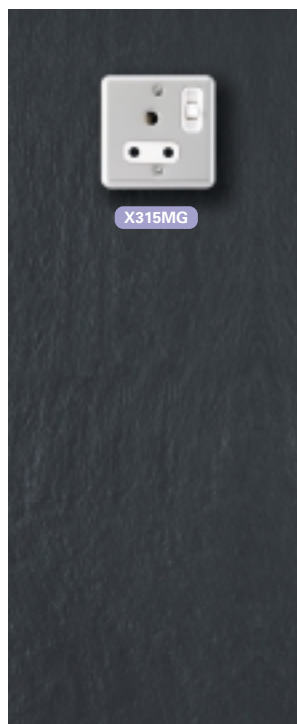

X315MG

NEW REF:	OLD REF:
<b>X315MG</b>	(FM4032)
1G switched	

**To BS 546:1950**  
 Dimensions:  
 1G - 86mm x 86mm  
 Fixing centres:  
 1G - 60.3mm  
 Complete with mounting box.

### 127V SASO Switched Socket

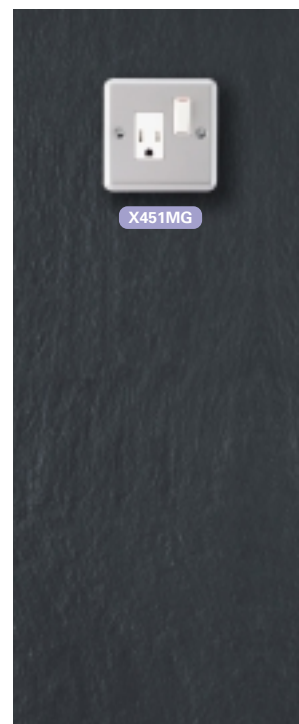

X451MG

NEW REF:	OLD REF:
<b>X451MG</b> 1G	(FM3627)
<b>X452MG</b> 2G	(FM3631)
<b>X451NMG</b> 1G with neon	(FM3635)
<b>X452NMG</b> 2G with neon	(FM3639)

**To SASO 444**  
 Dimensions:  
 1G - 86mm x 86mm  
 2G - 86mm x 146mm  
 Fixing centres:  
 1G - 60.3mm  
 2G - 120.7mm  
 Complete with mounting box.

## RCD Socket Outlets/Fused Connection Units

### 13A DP RCD Sockets

NEW



X585MG

#### NEW REF:

**X585MG** RCD Protected Socket  
Passive 10mA

**X586MG** RCD Protected Socket  
Passive 30mA

**X587MG** RCD Protected Socket  
Active 10mA

**X588MG** RCD Protected Socket  
Active 30mA

- Added protection against electrocution
- Active or Passive switching
- 10mA or 30mA protection

**PASSIVE** - The contacts on the Passive device remain closed when the mains supply is interrupted - this type is suitable for appliances such as fridge freezers etc.

**ACTIVE** - The contacts on the Active device open when the mains supply is interrupted - this type is suitable of Power tools, lawnmowers, hedge trimmers etc.

Dimensions  
2G - 86mm x 146mm

Fixing centres  
2G - 120.7mm

Complete with mounting box.

### 13A DP Fused Connection Units - Switched



X201MG



X201NMG

#### NEW REF:

#### OLD REF:

**X201MG** (FM3242)  
DP with optional c/outlet

**X201NMG** (FM3244)  
DP with neon + optional c/outlet

#### To BS 1363: Part 4: 1995

Live and neutral up to 3 x 4mm<sup>2</sup> or 2 x 6mm<sup>2</sup> conductors. Separate earth terminals are provided for standard and hard wiring connections.

Dimensions:  
1G - 86mm x 86mm

Fixing centres:  
1G - 60.3mm

Complete with mounting box.

### 13A Connection Units - Unswitched



X200MG



X200NMG

#### NEW REF:

#### OLD REF:

**X200MG** (FM3246)  
Unswitched with optional c/outlet

**X200NMG** (FM3248)  
Unswitched with neon  
+ optional c/outlet

#### To BS 1363: Part 4: 1995

Live and neutral up to 3 x 4mm<sup>2</sup> or 2 x 6mm<sup>2</sup> conductors. Separate earth terminals are provided for standard and hard wiring connections.

Dimensions:  
1G - 86mm x 86mm

Fixing centres:  
1G - 60.3mm

Complete with mounting box.

## Fused Connection Units and Switches

### 13A Connection Units Red Rockers/Fuse Drawers

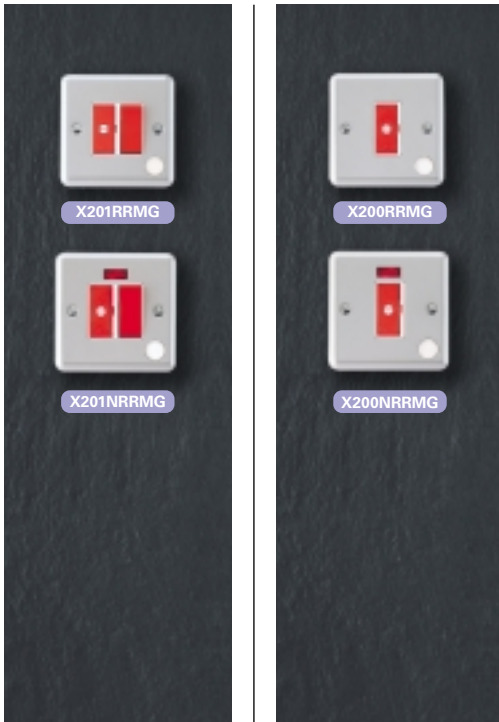

NEW REF:		OLD REF:
<b>X201RRMG</b>	DP switched fused with optional c/outlet + red rockers	(FM3242RR)
<b>X201NRRMG</b>	DP switched fused with neon + optional c/outlet + red rockers	(FM3244RR)
<b>X200RRMG</b>	Unswitched with optional c/outlet + red fuse drawers	(FM3246RR)
<b>X200NRRMG</b>	Unswitched with neon + optional c/outlet + red fuse drawers	(FM3248RR)

### 10A Switches

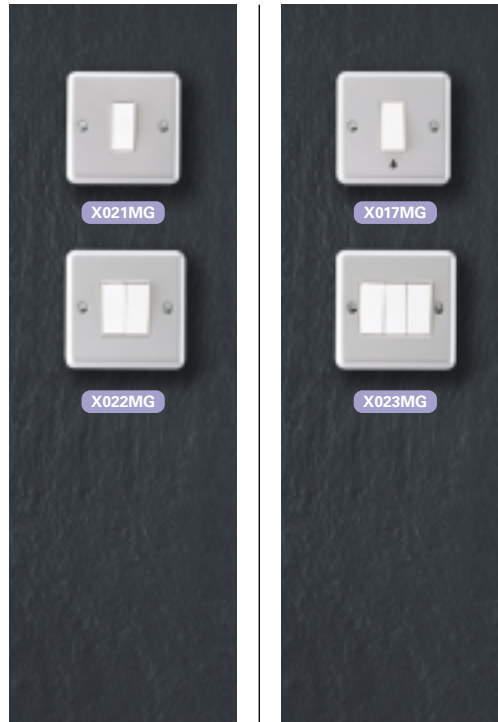

NEW REF:		OLD REF:
<b>X021MG</b>	1G 2W	(FM2441)
<b>X022MG</b>	2G 2W	(FM2442)
<b>X023MG</b>	3G 2W	(FM2443)
<b>X017MG</b>	1G intermediate	(FM2444)
<b>X015MG</b>	1G 1W bell push	(FM2445)

### 3 Pole Isolator Switches

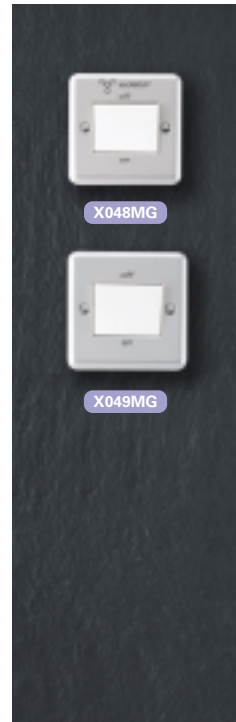

NEW REF:	OLD REF:
<b>X048MG</b>	(FM2896)
Broad fan isolator	
<b>X049MG</b>	(FM2897)
Broad isolator	

■ Highlights essential supply circuits where extra safety is a vital consideration.

- Hospitals
- Laboratories
- Computer installations

■ Circuits can be quickly and easily identified.

#### To BS 1363:Part 4:1995

Live and neutral accepts 3 x 2.5mm<sup>2</sup> cables

Dimensions:  
1G - 86mm x 86mm

Fixing centres:  
1G - 60.3mm

Complete with mounting box.

#### To BS 3676:Part 1:1989

Supplied with M3.5 fixing screws. Each terminal is capable of accepting up to 3 x 1.5mm<sup>2</sup> conductors.

All terminal screws are backed off, ready to accept cable. X-rated for fluorescent or inductive loads.

Dimensions:  
1G - 86mm x 86mm

Fixing centres:  
1G - 60.3mm

Complete with mounting box.

#### To BS 3676:Part 1:1989

Dimensions:  
1G - 86mm x 86mm

Fixing centres:  
1G - 60.3mm

Complete with mounting box.

## Switches

### 10A Broad Rocker Switches

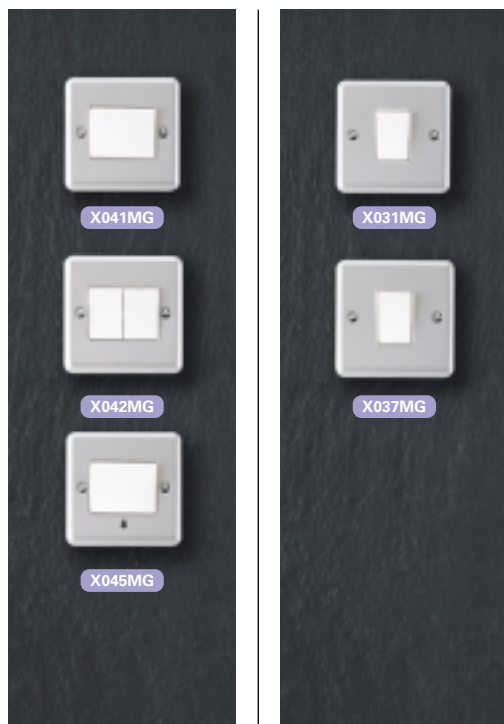

NEW REF:		OLD REF:
<b>X041MG</b>	1G 2W	(FM2890)
<b>X042MG</b>	2G 2W half broad	(FM2891)
<b>X045MG</b>	1G 1W bell push	(FM2894)
<b>X047MG</b>	1G intermediate	(FM2895)
<b>X031MG</b>	1G 2W half broad	(FM2898)
<b>X037MG</b>	1G 1W intermediate half broad	(FM2899)

#### BS 3676:Part 1: 1989

Broad Rocker individual modules can be removed for replacement/maintenance. Interchangeable with standard switch range and Options modules. X-rated for fluorescent or inductive loads.

Dimensions:  
1G - 86mm x 86mm

Fixing centres:  
1G - 60.3mm

Complete with mounting box.

### 10A DP Broad Switches

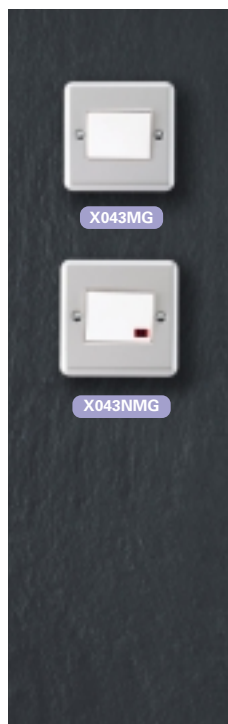

NEW REF:	OLD REF:
<b>X043MG</b>	(FM2892)
1G	
<b>X043NMG</b>	(FM2893)
1G with neon	

#### BS 3676:Part 1: 1989

Dimensions:  
1G - 86mm x 86mm

Fixing centres:  
1G - 60.3mm

Complete with mounting box.

### 20A DP Switches

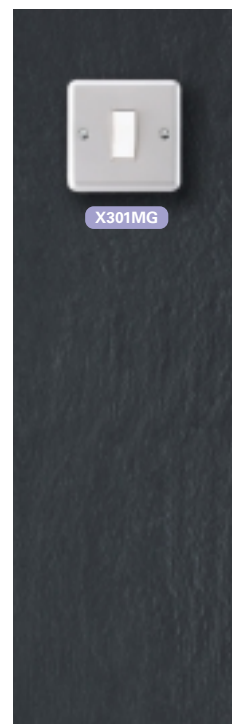

NEW REF:	OLD REF:
<b>X301MG</b>	(FM2241N)
DP switch	
<b>X301NMG</b>	(FM2242N)
DP switch with neon	

#### BS EN 60669-1

Dimensions:  
1G - 86mm x 86mm

Fixing centres:  
1G - 60.3mm

Complete with mounting box.

### 32A TP & N Switch

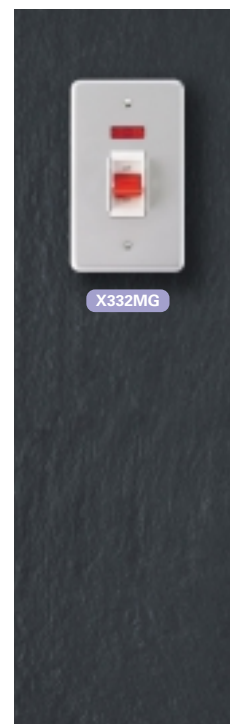

NEW REF:	OLD REF:
<b>X332MG</b>	(FM4304)
32A TP & N switch	

#### To BS EN 60947-3: 1999

Terminal capacity 16mm<sup>2</sup> conductors.  
Box knockouts: 4 x 20mm<sup>2</sup>  
4 x 25mm<sup>2</sup>

Dimensions: H = 147mm  
W = 86mm, D = 65mm

Rated at 440 volts with a motor load rating of up to 12KW-16HP at 415V 3 phase.

Utilisation category of AC22 for switching of mixed, resistive and inductive loads including moderate overloads. Lock ON/OFF facility.

Complete with mounting box.



## Switches/Options Front Plates

### 50A DP Switches

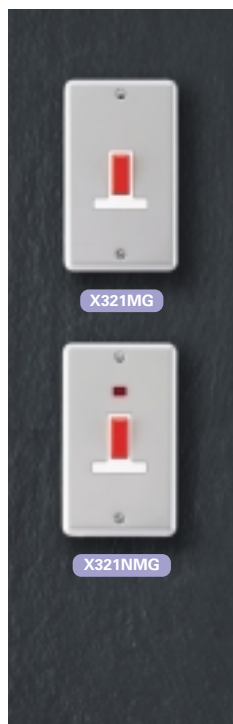

NEW REF:	OLD REF:
<b>X321MG</b>	(FM2115)
DP switch	
<b>X321NMG</b>	(FM2116)
DP switch with neon	

#### To BS EN 60669-1

Dimensions:  
2G - 86mm x 146mm

Fixing centres:  
2G - 120.7mm

Complete with mounting box.

### Telephone Outlets

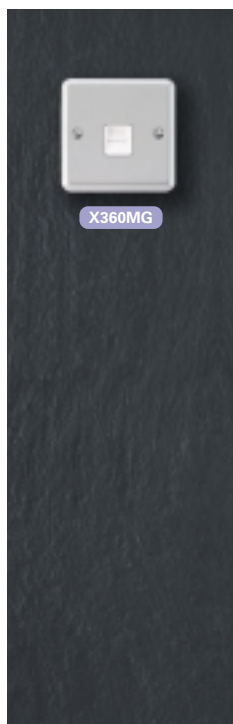

NEW REF:	OLD REF:
<b>X360MG</b>	(FM3586)
Single master	
<b>X361MG</b>	(FM3587)
Single secondary	

Dimensions:  
1G - 86mm x 86mm

Fixing centres:  
1G - 60.3mm

Complete with mounting box.

### Blank Plates

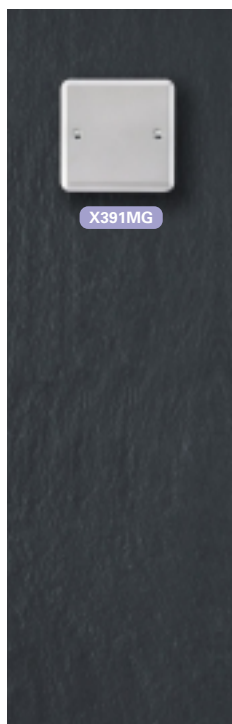

NEW REF:	OLD REF:
<b>X391MG</b> 1G	(FM5041)
<b>X392MG</b> 2G	(FM5042)

Dimensions:  
1G - 86mm x 86mm  
2G - 86mm x 146mm

Fixing centres:  
1G - 60.3mm  
2G - 120.7mm

### 10A Options Plates



NEW REF:	OLD REF:
<b>X863MG</b>	(FM1918)
3G plate (accepts 1 broad, 2 half broad or 3 standard modules)	
<b>X871MG</b>	(FM1935)
Half broad plate	
<b>X866MG</b>	(FM1940)
6G plate (accepts broad, half broad and standard modules)	

#### Mounting boxes **with k/o**

1G - FM8340  
2G - FM8341

#### **without k/o**

1G - FM8349  
2G - FM8350

To be used in conjunction with options modules see page 150.

### Voice/Data Module Frames

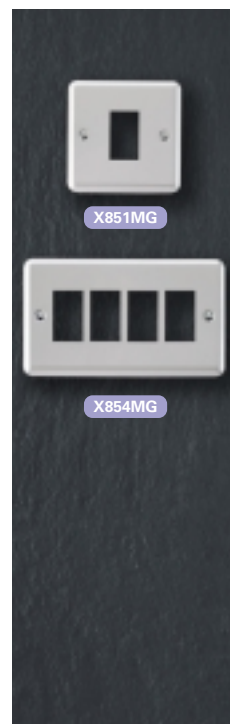

NEW REF:	OLD REF:
<b>X851MG</b> 1G	(FM3667)
<b>X852MG</b> 2G	(FM3672)
<b>X854MG</b> 4G	(FM3677)

#### Mounting boxes **with k/o**

1G - FM8340  
2G - FM8341

#### **without k/o**

1G - FM8349  
2G - FM8350

For modules options please refer to page 152.



## Coverplates

### Grid Plates (Surface Metalclad)



X801MG



X802MG

NEW REF:	OLD REF:
<b>X801MG</b>	(FM8250)
1G surface	
<b>X802MG</b>	(FM8251)
2G surface	
<b>X803MG</b>	(FM8252)
3G surface	
<b>X804MG</b>	(FM8253)
4G surface	



X806MG

NEW REF:	OLD REF:
<b>X806MG</b>	(FM8254)
6G surface	
<b>X808MG</b>	(FM8255)
8G surface	

Dimensions:  
6-8G - 134mm x 134mm  
**Surface Mounting Box**  
6-8G - F8342  
(41mm deep with  
earth terminal)

To be used in conjunction  
with grid yoke, grid box and  
modules as identified on  
pages 139-145.



X809MG

NEW REF:	OLD REF:
<b>X809MG</b>	(FM8256)
9G surface	
<b>X812MG</b>	(FM8257)
12G surface	

Dimensions:  
9-12G - 134mm x 195mm  
**Surface Mounting Box**  
9-12G - F8343  
(41mm deep with  
earth terminal)  
To be used in conjunction  
with grid yoke, grid box and  
modules as identified on  
pages 139-145.



X818MG

NEW REF:	OLD REF:
<b>X818MG</b>	18G surface (FM8258)
<b>X824MG</b>	24G surface (FM8259)

Dimensions:  
18G - 195mm x 195mm  
24G - 195mm x 256mm  
**Surface Mounting Box**  
18G - F8344  
(56mm deep with earth terminal)  
24G - F8345  
(56mm deep with earth terminal)  
To be used in conjunction with grid yoke, grid box  
and modules as identified on pages 139-145.

## Coverplates

### Grid Plates (Stainless Steel)

SURFACE



NEW REF:		OLD REF:
<b>X801SS</b>	1G	(FM8270SS)
<b>X802SS</b>	2G	(FM8271SS)
<b>X803SS</b>	3G	(FM8272SS)
<b>X804SS</b>	4G	(FM8273SS)

#### Dimensions:

1-2G - 86mm x 86mm  
3-4G - 86mm x 146mm

#### Surface Mounting Box

1-2G - FM8340  
(41mm deep with earth terminal)  
3-4G - FM8341  
(41mm deep with earth terminal)

To be used in conjunction with grid yoke, grid box and modules as identified on pages 139-145.

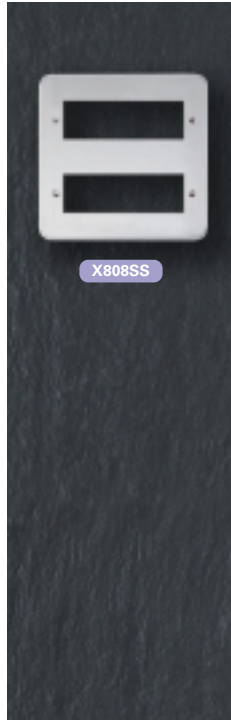

NEW REF:		OLD REF:
<b>X806SS</b>	6G	(F8274SS)
<b>X808SS</b>	8G	(F8275SS)

#### Dimensions:

6-8G - 134mm x 134mm

#### Surface Mounting Box

6-8G - F8342  
(41mm deep with earth terminal)

To be used in conjunction with grid yoke, grid box and modules as identified on pages 139-145.

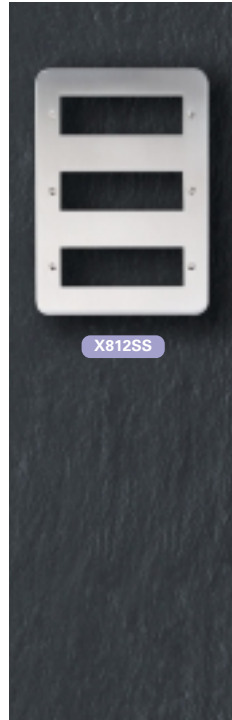

NEW REF:		OLD REF:
<b>X809SS</b>	9G	(F8276SS)
<b>X812SS</b>	12G	(F8277SS)

#### Dimensions:

9-12G - 134mm x 195mm

#### Surface Mounting Box

9-12G - F8343  
(41mm deep with earth terminal)

To be used in conjunction with grid yoke, grid box and modules as identified on pages 139-145.



NEW REF:		OLD REF:
<b>X818SS</b>	18G	(FM8278SS)
<b>X824SS</b>	24G	(FM8279SS)

#### Dimensions:

18G - 195mm x 195mm  
24G - 195mm x 256mm

#### Surface Mounting Box

18G - F8344  
(56mm deep with earth terminal)  
24G - F8345  
(56mm deep with earth terminal)

To be used in conjunction with grid yoke, grid box and modules as identified on pages 139-145.

## Accessories Technical Data

### Maximum Number of Conductors per Terminal Hole

Code	Product		1.0mm <sup>2</sup>	1.5mm <sup>2</sup>	2.5mm <sup>2</sup>	4.0mm <sup>2</sup>	6.0mm <sup>2</sup>	10.0mm <sup>2</sup>
<b>F1046/35/30 31/66/90/91 F1200</b>	Batten	L+N	5	3	2			
	lampholders	E	7	4				
<b>F1026</b>	Batten	L+N	5	3	1			
	lampholders							
<b>F1350</b>	6A	L+N	5	3	2			
	Ceiling switch	E	12	8				
<b>F1340</b>	50A	L+N				3	2	1
	Ceiling switch	2 x E		10	5	2		
<b>F8502 F8602</b>	LSC	Loop	5	4	2	2		
	Ceiling outlet	L+N	6	4	2	2		
		E	6	4	2	2		
	13A	L+N			4	3	2	
	Socket outlets	E		7	4	3	2	
	RCD	L+N			5	3	2	
	Socket outlets	E		7	3	2	1	
	15A	L+N			3	2	1	
	Socket outlets	E		6	3			
	5A	L+N	5	3	1			
	Socket outlets	E	6	3	1			
	3A	L+N	4	3	1			
	Socket outlets (export)	E	6	3	3			
	15A 127v	L+N			4	2	1	
	Socket outlets	E		7	3	1		
	10A		5	3	1			
	Switch range							
<b>M011A/21A/22A</b>	10A		5	3	1			
	Architrave switches							
	15A				1			
	Switch range							
	250W/400W		4	3	1			
	Dimmer switches		4	3	1			
	20A	L+N			2	2	1	
	Switch range	2 x E		7	3			
	13A	L+N			4	3	2	
	Connection units	E		7	3			
	50A	L+N				2	2	1
	Switches	2 x E		9	5	2		
	45A	L+N				3	2	1
	Cooker units	2 x E		10	5	2		
	Shaver	L+N	3	2	1			
	units	E	6	4				
<b>F2046</b>	Cooker	2 x (L+N)				3	3	2
	Outlet plate	2 x E		14	6	3		
<b>F8076/8080</b>	Grid switch module range		6	4	3	2	1	
	Dimmer/buzzer		4	2	1	1		
<b>F5091</b>	20A Junction box		5	4	2			
<b>F5096</b>	30A Junction box		6	5	3	2		

## Accessories Technical Data

### Maximum Number of Conductors per Terminal Hole

Code	Product	1.0mm <sup>2</sup>	1.5mm <sup>2</sup>	2.5mm <sup>2</sup>	4.0mm <sup>2</sup>	6.0mm <sup>2</sup>	10.0mm <sup>2</sup>
F2914	Panel mounted 13A socket			4	3	2	
FM2922	Panel mounted 20A switch			2	2	1	
F0700/7/9/12	Brass lampholders	4	3	1			
F0702/4	Brass lampholders	3	1	1			
F0720	Brass lampholders	4	3	1			
F0726	Brass lampholders	3	2	1			
F0732	Brass lampholders	2	1	1			
F2630/31/32/33/34	Splashproof 10A switches	6	4	2	1		
F4500/01/02/07/08/4511/4570/3819	Surface mounting boxes, moulded	7	4	2	1		
F4505/4506	Architrave mounting boxes	6	4	2	1		
F4530	Surface mounting box for shaver unit	8	5	3	1		
F4567	2 gang metal box	7	4	2	1		

#### Note:

Terminal hole capacities for earth conductors refer to the actual cross sectional area of individual earth conductors.

When using flat twin and earth insulated pvc sheathed cable in accordance with table 5 (a) of BS 6004: 1984 the size of earth conductor is as shown here.

#### Flat twin and earth insulated pvc sheathed cable to BS 6004: 1984 Table 5 (a)

C.S.A. of Live and Neutral conductors	C.S.A. of associated Earth conductor
1.0mm <sup>2</sup>	1.0mm <sup>2</sup>
1.5mm <sup>2</sup>	1.0mm <sup>2</sup>
2.5mm <sup>2</sup>	1.5mm <sup>2</sup>
4.0mm <sup>2</sup>	1.5mm <sup>2</sup>
6.0mm <sup>2</sup>	2.5mm <sup>2</sup>
10.0mm <sup>2</sup>	4.0mm <sup>2</sup>



## Accessories Technical Data

### Panel Mounting Accessories - Panel Cut-out Details

All dimensions are in millimetres. To comply with British Standards, the panel must extend at least 10mm beyond all sides of the aperture.

**F2915** 13A socket, DP switched, 2 gang - 23mm depth

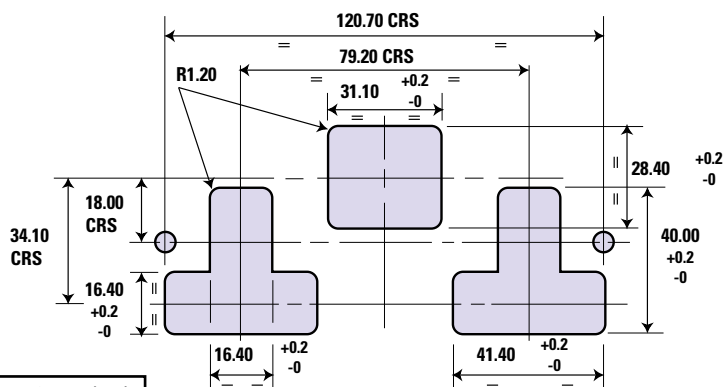

**F3006** 13A socket, 1 gang, round aperture - 24mm depth

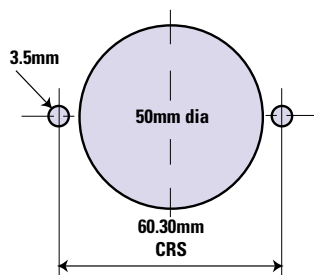

**F2950, F2951** Telephone line jack - 19mm depth

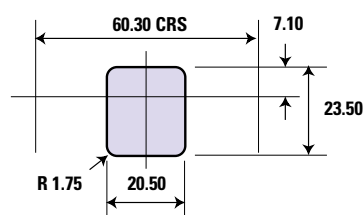

**F2916** 13A socket, 1 gang - 24mm depth

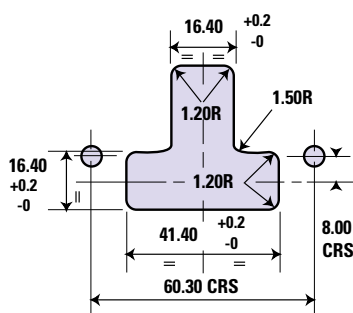

**F2914** 13A socket, DP switched, 1 gang - 24mm depth

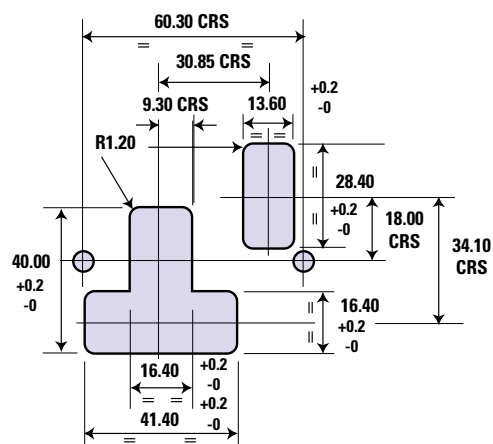

**F2935** 50A DP switch - 29mm depth

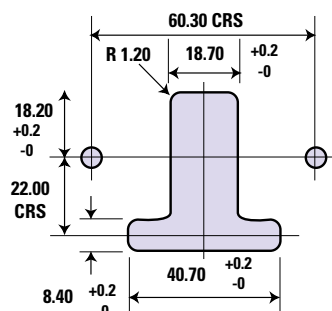

## 1G switched socket

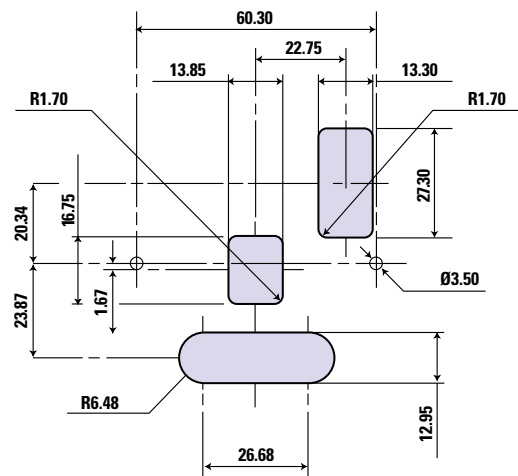

20A switch

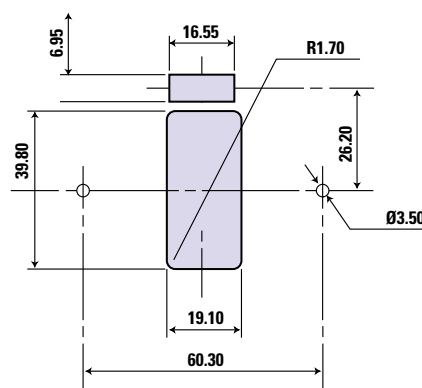

2G switched socket inboard rockers

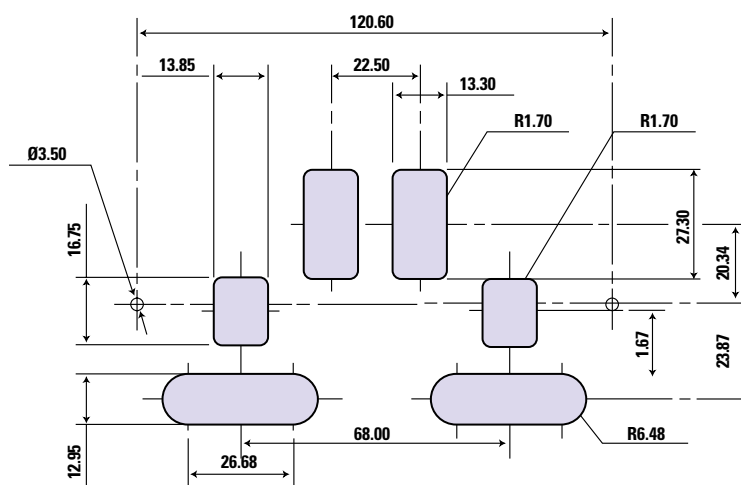

2G switched socket outboard rockers

