

E12378

CAP M22 SYMBOL STOP

Accessories

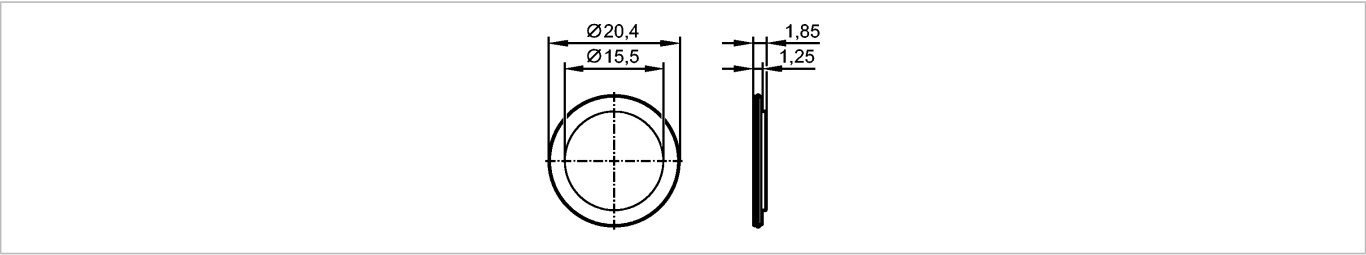

Made in Germany

Product characteristics	
Plastic diffuser	
Ø 20.4 mm	
Symbol Stop	
Application	
Application	For KT touch sensors (M22)
Mechanical data	
Housing materials	Polyamide (Grilamid TR 90UV)
Weight [kg]	0.003
Remarks	
Remarks	Snap-fit once only - cannot be removed
Pack quantity [piece]	2