

BLANKING PLUG

Ex d, Ex e, Ex t, IP65/66/67/68

for INDUSTRIAL and Ex de I/II/IIIC

MOFLASH
BIRMINGHAM, ENGLAND
SIGNALLING



Features and Benefits

- Precision manufactured from high quality brass (marine grade electroless nickel plated) or stainless steel.
- Used to blank off threaded entry holes.

Technical Data

Type:	Blanking Plug
Material:	Brass (Marine Grade Electroless Nickel Plated), Stainless Steel

Standards and Certifications

Equipment Protection Levels: Ex d I/IIc MbGb, Ex e I/IIc MbGb, Ex tb IIIC Db, IM2/II2GD

Ingress Protection - Parallel: IP66/67/68 (2m cont.)

Ingress Protection - Tapered: IP65 (NPT)

Certification:		Standard:
IEC Ex	IECEx ITA 13.0005X	IEC 60079-0, IEC 60079-1, IEC 60079-7, IEC 60079-31
ATEX	CML15ATEX1040X	EN 60079-0, EN 60079-1, EN 60079-7, EN 60079-31
INMETRO	TÜV 15.0485X	ABNT NBR IEC 60079 Parts 0, 1, 7
Chinese	CNEx 09.0916U	ABNT NBR IEC 60079 Parts 31 GB 3836.1, GB 3836.2, GB 3836.3, GB 12476.1
SANS/SABS/IEC	MASC MS/13-594X	IEC 60079-0, IEC60079-1, IEC 60079-7, IEC 60079-31, IEC 60529
Marine	14-SG1216922-PDA	

Manufactured by CCG Cable Terminations (Pty) Ltd

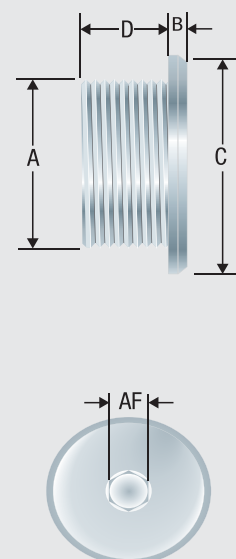

PATENTED

Conditions for Safe Use - X

- An IP rating of IP66/67/68 is maintained for units with parallel threads when used with the supplied washer and for units with tapered thread when thread sealant is conducted as indicated in IEC60079-14. Alternatively an IP65 rating is applicable.
- A service temperature range of -20°C to 95°C is applicable if the washers are utilized to maintain an IP rating IP65/66/67/68 2m cont.
- A blanking element may not be installed on a plug.
- When the equipment with metric male thread and with the sealing washer fitted is intended for use / interface in threaded holes in a flameproof enclosure the applicable thread engagement must be achieved after the washer has been fitted. Thread engagement shall be at least five full threads.

Plugs

	MOFLASH Product Code	Dimension 'A'	Dimension Min 'B'	Dimension Min 'C'	Dimension Min 'D'	Dimension Min 'A/F'
Brass	50204	M20	3	25	15	10
Stainless Steel	50214	M20	3	25	15	10