

Product datasheet

Specifications



PLASTRON CUVETTE PLEIN 11 MOD.

LVS07946

EAN Code: 3606481884961

Main

Range	PrismaSeT
Range of product	PrismaSeT G PrismaSeT P
Product or component type	Bloc with insert
Accessory / separate part category	Locking accessory
Range compatibility	PrismaSeT PrismaSeT G door PrismaSeT PrismaSeT P PrismaSeT

Complementary

Function available	Quick and easy replacement
Mounting support	Handle
installation description	Cubicle Floor-standing enclosure Wall-mounted enclosure Pack enclosure
Lock type	Screwdriver slot insert
Quantity per set	Set of 1
Net weight	0.02 kg
Colour	Natural

Packing Units

Unit Type of Package 1	PCE
Number of Units in Package 1	1
Package 1 Height	2.0 cm
Package 1 Width	2.0 cm
Package 1 Length	3.7 cm
Package 1 Weight	34.0 g
Unit Type of Package 2	S02
Number of Units in Package 2	200
Package 2 Height	15.0 cm
Package 2 Width	30.0 cm
Package 2 Length	40.0 cm
Package 2 Weight	7.226 kg

Contractual warranty

Warranty (in months)

18



Environmental Data

Schneider Electric aims to achieve Net Zero status by 2050 through supply chain partnerships, lower impact materials, and circularity via our ongoing “Use Better, Use Longer, Use Again” campaign to extend product lifetimes and recyclability.

[Environmental Data explained >](#)

[How we assess product sustainability >](#)



Environmental footprint

[Environmental Disclosure](#)

[Product Environmental Profile](#)

Use Better



Materials and Substances

Packaging made with recycled cardboard

Yes

Packaging without single use plastic

No

[EU RoHS Directive](#)

Compliant

REACH Regulation

[REACH Declaration](#)

Halogen-free status

Halogen free plastic parts product

PVC free

Yes

Silicone-free

Yes

Use Longer



Lifetime extension

Repair

No

Use Again



Repack and remanufacture

End of life manual availability

No need of specific recycling operations

Take-back

No

Technical Illustration

Dimensions

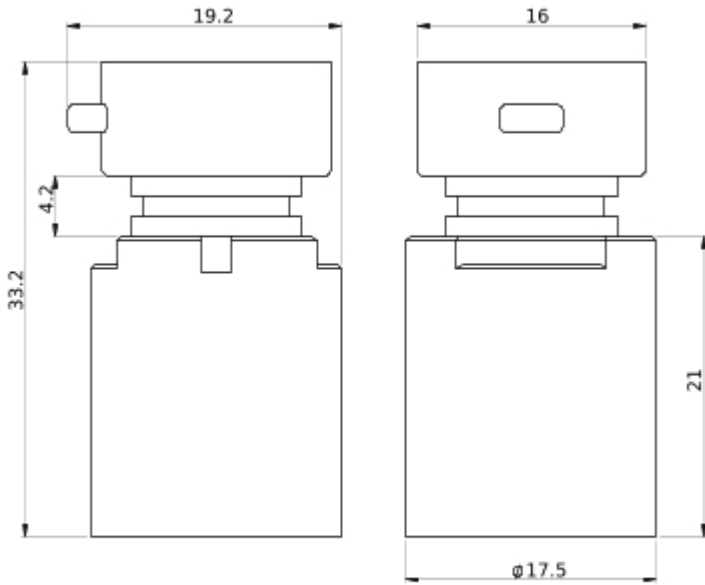

- All dimensions are approximate and are in
- Also see technical documentation.