

7206 BECBP

Popular item
SKF Explorer

Dimensions

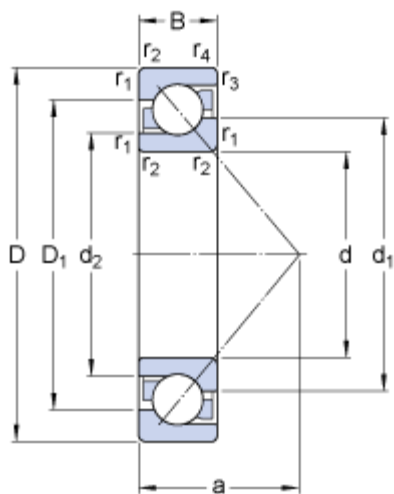

d	30	mm
D	62	mm
B	16	mm
d ₁	≈ 42.65	mm
d ₂	≈ 36.13	mm
D ₁	≈ 50.1	mm
a	27.3	mm
r _{1,2}	min. 1	mm
r _{3,4}	min. 0.6	mm

Abutment dimensions

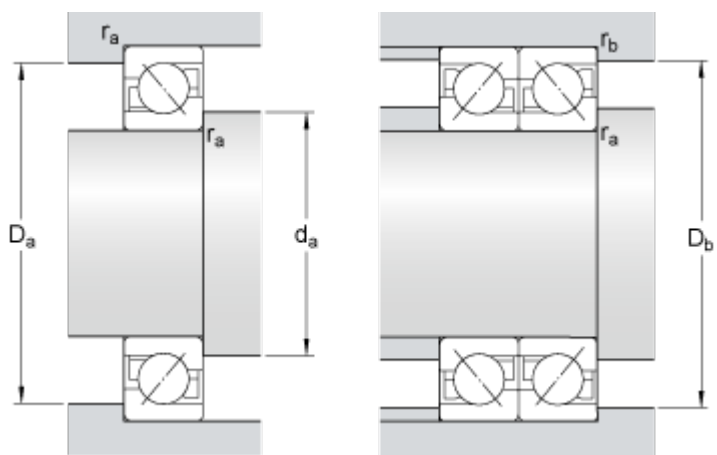

d _a	min. 35.6	mm
D _a	max. 56.4	mm
D _b	max. 57.8	mm
r _a	max. 1	mm
r _b	max. 0.6	mm

Calculation data

Basic dynamic load rating	C	24	kN
Basic static load rating	C ₀	15.6	kN
Fatigue load limit	P _u	0.655	kN
Reference speed		13000	r/min
Limiting speed		14000	r/min
Calculation factor	A	0.00377	
Calculation factor	k _r	0.095	
Calculation factor	e	1.14	

Single bearing or bearing pair arranged in tandem

Calculation factor	X	0.35	
--------------------	---	------	--

Calculation factor	Y_0	0.26
--------------------	-------	------

Calculation factor	Y_2	0.57
--------------------	-------	------

Bearing pair arranged back-to-back or face-to-face

Calculation factor	X	0.57
--------------------	---	------

Calculation factor	Y_0	0.52
--------------------	-------	------

Calculation factor	Y_1	0.55
--------------------	-------	------

Calculation factor	Y_2	0.93
--------------------	-------	------

Mass

Mass bearing		0.2	kg
--------------	--	-----	----
