

VideoFlex G3 DuoView

9 mm camera head 1,5 m cable



1,5 m
DOF 1 - 5cm

Camera unit for VideoFlex with additional side camera & lighting

Rev0316

TECHNICAL DATA

VIDEOFLEX G3

SCREEN TYPE 3.5" TFT colour display
CAMERA RESOLUTION 640 x 480 pixel
RESOLUTION PICTURE / VIDEO 720 x 480 pixel
FORMAT PICTURE / FORMAT VIDEO JPEG / AVI
ZOOM 1.5 x digital zoom in 10% steps
MEMORY Supports up to max. 8 GB SDHC card
PORT Mini USB
CONNECTIONS Micro-SD, Analog-video
POWER SUPPLY Li-Ion pack battery 3.7V / 1.7Ah / 5V / 1A power supply unit
CHARGING TIME approx. 4 h
OPERATING TIME approx. 4 h
OPERATING TEMPERATURE 0 °C ... 45 °C
STORAGE TEMPERATURE -10 °C ... 60 °C

DUOVIEW CAMERA

CAMERA TYPE CMOS image sensor
CAMERA HEAD ø 9 mm
CAMERA HEAD PROTECTION CLASS water-resistant, IP 67
CAMERA HEAD LEDS Front: 4 / Side: 2
CAMERA RESOLUTION 640 x 480 pixels
FIELD OF VIEW (FOV) 57°
CAMERA FOCUS Front: F3 cm - F5 cm / Side: F1 cm - F5 cm
CABLE DIAMETER 6 mm
LENGTH OF FLEX CABLE 1 m
MINIMUM BENDING RADIUS 50 mm
OPERATING CONDITIONS 0°C ... 60°C, max. humidity 20 ... 90% rH, no condensation, max. working altitude 4000 m above sea level
STORAGE CONDITIONS -20°C ... 80°C, max. humidity 80% rH

DIMENSIONS (W x H x D) 1580 mm x 18 mm x 18 mm
WEIGHT 298g

- The camera head at a DuoView Camera transfers pictures directly to a LCD-Monitor.
- **Problem locating:** the camera indicates what is behind or in objects, walls circuits or cables etc. even under worst light conditions, due to the LED-lighting.
- **REC-Function:** still picture & video can be recorded for a later analysis.
- **Waterproof camera head and cable**
- **Ideal for difficult accessibility areas** due to the very small measuring head (ø 9 mm)
- **Camera unit can be replaced** to suit application
- Powerful object lighting thanks to **4 high-performance LEDs**
- **Extraneous light reduction:** contrasty LC-Display which provides an optimum display even under light irradiation.
- External monitors operated via **TV Out connection**
- **Formattable SDHC-Card**
- **Rotation:** The manual image rotation function enables the image to be rotated by 180° on the monitor.
- **Mirror function** for correcting mirror-inverted images.

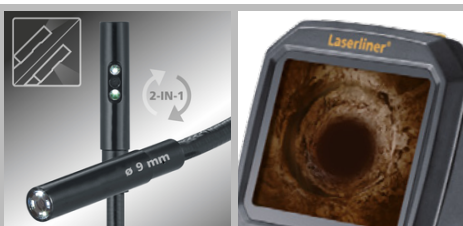
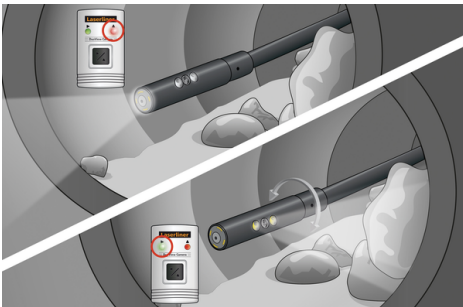

Camera head (ø 9 mm) with LED-Lighting 3.5" TFT colour display



VideoFlex G3 DuoView

- + DuoView Camera 1,5 m
- + Li-ion battery pack
- + Power supply unit/charger with internal adapter
- + software
- + USB/REC cable
- + 4 GB micro-SD card
- + Video cable

1,5 m
DOF 1 - 5cm

ARTICLE	ARTICLE NO.	EAN CODE	PU
VideoFlex G3 DuoView	092.915A	4 021563 694983	2

CAMERA

640 x 480 pixel
LED LIGHT
IP 68

DISPLAY

320 x 240 pixel
3.5" LCD
180°
ZOOM 1,5x

REC

SD

USB

Li-Ion Battery

RECHARGE

HARD