



# A4

**TYPICAL APPLICATIONS** Vacuum cleaners, H VAC

- FUNCTIONS**
- SPST, momentary or not
  - DPST, illuminated or not
  - DPCO
  - DPDT, momentary or not

**CYCLE No.** 50.000

**CUT OUT** 19x22 mm

**AMBIENT TEMPERATURE** 125 °C

**GWT** 850 °C

**GWT NO FLAME (<2sec)** 750 °C on demand



A

4

## DRAWING

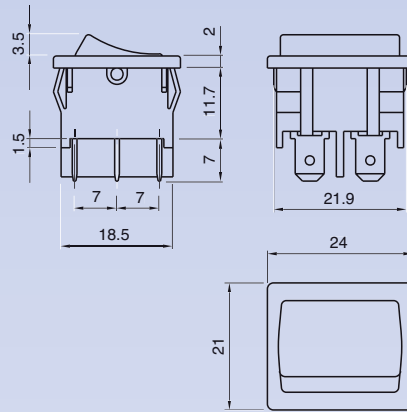

?

## TERMINAL

1

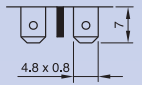

2

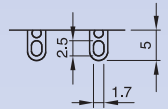

WATERPROOF CAP

## Function 9

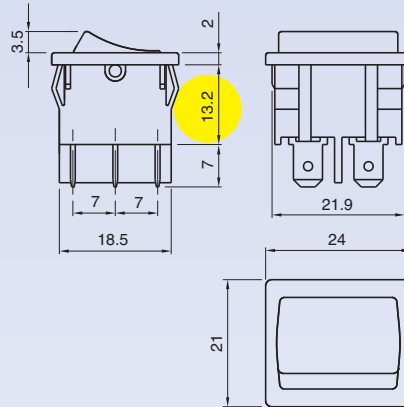

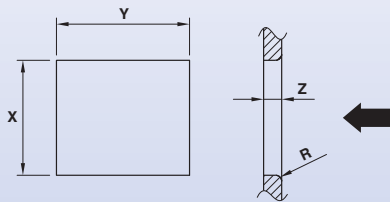

Z	Y	X
0,7 ... 1,25	22,0 ±0,1	19,0 ±0,2
1,25 ... 2,0	22,0 ±0,1	19,3 ±0,2
2,0 ... 3,0	22,0 ±0,1	19,6 ±0,2

TERMINAL	FUNCTION	RATING	BODY COLOUR	ROCKER COLOUR	MARKING COLOUR	MARKING
A	4					0 0 0

?	?	?	?	?	?	0	0	0
---	---	---	---	---	---	---	---	---

### FUNCTION

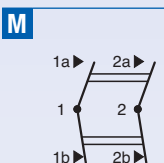
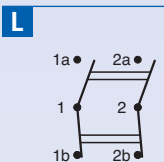
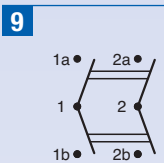
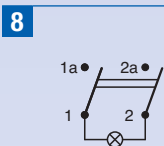
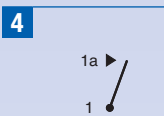
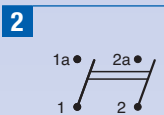
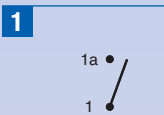

### RATING

**2**  
**Function 4 - M**  
 6 (2) A / 250 VAC  
 3 (1) A / 250 VAC - 5E4  
 T125/55 °C - T125 °C  
 EN 61058

6 A - 125 / 250 VAC  
 1/6 HP - 250 VAC  
 1/10 HP - 125 VAC  
 T105 °C  
 UL 1054  
 CSA C22.2

**3**  
**Function 1 - 2 - L - 8**  
 10 (4) A / 250 VAC  
 6 (4) A / 250 VAC - 5E4  
 T125/55 °C - T125 °C  
 EN 61058

10 A - 125 / 250 VAC  
 1/3 HP - 125 VAC  
 1/2 HP - 250 VAC  
 T105 °C  
 UL 1054  
 CSA C22.2

**6**  
**Function 9**  
 10 (2) A / 250 VAC  
 6 (1) A / 250 VAC - 5E4  
 T125/55 °C - T125 °C  
 μ disconnection  
 EN 61058

6 A - 125 / 250 VAC  
 1/8 HP - 125 VAC  
 1/6 HP - 250 VAC  
 T105 °C  
 UL 1054  
 CSA C22.2

**B**  
**Function 2**  
 13 (4) A / 250 VAC  
 8 (8) A / 250 VAC - 5E4  
 T125/55 °C - T125 °C  
 EN 61058

15 A / 125 VAC  
 10 A / 250 VAC  
 1/3 HP - 125 VAC  
 1/2 HP - 250 VAC  
 T105 °C  
 UL 1054  
 CSA C22.2

**Function 9**  
 13 (4) A / 250 VAC  
 6 (4) A / 250 VAC - 5E4  
 T125/55 °C - T125 °C  
 μ disconnection  
 EN 61058

15 A / 125 VAC  
 10 A / 250 VAC  
 1/3 HP - 125 VAC  
 1/2 HP - 250 VAC  
 T105 °C  
 UL 1054  
 CSA C22.2

### BODY COLOUR

**1** black

**2** white

**X** custom

### ROCKER COLOUR

**1** black

**2** white

ILLUMINATED ✨

**G** red

**H** orange

**E** green

**L** white

**X** custom

### MARKING COLOUR

**0** none

**1** black

**2** white

**5** grey

**7** light blue

**8** red

**9** orange

**X** custom

### MARKING

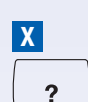
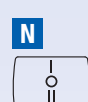
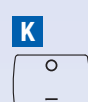
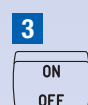
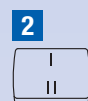
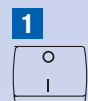



# A4

<b>TYPICAL APPLICATIONS</b>	Vacuum cleaners, H VAC
<b>FUNCTIONS</b>	<ul style="list-style-type: none"> <li>■ DPST, illuminated or not</li> <li>■ DPDT</li> </ul>
<b>CYCLE No.</b>	50.000
<b>CUT OUT</b>	19x22 mm
<b>AMBIENT TEMPERATURE</b>	125 °C
<b>GWT</b>	850 °C
<b>GWT NO FLAME (&lt;2sec)</b>	750 °C on demand



**A** **4**

**DRAWING**

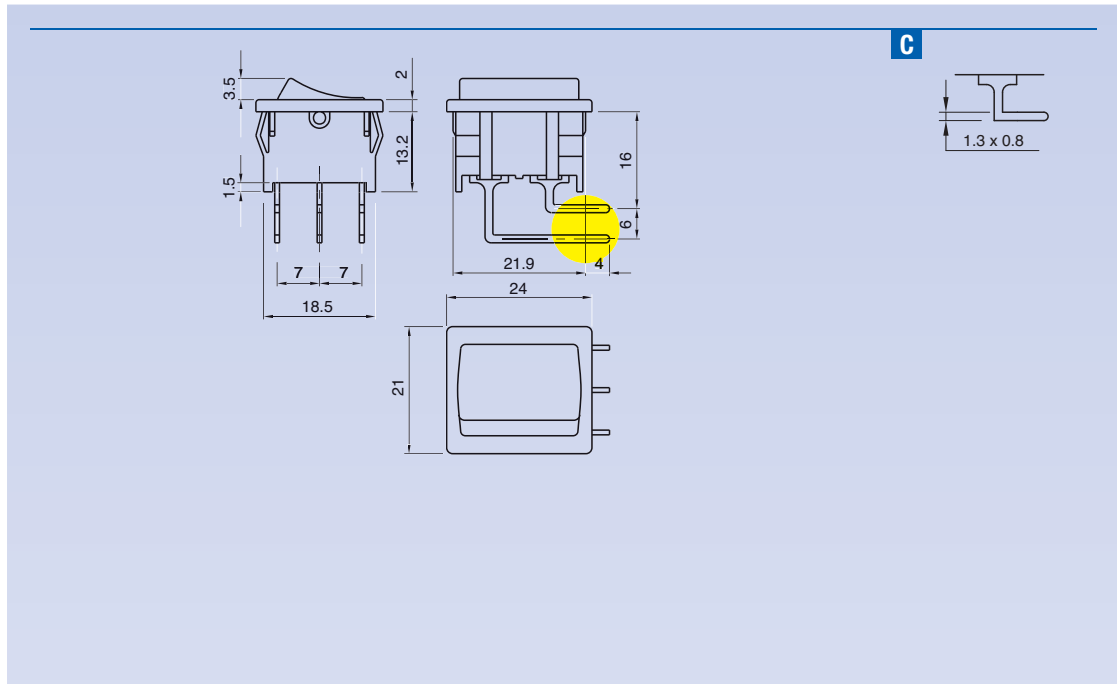

**?**

**TERMINAL**

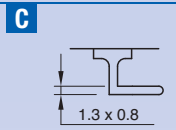

WATERPROOF CAP

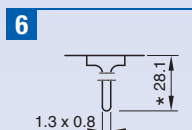
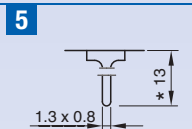
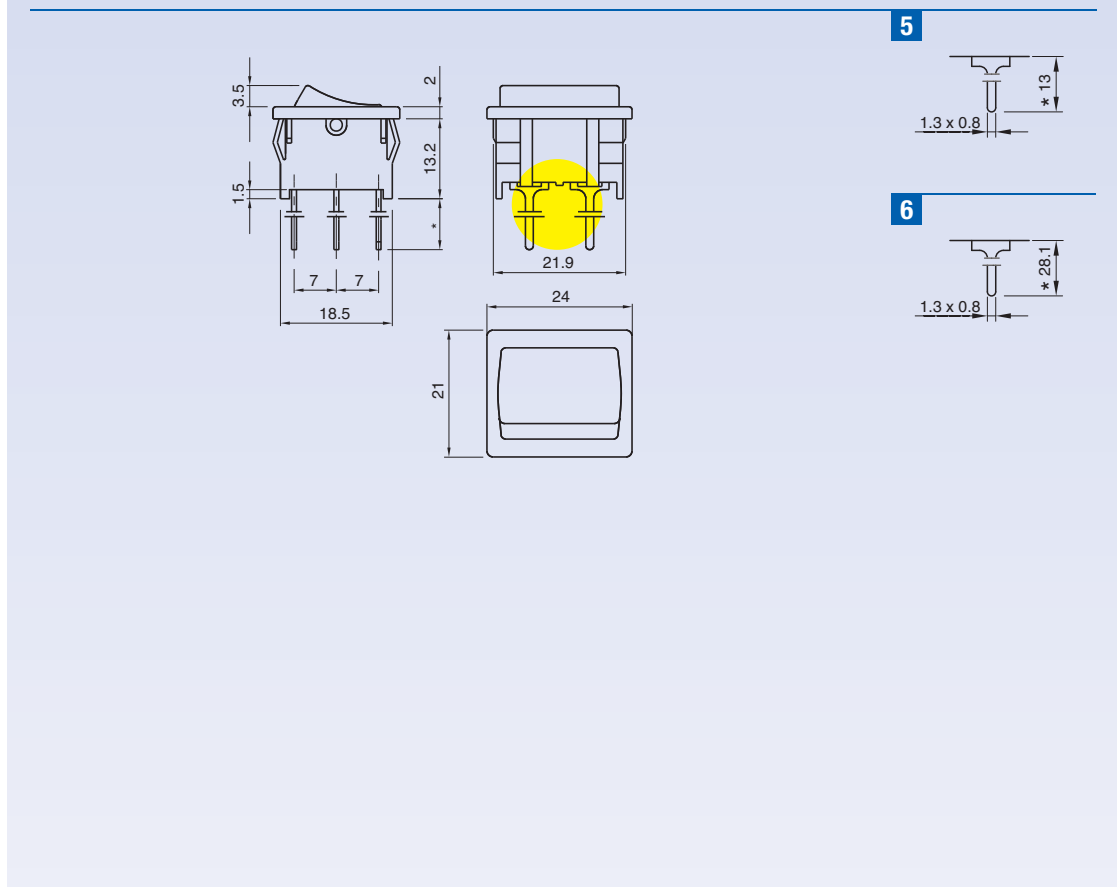

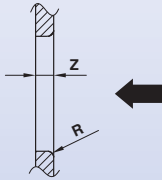
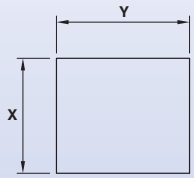

Z	Y	X
0,7 ... 1,25	22,0 ±0,1	19,0 ±0,2
1,25 ... 2,0	22,0 ±0,1	19,3 ±0,2
2,0 ... 3,0	22,0 ±0,1	19,6 ±0,2

TERMINAL	FUNCTION	RATING	BODY COLOUR	ROCKER COLOUR	MARKING COLOUR	MARKING
A	4					0 0 0

?	?	?	?	?	?	?	0	0	0
---	---	---	---	---	---	---	---	---	---

### FUNCTION

#### 2 Terminal C - 6

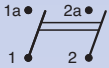

#### 8 Terminal C

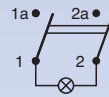

#### L Terminal 5

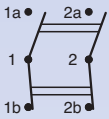

### RATING

#### 3

10 (4) A / 250 VAC  
6 (4) A / 250 VAC - 5E4  
T125/55 °C - T125 °C  
EN 61058

10 A - 125 / 250 VAC  
1/3 HP - 125 VAC  
1/2 HP - 250 VAC  
T105 °C  
UL 1054  
CSA C22.2

### BODY COLOUR

#### 1

black

#### 2

white

#### X

custom

### ROCKER COLOUR

#### 1

black

#### 2

white

ILLUMINATED ✨

#### G

red

#### H

orange

#### E

green

#### L

white

#### X

custom

### MARKING COLOUR

#### 0

none

#### 1

black

#### 2

white

#### 5

grey

#### 7

light blue

#### 8

red

#### 9

orange

#### X

custom

### MARKING

#### 0



#### 1



#### 2



#### 3



#### 5



#### C



#### K



#### Z



#### X

