

1. Push the cable gland and housing over the cable sheath.

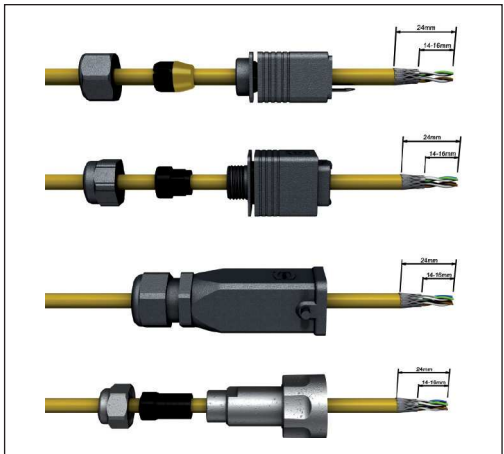

2. Strip the cable jacket in the length of 24-26 mm and push the cable shielding 14-16 mm back or cut it off if necessary.

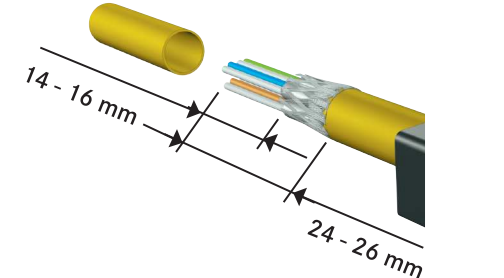

3. To ensure an easy RJ Industrial 10G assembly, please check the wire stripping length with the help of the scale shown below.

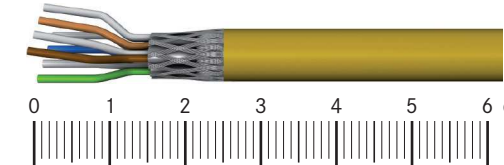

4. Before using the wire manager, untwist the pairs and move the wires into the correct position according to the selected terminal assignment.

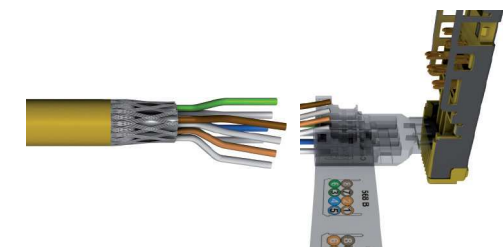

5. Insert single wires into the wire manager according to the selected terminal assignment. Assemble the lower wires first, followed by the upper wires. Cut the 4 upper wires with small cutting pliers close to the flange of the wire manager.

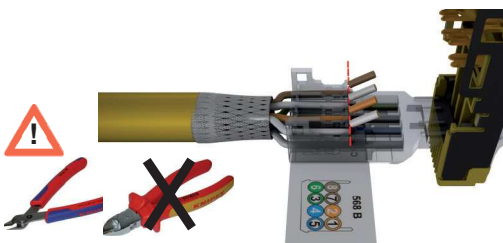
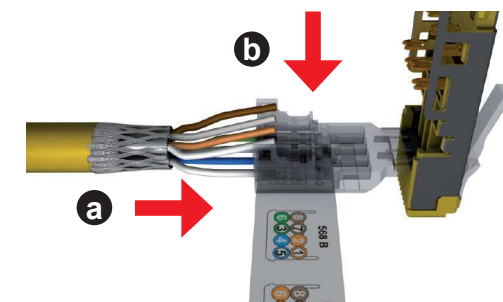

6. Lock the wire manager to the RJ45 connector body with an audible “click”.

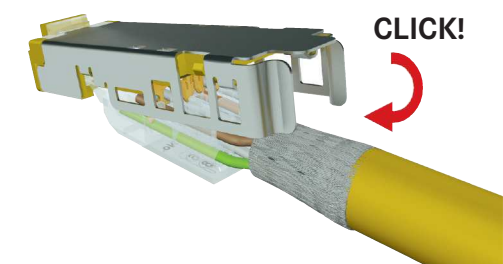

7. Lock the shield to the RJ45 plug with an audible “click”.

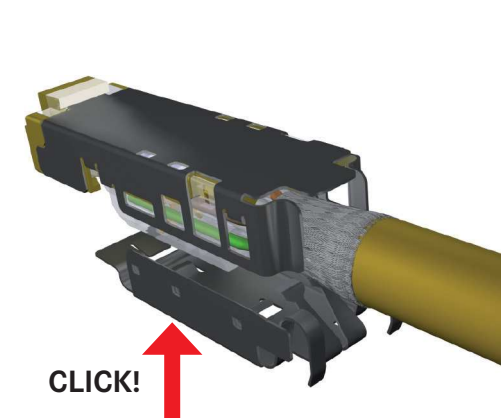

8. Push the housing over the installed data module. Use the RJ45 adapter if necessary. Fix the adapter with the screw or snap it onto the insert with an audible “click”. Please use alignment symbols, if applicable, to push the hood over the insert until it snaps into place. Tighten the cable screw.

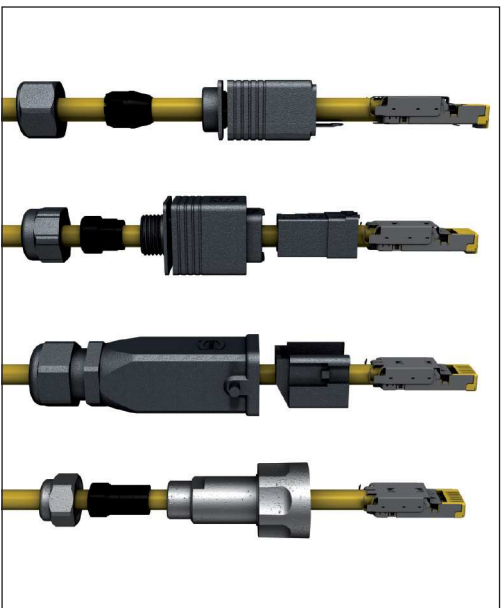

Pin assignment data

Pin Nr.	Function/Signal	Wire colour		
		TIA/EIA 568 A	TIA/EIA 568 B	Industrial ¹⁾
1	T3	green / white	orange / white	yellow
2	R3	green	orange	orange
3	T2	orange / white	green / white	white
4	R1	blue	blue	–
5	T1	blue/white	blue/white	–
6	R2	orange	green	blue
7	T4	brown/white	brown/white	–
8	R4	brown	brown	–

1) For Ethernet profiles like PROFINET, SERCOS III, Varan u. a.

Technical data

Cat. 6 / Performance class E_A
suitable for 1 / 10 Gigabit Ethernet

Termination: IDC, tool-less field-assembly

Protection level: IP 65 / IP 67

Mating face: RJ45 acc. IEC 60603-7

Wire gauge data: AWG 27-22 stranded/solid max. 1,5 mm

Wire insulation: -40 °C ... +70 °C

Temperature range: min. 750

Mating cycles: Thermoplastic, black Zinc, die-cast

Housing material:

Cable diameter:

- HARTING PushPull V4 (plastic and metal): 4.9 - 8.6 mm
- Han® PushPull V14 (plastic): 6.5 - 9.5 mm
- Han® PushPull V14 (metal): 4 - 11 mm
- Han® 3 A (plastic and metal): 5 - 9 mm
- Han-Max® (metal): 4 - 8 mm

Part No. 09 45 100 1560 / 99 00
Version 1.0 - 2010-04
Errors and technical changes excepted.

HAN3A - Copper- RJ45 – Connector Kit

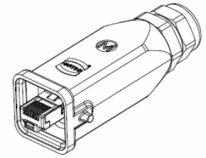

This is a connector kit only available from HARTING. The kit contains the HAN3A backshell, shielded industrial RJ45 connector (10G RJ 45 plug) plus screening cable gland.

For ordering additional kits the customer should contact and order from HARTING, www.HARTING.com.

Ordering: HARTING part number 6645-528-1001-00.

Typical Shielded Cable specification: Ø6.5- Ø9.5mm.

RJ45 Assembly Instructions:

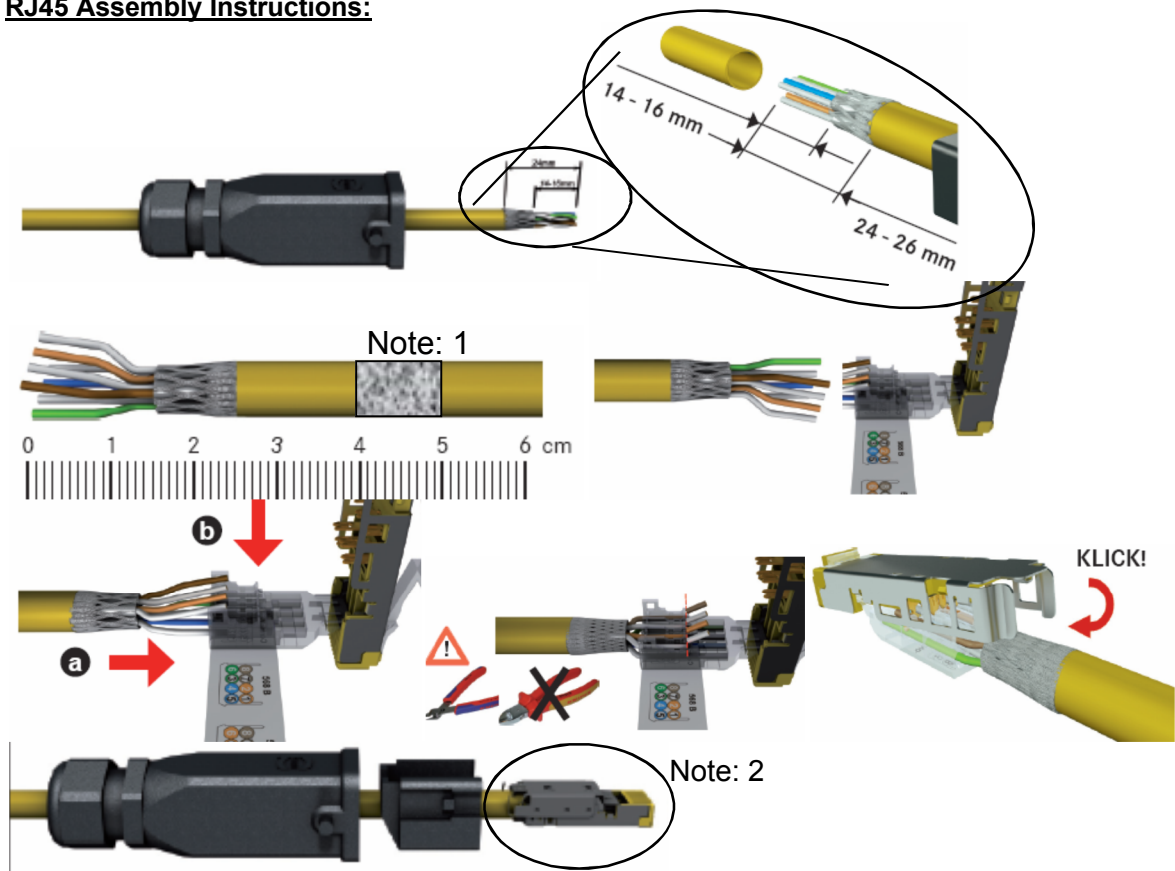

Note#1: To create the shield to the backshell, the cable outer sheath shall be stripped local to the cable gland.

Note#2: Spare RJ45 Industrial 10G, available from HARTING, PN: 09-45-151-1560