

**FAG****6206-2RSR**

Deep groove ball bearing

Deep groove ball bearing 62...-2RSR, single row, seals, steel sheet metal cage

## Technical information

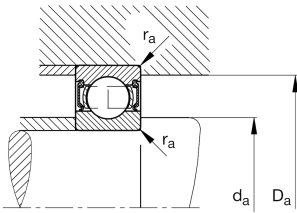
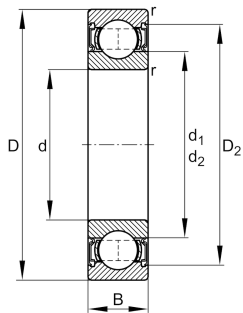

## Your current product variant

Sealing	2RSR	Contact seal on both sides
Cage	JN	Steel sheet metal
Tolerance class	PN	Normal (PN)
Dimensional / heat stabilization	SN	Rings dimensional stabilized up to 120°
Lubricant	GA14	Ball bearing grease, low noise, standard for D<=62mm
Radial internal clearance	CN (Group N)	Normal internal clearance
Bore type	Z	Cylindrical

## Main Dimensions &amp; Performance Data

d	30 mm	Bore diameter
D	62 mm	Outside diameter
B	16 mm	Width
C <sub>r</sub>	20,700 N	Basic dynamic load rating, radial
C <sub>0r</sub>	11,300 N	Basic static load rating, radial
C <sub>ur</sub>	700 N	Fatigue load limit, radial
n <sub>G</sub>	6,700 1/min	Limiting speed
≈m	0.193 kg	Weight

## Mounting dimensions

d <sub>a min</sub>	35.6 mm	Minimum diameter shaft shoulder
D <sub>a max</sub>	56.4 mm	Maximum diameter of housing shoulder
r <sub>a max</sub>	1 mm	Maximum fillet radius



Dimensions

$r_{min}$	1 mm	Minimum chamfer dimension
$D_1$	52.07 mm	Shoulder diameter outer ring
$D_2$	54.92 mm	Caliber diameter outer ring
$d_1$	40 mm	Shoulder diameter inner ring





Temperature range

$T_{min}$	-20 °C	Operating temperature min.
$T_{max}$	100 °C	Operating temperature max.

Calculation factors

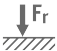
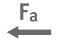
$f_0$	13.8	Calculation factor
-------	------	--------------------

Characteristics

-  Radial load
-  Axial load in one direction
-  Axial load in two directions
-  Lifetime lubrication, freedom from maintenance
-  Grease Lubrication
-  Sealed on both sides