

納 入 仕 様 書

アールエスコホーネツリミテツト`御中

品名:スイッチング AC アダプター

型番: TW-12020U

御 承 認 欄

平成 年 月 日

アイコー電子株式会社

〒101-0021 東京都千代田区外神田 3 - 5 - 2

TEL.03-3251-1335 FAX.03-3251-1327

<http://www.aikoh-d.co.jp>



24W
Switching Power Adapter
SPECIFICATION

Model No. : STD-12020U (USA / Level V)

Description : 12Volts / 2Amps

Part No. : RXTD12020U418204

Version : A2

Date : 25-Apr.-2011

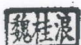
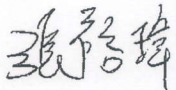
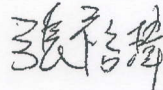
Approved	Checked	Prepared
 25/4/11		



Adapter Technology Co., Ltd.

Approval Documents/Spec. Revised Records

- Customer : AIKOH ELECTORNICS
- Model No. : STD-12020U
- Original Documents Content : Spec. 11 Pages, Attachment 2 Pages

Revised Records : No.	Date (mm/dd/yyyy)	Description (Before / After)	Page(s) Revised	Revised By (Adapter/Customer)	Remark
1	25/Nov./2008	-	-	Wei	3.0
2	02/Aug./2010	LABEL Update	P-7	Wei	A1
3	04/25/2011	LABEL Update	P-7	Wei	A2
4					
5					
6					
7					
8					
9					
10					
11					
12					
13					
14					
15					
16					
17					
18					



Adapter Technology Co., Ltd.

1. Feature :

- ◆ Input : Universal 100 ~ 240 Vac / 47 ~ 63 Hz Input, without any slide switch.
- ◆ Output : +12V / 0~2 A
- ◆ Case Dimension : 72 (L) * 34 (W) * 69 (H) mm ((±0.5mm))
- ◆ Efficiency : Eff (av) ≥ 82.22 % Min.
- ◆ Safety : UL / CUL / PSE / BSMI
- ◆ EMI : FCC Class B ; Conduction & Radiation Met.
- ◆ Protection : OVP (Over Voltage Protection) 、 SCP (Short Circuit Protection) 、 OCP (Over Current Protection)
- ◆ High frequency design , less power consumption.
- ◆ Suitable for usage at Telecommunication, Computer, Industrial Controller, & OA System.
- ◆ Meet Energy Star V / Erp (Stage 2) / MEPS V .

2. Input :

2.1 Voltage	Universal 100~240Vac, single phase
2.2 Frequency	47 ~ 63 Hz
2.3 Current	0.58A Max.
2.4 Inrush Current	30A Max. / 100Vac ; 45A Max. / 230Vac (Cold Start At 25 °C , Full Load)
2.5 Efficiency	Eff (av) ≥ 82.22% Min. (At 115 Vac & 230 Vac)
2.6 Power Consumption	Pi ≤ 0.3 W (At 230Vac & No Load)

$$\text{※Eff (av)} = \frac{E_1 + E_2 + E_3 + E_4}{4}$$

E1=efficiency with 25% rated load ; E2= efficiency with 50% rated load
E3=efficiency with 75% rated load ; E4= efficiency with 100% rated load

3. Output :

3.1 DC Output	Voltage	+12V ± 5%
	Current	2.0A Max.
	Regulation	11.4Vmin. ~ 12.0Vtyp. ~ 12.6Vmax.
	Ripple & Noise	100 mV Max.
	Total Power	24W Max.

Remark : For ripple & noise measurement, use a 20MHz bandwidth frequency oscilloscope, and add a 0.1μF multilayer Cap. and a Low ESR Electrolytic Cap. (10 μF) at output connector terminals. (At nominal line voltage, Full Load)



4. Protection :

4.1 Over Voltage Protection (OVP)	15V (Max.)
4.2 Short Circuit Protection (SCP)	Automatic recovery after short-circuit fault being removed
4.3 Over Current Protection(OCP)	4A (MAX)

Remark : When Short Circuit Protection is activated, the power supply will shutdown automatically.

Once the abnormal condition resulting in the failure being removed, the power supply will restart accordingly. When

Over Voltage Protection is activated, the power supply will shutdown.

5. Safety 、 EMI and EMC Requirement :

5.1 Safety Requirement

- a. Safety : UL / CUL / PSE / BSMI
- b. Dielectric Strength : 10mA Max. Cut off current

(1)	Primary to Secondary	3000Vac for 1 Minute
-----	----------------------	----------------------

c. Insulation Resistance :

(1)	Primary to Secondary	10 M Ohm for 500Vdc
-----	----------------------	---------------------

5.2 EMI Requirement : FCC Class B ; Conduction & Radiation Met.

5.3 Leakage Current : Less than 0.25mA

6. Operation and Environment Performance :

6.1 Temperature Range

Operating	+ 0°C ~ + 40°C
Storage	- 20 °C ~ + 80 °C

6.2 Humidity Range(Non-condensing)

Operating	20% ~ 80% RH
Storage	10% ~ 90% RH

6.3 Cooling : By natural air

7. M.T.B.F. : 50,000 Hrs. (At 25°C , By MIL-HDBK-217F)



8. Mechanical :

- 8.1 Weight : 165 g Typical
- 8.2 Cable Type : Black UL2468 AWG20
(Wire + Plug)
Plug : $\phi 5.5 * \phi 2.1 * 9.5\text{mm}$ (Tuning Fork & Cannelure)
- 8.3 Cable Length : 1800mm
- 8.4 Case Dimension : 72mm(L)*34mm(W)*69mm(H) ($\pm 0.5\text{mm}$)
- 8.5 Material Flammability : UL 94V-0
- 8.6 External Apperance : As drawing below (Scale - mm)

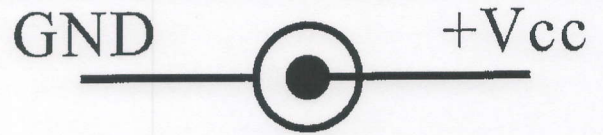

Output Cable Plug Pin Assignment

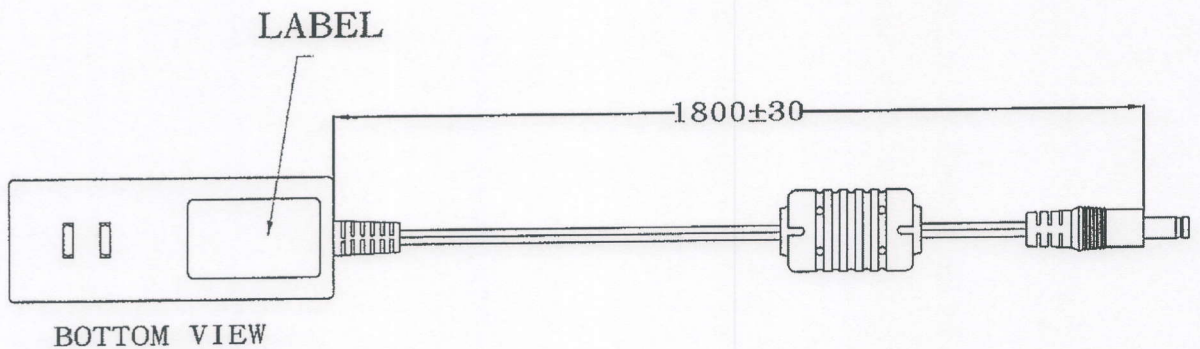
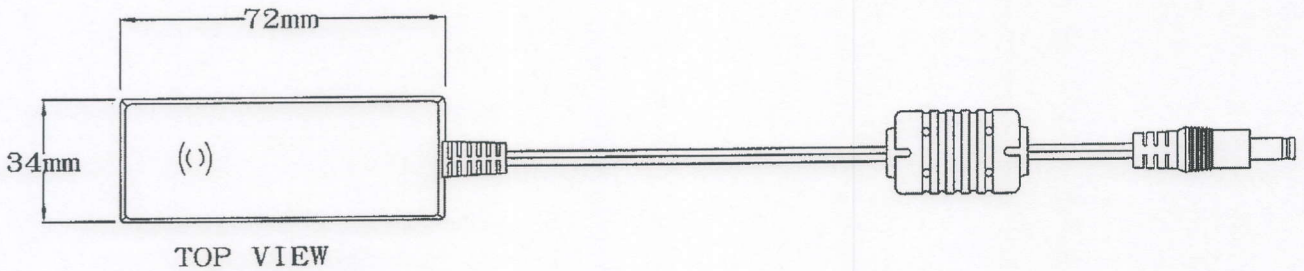
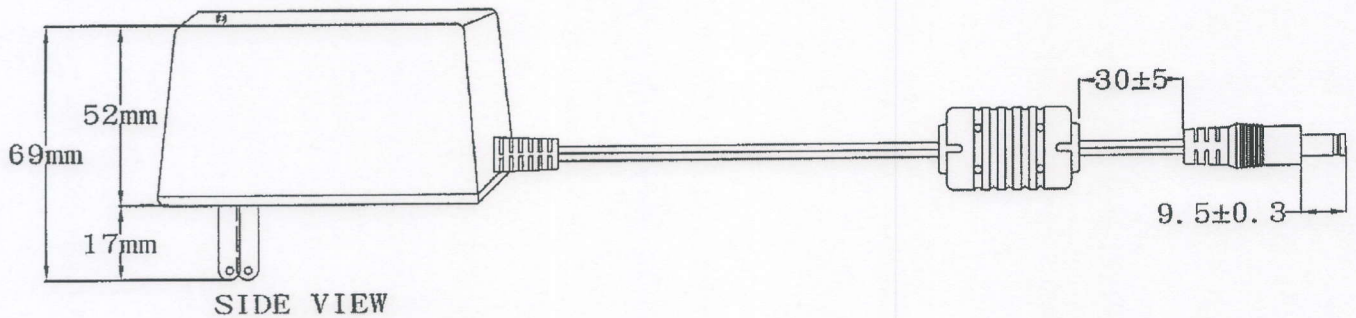



Adapter Technology Co., Ltd.

8.7 Spec. Label Materials : Metalized Polyester Label (Silver Gloss)
 Color : Silver Background with Black Printing
 Label Dimension : 34.5mm(L)*24.5mm(W)+/-0.1mm
 Label Thickness : #75

100%



300%

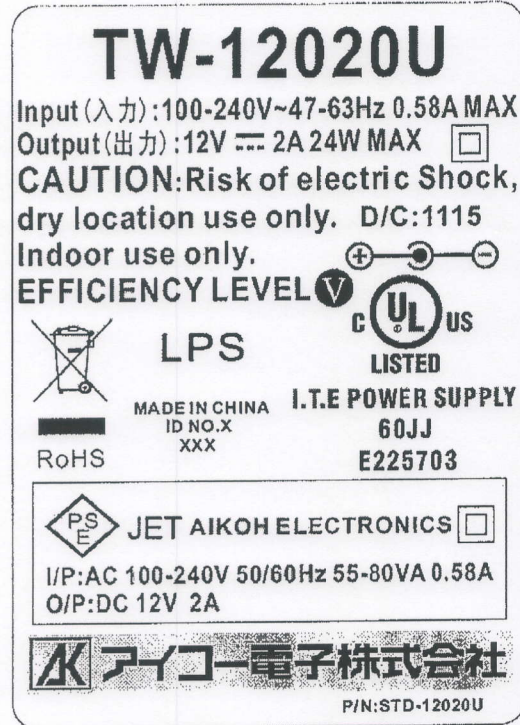

"XXX"

Label supplier's code.
 It is accurate that the number
 of words depends on the real
 finished product.

ID NO. "X"

Label manufacturer's code.
 It is accurate that the number
 of words depends on the real
 finished product.

Label Part No. : 9443026860

Steven
4/24/11

8.8 Spec. Label Dimension : 90mm(L)*65mm(W)+/-0.1mm

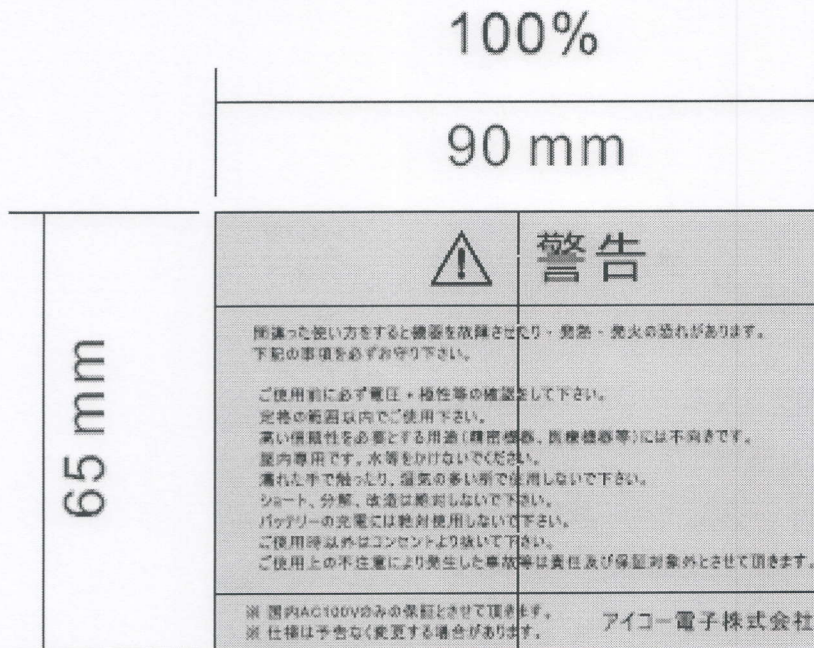

此虚線為對折線，不需印刷。
 對折方式:字朝外對折
 放入PE袋內

Label Part No. : 9471120201

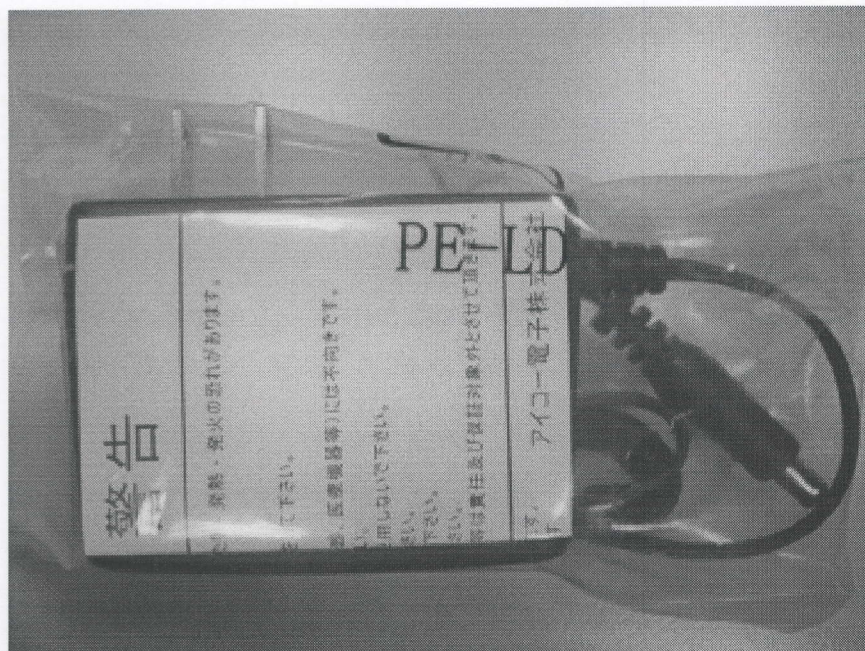



A. Line Regulation Test

Test Result :

Test condition	Spec.	Reading 1	Reading 2	Reading 3
90Vac / 50 % Load	11.4~12.6 V	11.949 V	11.948 V	11.950 V
115Vac / 50 % Load	11.4~12.6 V	11.950 V	11.949 V	11.951 V
132Vac / 50 % Load	11.4~12.6 V	11.950 V	11.949 V	11.951 V
180Vac / 50 % Load	11.4~12.6 V	11.950 V	11.947 V	11.950 V
230Vac / 50 % Load	11.4~12.6 V	11.950 V	11.949 V	11.949 V
264Vac / 50 % Load	11.4~12.6 V	11.950 V	11.949 V	11.950 V

B. Efficiency Test

Test Result :

Test condition	Spec.	Reading 1	Reading 2	Reading 3
115Vac	82.22 % Min..	83.25 %	83.11 %	82.98 %
230Vac	82.22 % Min..	82.44 %	82.43 %	82.33 %

$$\text{Eff}_{(av)} = \frac{E_1 + E_2 + E_3 + E_4}{4}$$

E1=efficiency with 25% rated load ; E2= efficiency with 50% rated load

E3=efficiency with 75% rated load ; E4= efficiency with 100% rated load

C. Load Regulation Test

Test Result :

Test condition	Spec.	Reading 1	Reading 2	Reading 3
115Vac / 0 % Load	11.4~12.6 V	12.075 V	12.073 V	12.074 V
115Vac / 50 % Load	11.4~12.6 V	11.950 V	11.948 V	11.949 V
115Vac / 100 % Load	11.4~12.6 V	11.824 V	11.825 V	11.822 V
230Vac / 0 % Load	11.4~12.6 V	12.075 V	12.077V	12.073 V
230Vac / 50 % Load	11.4~12.6 V	11.950 V	11.952V	11.948 V
230Vac / 100 % Load	11.4~12.6 V	11.824 V	11.822 V	11.822 V

D. Ripple & Noise Test

Test Result :

Test condition	Spec.	Reading 1	Reading 2	Reading 3
115Vac / 100 % Load	100mVpp Max	56.7mVpp	55.4mVpp	55.1mVpp
230Vac / 100 % Load	100mVpp Max	57.5mVpp	58.8mVpp	56.7mVpp



E. Inrush Current

Test Result :

Test condition	Spec.	Reading 1	Reading 2	Reading 3
115Vac / 100 % Load	30A Max.	27.8 A	27.9A	27.5A
230Vac / 100 % Load	45A Max	42.6 A	43.2A	43.3A

F. Over Current Protection

Test Result :

Test condition	Spec.	Reading 1	Reading 2	Reading 3
115Vac / 100 % Load	4A Max.	2.688 A	2.658 A	2.701A
230Vac / 100 % Load	4A Max.	3.011 A	2.912 A	3.001A

G. Short Circuit Protection

Test Result :

Test condition	Spec.	Reading 1	Reading 2	Reading 3
115Vac / 100 % Load	Auto Recovery	OK	OK	OK
230Vac / 100 % Load	Auto Recovery	OK	OK	OK

H. Input Power Consumption(No Load)

Test Result :

Test condition	Spec.	Reading 1	Reading 2	Reading 3
230Vac / 0 % Load	≤ 0.3 W	0.27W	0.26W	0.27W



Adapter Technology Co., Ltd.

Efficiency Test Report

- A. Model Number : STD-12020Z (Z=A,B,C,E,K,T,U,V) (12V / 2A / 24W)
 B. DC Power Cord : UL2468 , 20AWG , 1.8M
 C. Average Efficiency :
 Energy Star V (0.0626*Ln(Nameplate Output)+0.622) = 82.09 % Min.
 Erp (Stage 2) (0.063*Ln(Nameplate Output)+0.622) = 82.22 % Min.
 MEPS V (0.0626*Ln(Nameplate Output)+0.622) = 82.09 % Min.
 D. NO Load Power Consumption :
 Energy Star V 0.3W Max.
 Erp (Stage 2) 0.3W Max.
 MEPS V 0.3W Max.
 E. Testing Dequpment :
 a. AC Power Source : " Zentech " 2700M-10
 b. Electronic Load : " PRODIGIT " 3311C
 c. Power Meter : " Zentech " 2100
 d. Digital Meter : " FLUKE " 45
 F. AC Input Voltage : 115Vac/60Hz

Load Conditions	100% * I ₀	75% * I ₀	50% * I ₀	25% * I ₀	0% * I ₀
Reported Quantity					
Rms Output Current(mA)	2000mA	1500mA	1000mA	500mA	0mA
Rms Output Voltage(V)	11.846V	11.923V	12.001V	12.091V	12.156V
Active Output Power(W)	23.69W	17.88W	12.00W	6.05W	0.00W
Rms Input Voltage(V)	115V	115V	115V	115V	115V
Rms Input Current(A)	0.465A	0.360A	0.259A	0.152A	0.011A
Rms Input Power(W)	29.00W	21.60W	14.30W	7.28W	0.16W
T.H.D. (Voltage)	0.27	0.25	0.21	0.13	0.11
True Power Factor	0.540	0.512	0.468	0.047	0.185
Power Consumed by UUT(W)	5.31W	3.72W	2.30W	1.23W	0.16W
Efficiency	81.70%	82.80%	83.92%	83.04%	*
Average Efficiency	82.87%				*

- G. AC Input Voltage : 230Vac/50Hz

Load Conditions	100% * I ₀	75% * I ₀	50% * I ₀	25% * I ₀	0% * I ₀
Reported Quantity					
Rms Output Current(mA)	2000mA	1500mA	1000mA	500mA	0mA
Rms Output Voltage(V)	11.845V	11.922V	12.000V	12.078V	12.156V
Active Output Power(W)	23.69W	17.88W	12.00W	6.04W	0.00W
Rms Input Voltage(V)	230V	230V	230V	230V	230V
Rms Input Current(A)	0.313A	0.245A	0.170A	0.097A	0.013A
Rms Input Power(W)	28.70W	21.60W	14.60W	7.41W	0.25W
T.H.D. (Voltage)	0.23	0.18	0.16	0.12	0.11
True Power Factor	0.391	0.378	0.360	0.330	0.078
Power Consumed by UUT(W)	5.01W	3.72W	2.60W	1.37W	0.25W
Efficiency	82.54%	82.79%	82.19%	81.50%	*
Average Efficiency	82.26%				*

Tester : Wei

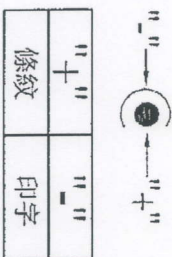
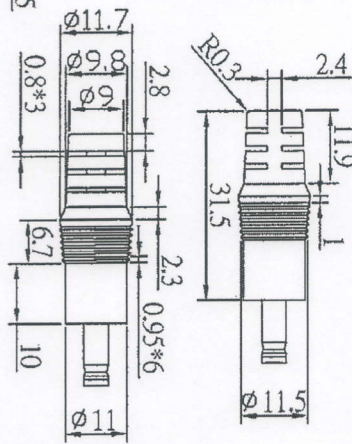
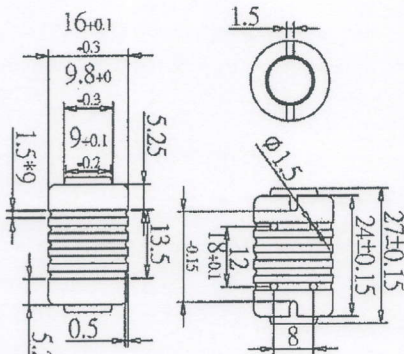
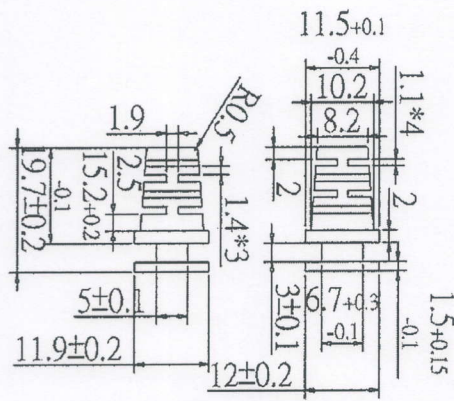
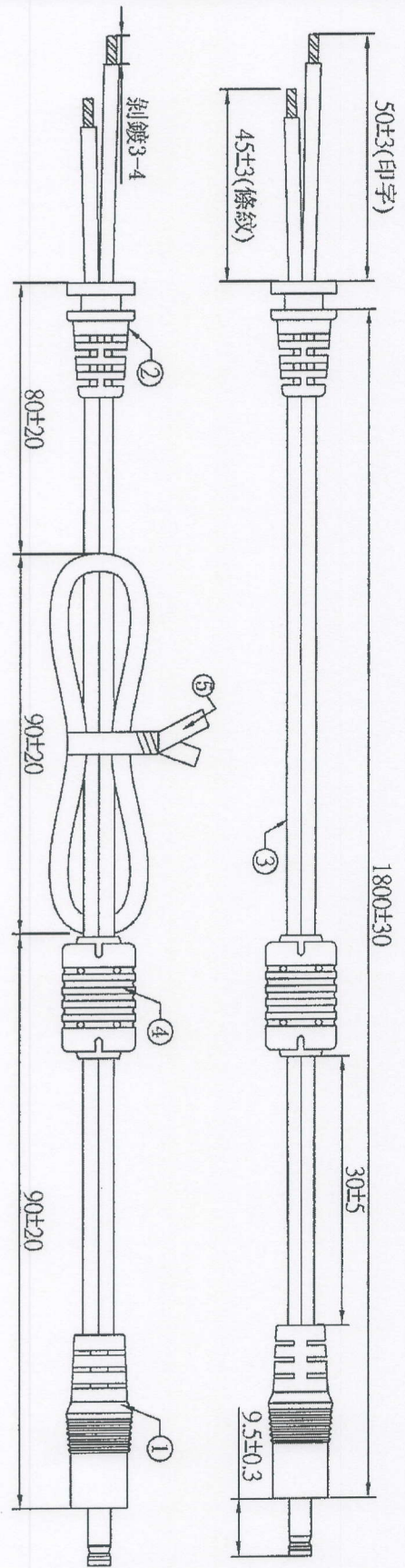

注意:此圖面所需材料符合"ROHS"標準

- ① 5.5*2.1*21 音叉車溝黑色半邊 (YY-PD-00023), 外模 P-184 號模 (二次成型), 用料外 PVC60P 黑色 (YY-PV-00009)
- ② SR-101 號模, 用料 PVC60P 黑色 (YY-PV-00009), 吊重: 1 米 / 20 磅 / 60 秒
- ③ UL 2468 20AWG(0.16*26) BK OD: 1.9*3.8 (YY-DC-00164) 裁線長度: 1860+10/-0
- ④ 鐵芯規格: 12*20*5.6 (YY-CR-00042), 外模 SR-136 號模, 用料 PVC40P 黑色
- ⑤ PE 有鐵芯 紮帶 10CM 黑色 (YY-ES-00001)
- ⑥ 絕緣阻抗: 20Ω, 導通阻抗: 1.5Ωmax
- ⑦ 單位: MM

料號	R44M1918015		制圖	劉鋒
客戶	阿達特	初審	審核	
版次	03	03		
頁數	01			
版次	03	泰岳電子有限公司		
內容	SR尺寸	圖號	ADT-0931	日期 2009/06/04

Steven Hall



Adapter Technology Co., Ltd.

SHOW	REV	DESCRIPTION	DATE	APPROVED
△	A	初版制作	Jun/25/2009	

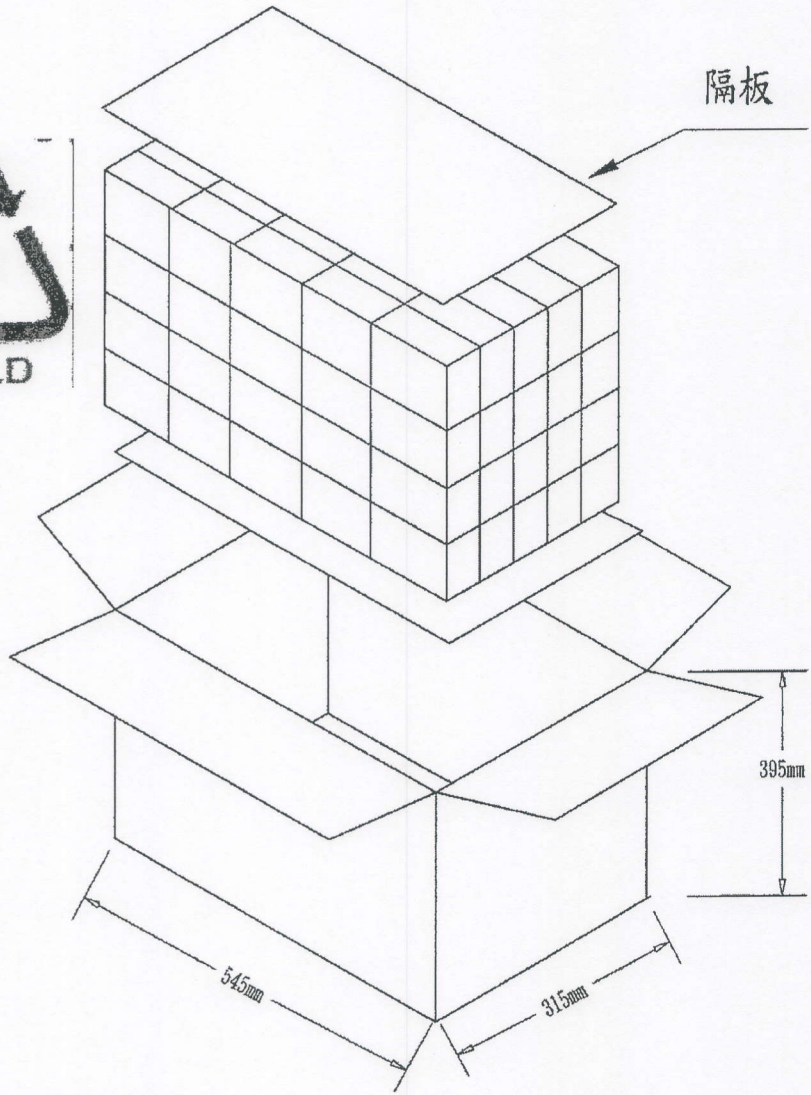
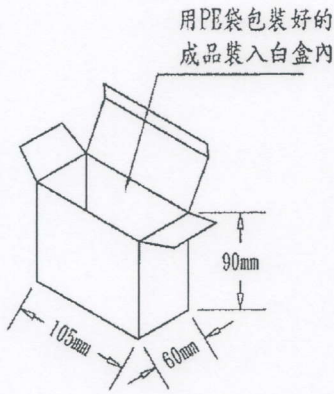
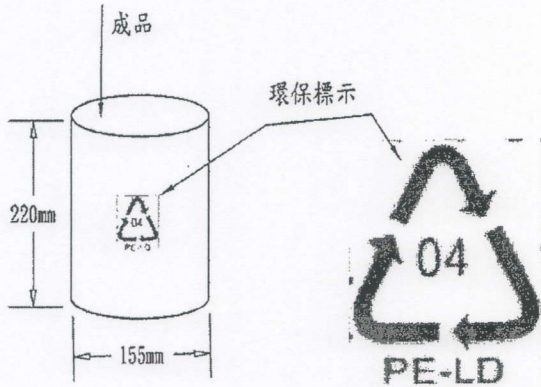

零件料號

- 9550006001 1. 隔板: 530*300*6mm B=B 2/100
- 2. 數量: 25*4=100PCS
- 9520006502 3. 外箱: L*W*H=545*315*395mm K=K 1/100
- 9510003502 4. 紙盒: L*W*H=105*60*90mm 白盒 350P+CE(即C9紙加裱350磅白板紙)
- 9540003001 5. 環保PE袋: 220*155*0.09mm 無色透明, 長邊中間位置印環保標示, 短邊單端開口
- 6. 成品裝入氣泡袋后, 用小膠紙封口
- 7. 外箱, 紙盒標注為外徑尺寸
- 8. 上述所有材料須符合環保ROHS標準.

阿達特科技股份有限公司

DRAWING NO. PIS18W00008		APPROVAL 1 BY		
UNIT	MODEL NO. 18W, 24K(抽屜式)	APPROVAL 2 BY		
NO	FILE NO. PACKAGE_Y_356	CHECKED BY(ENGINEER)	張裕璋	DATE: 2009/06/25
SCALE	REV. A	SHEET 1/1	DRAWN BY	SUN
				DATE: 2009/06/25

Steven 4/11/11