

Keylock switch, Series 82, Ø 25 mm, Flush, Plug-in terminal

82-6121.2000



<https://www.eao.com/p/670e5b9b>

Your product:



82-6121.2000

Keylock switch, Series 82, Ø 25 mm,
Flush, Plug-in terminal

PRODUCT RANGE

HMI function: Keylock switch

Series: Series 82

FRONT

Front dimension: Ø 25 mm

Front form: Round

Front bezel material: Stainless steel

Front bezel shape: Flush

MOUNTING

Design: Flush

Mounting cut-out: Ø 22 mm

Mounting type: Panel mounting

OPERATING-/INDICATION PART

Lens colour: Silver

Lens material: Stainless steel

Lens illumination: Non illuminated

Lens shape: Flush

Lens optics: opaque

Illumination colour: none

ELECTRICAL CHARACTERISTICS

Switching voltage and switching current:

according to IEC 60947-5-1 (Silver contacts)		
Service categorie AC-15		
Voltage		Current
24 VAC		1 A
35 VAC		1 A (M12 versio
110 VAC		1 A
220 VAC		0.5 A
Switch rating DC service categorie DC-13 (Silver contacts)		
Voltage		Current
24 VDC		0.7 A
35 VDC		0.5 A (M12 vers
110 VDC		0.2 A
220 VDC		0.1 A

according to UL 508 (Silver contacts)

cosφ 0,75 ... 0,8		
Voltage		Current
120 VAC		5 A
240 VAC		3 A
24 VAC		1 A

Switching rating:	240 V
Electrical lifetime:	50 000 cycles of operation
Thermal current I_{th}:	5 A

MECHANICAL CHARACTERISTICS

Terminal:	Plug-in terminal
Contact material:	Silver
Switching action:	Rest (a) - Maintained (a)
Switching system:	Snap-action switching element
Switching positions:	2 positions
Switching angle:	90° right
Tightening torque:	0.5 ... 0.6 Nm, Screw terminal 0.1 Nm

AMBIENT CONDITION

IP front protection:	IP65
Operating temperature:	- 30 °C ... + 70 °C
Vibration resistance:	10 ... 500 Hz, amplitude 1.5 mm p-p according to IEC 60068-2-6

OTHER

Housing size:	19 mm
----------------------	-------

Housing material: Plastic

Wiring diagrams:

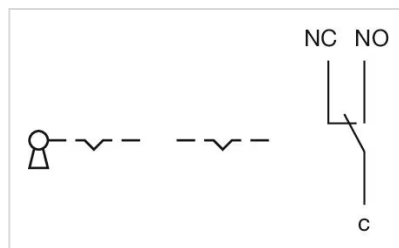

Your product consists of the following **1 COMPONENTS:**



82-6121.2000
Keylock switch

FRONT

Front dimension: Ø 25 mm

Front form: Round

Front bezel material: Stainless steel

Front bezel shape: Flush

MOUNTING

Mounting cut-out: Ø 22 mm

Mounting type: Panel mounting

OPERATING-/INDICATION PART

Lens colour: Silver

Lens material: Stainless steel

Lens illumination: Non illuminated

Lens shape: Flush

Lens optics: opaque

Illumination colour: none

ELECTRICAL CHARACTERISTICS

Switching voltage and switching current:

according to IEC 60947-5-1 (Silver contacts)	
Service categorie AC-15	
Voltage	Current
24 VAC	1 A
35 VAC	1 A (M12 versio
110 VAC	1 A
220 VAC	0.5 A
Switch rating DC service categorie DC-13 (Silver contacts)	
Voltage	Current
24 VDC	0.7 A
35 VDC	0.5 A (M12 vers
110 VDC	0.2 A
220 VDC	0.1 A

according to UL 508 (Silver contacts)	
cosφ 0,75 ... 0,8	
Voltage	Current
120 VAC	5 A
240 VAC	3 A
24 VAC	1 A

Contacts: 1 C

Rated Operational Voltage Ue: 250 VAC

Rated insulation voltage Ui: 250 V

Switching rating: 240 V

Electrical lifetime: 50 000 cycles of operation

Electric strength: 1500 VAC, 50 Hz 1 minute between life terminals and ground

Pollution degree: 2, according to EN IEC 60947-1

Thermal current Ith: 5 A

MECHANICAL CHARACTERISTICS

Terminal: Plug-in terminal

Contact material: Silver

Switching action: Rest (a) - Maintained (a)

Switching system: Snap-action switching element

Switching positions: 2 positions

Switching angle: 90° right

Operating force: 4 N ... 7 N

Operating Travel: ca. 3 mm

Tightening torque:

0.5 ... 0.6 Nm, Screw terminal 0.1 Nm

Weight: 0.044 kg

AMBIENT CONDITION

IP front protection: IP65

Operating temperature: - 30 °C ... + 70 °C

Storage temperature: - 40 °C ... + 80 °C

Shock resistance: Max. 500 m / s² as per IEC 60068-2-27

Vibration resistance: 10 ... 500 Hz, amplitude 1.5 mm p-p according to IEC 60068-2-6

Climate resistance: Damp heat, 21 days according to IEC 60512-11

CERTIFICATE

Approbations: CB, CCC, C UL, UL

Conformities: CE, 2011 / 65 / EC (RoHS), 2014 / 35 / EU (LVD)

REACH: REACH compliant

RoHS: RoHS compliant

OTHER

Short Description: Keylock switch, Rest (a) - Maintained (a), 240 V, 1 C, Plug-in terminal, Round, Stainless steel, none, Silver

Kind of illumination: Single-LED

Housing size: 19 mm

Housing material: Plastic

Switching positions:

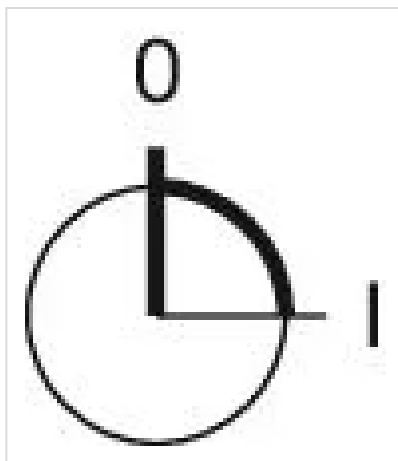

Wiring diagrams:

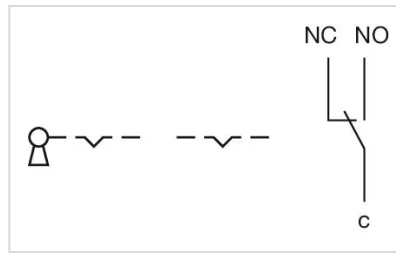

Component layouts:

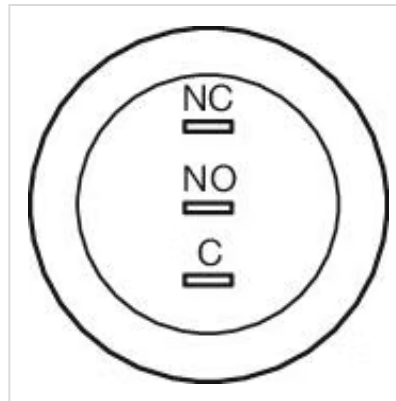

Mounting cut-outs:

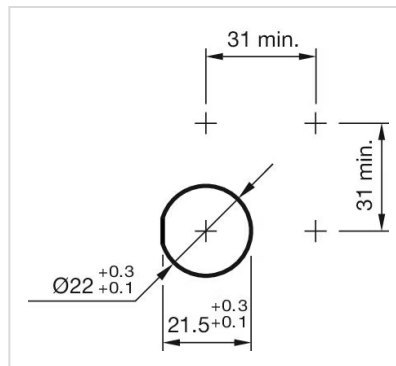

Dimension drawings:

