



### Product highlights

- For corrosive gasses and liquids
- Class 1.6 according to EN 837-1
- Wetted parts: Stainless steel
- Case with crimped bezel ring
- Lloyds Register Approval
- Option: Liquid-filled for applications with pulsations or vibrations
- Option: Case material 1.4404 (316L) for aggressive atmosphere



### Technical data

#### Housing

Nominal size	63 mm
Case material	<ul style="list-style-type: none"> <li>■ Stainless steel 1.4301 / AISI 304</li> <li>■ Stainless steel 1.4404 / AISI 316L, optional</li> </ul>
Type of housing	Crimped bezel ring (option 0133 mandatory)
Bezel ring material	<ul style="list-style-type: none"> <li>■ Stainless steel 1.4301 / AISI 304</li> <li>■ Stainless steel 1.4404 / AISI 316L, optional</li> </ul>
Window material	Polycarbonate
Window gasket	Elastomer
Protection rating (EN 60529)	IP65
Dial	White, aluminium
Pointer	Black, aluminium
Movement material	Stainless steel
Safety according to EN 837-1	S1, with window polycarbonate

#### Temperature

Ambient temperature	-20°C ... +70°C
Storage temperature	-40°C ... +70°C
Media temperature	-40°C ... +200°C (not filled)

#### Wetted parts

Process connection material	Stainless steel 1.4404 / AISI 316L
Bourdon tube	Stainless steel 1.4404 / AISI 316L

#### Performance

Accuracy according to EN 837-1	Class 1.6
Min. measuring range	0 ... 1 bar
Max. measuring range	0 ... 400 bar
Type of pressure	<ul style="list-style-type: none"> <li>■ Gauge</li> <li>■ Compound</li> <li>■ Vacuum</li> </ul>
Pressure limitation	<ul style="list-style-type: none"> <li>■ Steady: 75 % of full scale value</li> <li>■ Fluctuating: 65 % of full scale value</li> <li>■ Short time: 100 % of full scale value</li> </ul>

Temperature coefficient at +20°C: ± 0.4 % FS/10K

#### Weight

Gauge	<ul style="list-style-type: none"> <li>■ 130 g unfilled</li> <li>■ 180 g filled</li> </ul>
-------	--

#### Approval / Conformities

ATEX	Ex II 2 GDC-IM2c
------	------------------

### Technical drawings

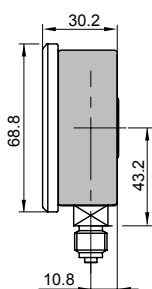

Type D crimped version

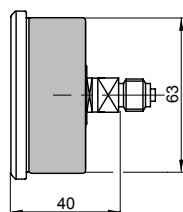

Type F crimped version

## Ordering reference

### Order key

	MEX	3	-	D	x	x	.	xxx
<b>Product</b>	MEX							
MEX Industrial pressure gauge	MEX							
<b>Dimension</b>								
Nominal size 63 mm		3						
<b>Case</b>								
Bottom connection				D				
Back connection				F				
Bottom connection, Case 1.4404 (316L)				4				
Back connection, Case 1.4404 (316L)				6				
<b>Process connection</b>								
G 1/4					2			
1/4 - 18 NPT					5			
<b>Damping fluid</b>								
Without damping fluid								0
BH1, Glyzerin 86 %								1
BH2, Glyzerin 99 %								2
BH3, Silicone oil								3
<b>Measuring range<sup>(1)</sup></b>								
bar (EN)								Bxx
kPa (EN)								Dxx
MPa (EN)								Exx
kg/cm2 (EN)								Fxx
psi (ANSI)								Hxx
bar/psi (EN)								Kxx
psi/bar (ANSI)								Sxx
psi/kPa (ANSI)								Vxx
kPa/psi (EN)								Wxx
mbar (EN)								Nxx

### Preferred Types

<sup>(1)</sup> Available standard pressures ranges, see table in section pressure ranges. For ranges not listed, please contact Bourdon

**Ordering reference**
**Pressure ranges**

Code	Bar	Code	kPa	Code	kg/cm <sup>2</sup>	Code	psi
B72	-1 ... 0.6	D72	-100 ... 60	F72	-1 ... 0.6	H73	-30" Hg ... 15
B74	-1 ... 1.5	D74	-100 ... 150	F74	-1 ... 1.5	H75	-30" Hg ... 30
B76	-1 ... 3	D76	-100 ... 300	F76	-1 ... 3	H2C	-30" Hg ... 60
B77	-1 ... 5	D77	-100 ... 500	F77	-1 ... 5	H78	-30" Hg ... 100
B79	-1 ... 9	D79	-100 ... 900	F79	-1 ... 9	H79	-30" Hg ... 150
B81	-1 ... 15	D81	-100 ... 1 500	F81	-1 ... 15	H81	-30" Hg ... 220
B82	-1 ... 24	D82	-100 ... 2 400	F82	-1 ... 24	H82	-30" Hg ... 300
B15	0 ... 1	D15	0 ... 100	F15	0 ... 1	H15	0 ... 15
B16	0 ... 1.6	D16	0 ... 160	F16	0 ... 1.6	H1C	0 ... 20
B18	0 ... 2.5	D18	0 ... 250	F18	0 ... 2.5	H17	0 ... 30
B19	0 ... 4	D19	0 ... 400	F19	0 ... 4	H19	0 ... 60
B20	0 ... 6	D20	0 ... 600	F20	0 ... 6	H21	0 ... 100
B22	0 ... 10	D22	0 ... 1 000	F22	0 ... 10	H22	0 ... 160
B24	0 ... 16	D24	0 ... 1 600	F24	0 ... 16	H23	0 ... 200
B26	0 ... 25	D26	0 ... 2 500	F26	0 ... 25	H25	0 ... 300
B27	0 ... 40	D27	0 ... 4 000	F27	0 ... 40	H26	0 ... 400
B29	0 ... 60	D29	0 ... 6 000	F29	0 ... 60	H27	0 ... 600
B31	0 ... 100	D31	0 ... 10 000	F31	0 ... 100	H30	0 ... 1 000
B33	0 ... 160	D33	0 ... 16 000	F33	0 ... 160	H31	0 ... 1 500
B35	0 ... 250	D35	0 ... 25 000	F35	0 ... 250	H34	0 ... 3 000
B38	0 ... 400	D38	0 ... 40 000	F38	0 ... 400	H38	0 ... 6 000

**Options**

Crimped housing <sup>(1)</sup>	0133	2.2 certificate	Q002
ATEX II2GDc T6-IM2c <sup>(2)</sup>	0078	3.1 material certificate	Q003
Instrumentglass	0750	3.1 calibration certificate 5 pts. (rising)	Q008
Restrictor screw 0,3 mm	0769	3.1 calibration certificate 5 pts. (EN837)	Q009
2.1 certificate	Q001		

<sup>(1)</sup> Mandatory option

<sup>(2)</sup> Only available with instrumentglass

## Ordering reference

### Ordering example

**MEX 3 - D 2 0 . B22 / 0133**

#### Product

MEX Industrial pressure gauge

#### Dimension

Nominal size 63 mm

#### Case

Bottom connection

#### Process connection

G 1/4

#### Damping fluid

Without damping fluid

#### Measuring range

0...10 bar (EN)

#### Type of housing

Crimped housing