

Features

- Completely made of AISI 316 stainless steel
- Available with different number of loops and wire diameters
- Can be applied below, above or aside the machine
- High static deflection, low resonance frequency and high vibration isolation
- High damping, also suitable for machines with imbalances
- Suitable for use with with compression, traction and shear
- Suitable for applications where impacts and shocks may occur
- Resistant to flames, high temperatures and corrosion

RS PRO Wire Rope Isolators

RS Stock No.: 0629662



RS Professionally Approved Products bring to you professional quality parts across all product categories. Our product range has been tested by engineers and provides a comparable quality to the leading brands without paying a premium price.

The wire rope isolators comprise two pairs of bars, joined together by a connecting cable with a helical winding (coil).

They are generally used for isolating vibrations and shock absorption, where axial holding force, resistance to compression and shear force is required.

Vibrations can cause:

- Malfunctioning and reduction of the machine lifespan and/or of the adjacent ones
- Damage to health
- Noise
-

They are particularly suitable for use with HVAC, pumps, purification and desalination plants, instrumentation panels, rail, naval and military.

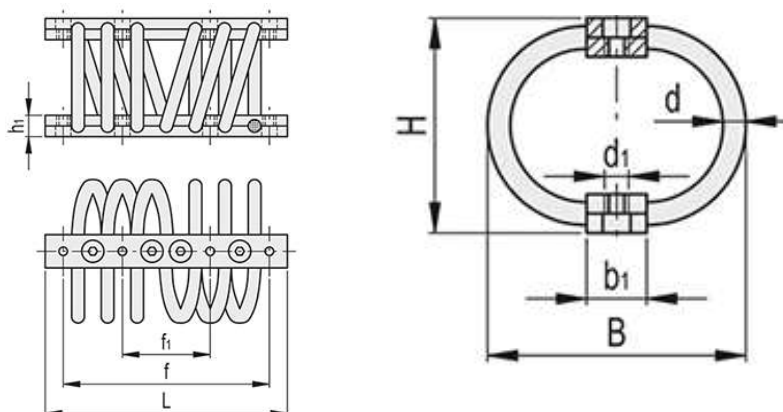

General Specifications

Part n°	Loops	B	L	H	d	d1	b1	h1	f	f1
0629653	4	53±3	71	45±3	4	M6	15	8	61	
0629654	4	61±3	91	51±3	6	M6	15	12	46	
0629655	4	90±4	91	65±4	6	M6	15	12	46	
0629656	4	110±4	91	79±4	7	M6	15	12	46	
0629657	4	80±4	155	68±4	10	M8	25	16	83	
0629658	4	108±4	155	89±4	10	M8	25	16	83	
0629659	4	101±4	155	80±4	13	M8	25	20	83	
0629660	6	82±4	200	60±4	7	M6	15	12	155	66
0629661	6	67±4	200	53±4	8	M6	15	12	155	66
0629662	6	80±4	169	68±4	10	M6	25	16	155	66
0629663	6	135±4	178	110±5	13	M8	25	20	155	66
0629664	8	118±4	222	95±4	13	M6	25	20	66	155

Mechanical Specifications

Part n°	Compression resistance / axial holding force		Shear resistance		Compression resistance		Axial holding force		Shear resistance	
	Min load [N]	Max load [N]	Min load [N]	Max load [N]	Min deflection [mm]	Max deflection [mm]	Min deflection [mm]	Max deflection [mm]	Min deflection [mm]	Max deflection [mm]
0629653	50	110	20	40	2	5	1	3	5	10
0629654	200	300	70	150	2	4	2	3	3	7
0629655	70	140	30	70	2	7	3	6	5	13
0629656	80	180	30	90	2	9	2	8	5	17
0629657	850	1500	400	900	2	5	1	3	4	11
0629658	300	630	150	300	2	7	2	6	5	14
0629659	1000	2500	500	1000	2	8	2	5	5	13
0629660	200	450	100	230	2	6	2	5	3	11
0629661	600	1000	300	600	2	4	2	3	3	8
0629662	1500	2500	750	1400	2	5	1	3	5	11
0629663	850	1500	300	800	4	11	4	11	6	21
0629664	1500	3000	600	1500	4	11	3	7	7	19

Approvals

Declarations	MFR Declaration of Conformity
Hazardous Area Certification	ATEX / IECEx
Standards Met	VDE