



Impact sockets 1/2" "long 12 points thin

19143-32M

19143-...M

SAM Outillage

10 rue Camille de RochetaillÃ©e
42000 Saint-Etienne - France

RCS Saint-Etienne B 338 002 231 | SAS au capital de 8 189 583 â,-

<https://www.sam-outillage.com/>

Photos and texts not contractually binding. Do not litter. Document generated on 2025-07-18 08:49:50





DESCRIPTION

Impact sockets 1/2" "long 12 points thin

Sockets approximately 85 mm long. 12-Flat open-end. Ideal for tightening and loosening hub nuts, PSA, VAG, etc. Drive squares 1/2". Can be used on pneumatic machines.

STANDARDS / DIRECTIVES

NF ISO 1174-2, NF ISO 1711-2, NF ISO 2725-2

SAM Outillage

10 rue Camille de RochetaillÃ©e
42000 Saint-Etienne - France

RCS Saint-Etienne B 338 002 231 | SAS au capital de 8 189 583 â,-

<https://www.sam-outillage.com/>

Photos and texts not contractually binding. Do not litter. Document generated on 2025-07-18 08:49:50



SPECIFIC DATA

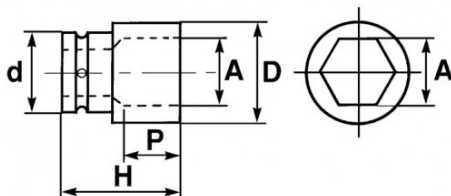

Designation	12-FLAT LONG IMPACT SOCKET 1/2" 32 MM EXTRA THIN
Sales reference	19143-32M
Weight (g)	360
H (mm)	85
d (mm)	29
D (mm)	43
P (mm)	30
A (mm)	32
Guarantee	O

Guarantee applied

O | SAM TOOL guarantee.

Guarantee without time limit on the tools used under normal conditions.

[>> Find out more](#)

SAM Outillage

10 rue Camille de RochetaillÃ©e
 42000 Saint-Etienne - France

RCS Saint-Etienne B 338 002 231 | SAS au capital de 8 189 583 â,-

<https://www.sam-outillage.com/>

