

RS PRO LED TRAFFIC LIGHT ASSEMBLY

Stock No: 2288638

ENGLISH

Position the bracket on the mounting surface, mark and drill appropriate holes for the fixing screws, not supplied. The brackets are designed with a key hole slot at the top and an elongated one at the bottom (see diagram 1) and then securely fix the traffic light assembly in place.

Once the traffic light assembly is firmly secured remove the 2 screws retaining the shroud and lens from the green TL module, remove shroud and carefully pull lens from back box to show termination block in the base of the unit. The control wires are colour coordinated with the lens colours and terminate in this block.

Insert the power/control cable through the M16 cable gland (4.5 – 10mm max cable diameter) attached to the bottom of the green module base and connect to the termination block as required (see diagram 2)

Diagram 1

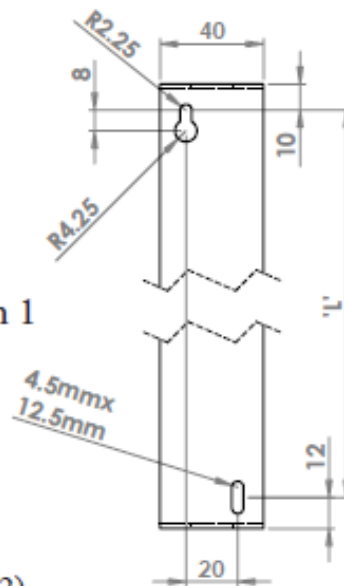

Ensure 'O' rings are in place on bases. Line up the lens holes with those in the base and carefully snap the lens into position, taking care that the power cables do not foul PCB components. Fit the shrouds over the lenses and secure in position with the screws.

By slackening off the top & bottom M16 glands the traffic lights can now be rotated through 180 degrees to optimise the best viewing position.

Once this has been selected gently tighten up the two M16 glands.

General

- Installation must be carried out in accordance with the latest codes of practice and regulations by a qualified engineer.
- Ensure power source is disconnected prior to installation or maintenance to avoid danger of electrical shock.
- Do not handle internal electrical components whilst wiring up.
- Environmental exposure conditions during installation should be dry, moist or wet conditions should be avoided.
- The lens material of the beacon is VO rated UV stable polycarbonate plastic. Do not clean with petroleum based cleaners.
- Avoid mounting the beacon where it will be subject to excessive vibration.