

Interface module - DFLK-D15 SUB/M/FKCT - 2903054

Please be informed that the data shown in this PDF Document is generated from our Online Catalog. Please find the complete data in the user's documentation. Our General Terms of Use for Downloads are valid (<http://phoenixcontact.com/download>)



The VARIOFACE feed-through module implements a 1:1 connection between plug-in push-in spring-cage connection terminal blocks and a D-SUB miniature pin strip (number of positions: 15). A separate ground tap is available.



Key commercial data

| | |
|--------------------------------------|--|
| Packing unit | 1 pc |
| GTIN |  4 046356 709637 |
| Weight per Piece (excluding packing) | 77.5 g |
| Custom tariff number | 85369010 |
| Country of origin | Germany |
| Note | Made to Order (non-returnable) |

Technical data

Dimensions

| | |
|--------|---------|
| Width | 36.5 mm |
| Height | 58.4 mm |
| Depth | 46 mm |

Ambient conditions

| | |
|---|------------------|
| Ambient temperature (operation) | -20 °C ... 50 °C |
| Ambient temperature (storage/transport) | -20 °C ... 70 °C |

General

| | |
|---|---------------------------|
| Max. permissible operating voltage | 125 V AC/DC |
| Max. perm. current (per branch) | 2.5 A |
| Max. permissible current (all branches) | 37.5 A |
| Number of positions | 15 |
| Mounting position | any |
| Assembly instructions | In rows with zero spacing |
| Degree of protection | IP20 |
| Standards/regulations | DIN EN 50178 |

Interface module - DFLK-D15 SUB/M/FKCT - 2903054

Technical data

General

| | |
|--------------------------|--------------------------------|
| | IEC 60664 |
| | IEC 62103 |
| Rated insulation voltage | 125 V |
| Rated surge voltage | 1.2 kV (Functional insulation) |
| Pollution degree | 2 |
| Surge voltage category | II |

Connection data for connection 1

| | |
|--|--|
| Connection name | Field level |
| Connection method | Plug-in push-in spring-cage connection |
| Conductor cross section solid min. | 0.2 mm ² |
| Conductor cross section solid max. | 2.5 mm ² |
| Conductor cross section stranded min. | 0.2 mm ² |
| Conductor cross section stranded max. | 2.5 mm ² |
| Conductor cross section AWG/kcmil min. | 24 |
| Conductor cross section AWG/kcmil max. | 12 |
| Stripping length | 10 mm |

Connection data for connection 2

| | |
|---------------------|------------------|
| Connection name | Controller level |
| Connection method | D-SUB pin strip |
| Number of positions | 15 |

Classifications

eCl@ss

| | |
|------------|----------|
| eCl@ss 4.0 | 27250313 |
| eCl@ss 4.1 | 27250313 |
| eCl@ss 5.0 | 27250313 |
| eCl@ss 5.1 | 27250313 |
| eCl@ss 6.0 | 27242608 |
| eCl@ss 7.0 | 27141152 |
| eCl@ss 8.0 | 27141152 |

ETIM

| | |
|----------|----------|
| ETIM 2.0 | EC001434 |
| ETIM 3.0 | EC001604 |
| ETIM 4.0 | EC001604 |
| ETIM 5.0 | EC002780 |

UNSPSC

| | |
|-------------|----------|
| UNSPSC 6.01 | 30211824 |
|-------------|----------|

Interface module - DFLK-D15 SUB/M/FKCT - 2903054

Classifications

UNSPSC

| | |
|---------------|----------|
| UNSPSC 7.0901 | 39121421 |
| UNSPSC 11 | 39121421 |
| UNSPSC 12.01 | 39121421 |
| UNSPSC 13.2 | 39121421 |

Approvals

Approvals

Approvals

UL Recognized / cUL Recognized / EAC / cULus Recognized

Ex Approvals

Approvals submitted

Approval details

| | |
|---|-------|
| UL Recognized  | |
| mm²/AWG/kcmil | 30-12 |
| Nominal current I _N | 1 A |
| Nominal voltage U _N | 125 V |

| | |
|--|-------|
| cUL Recognized  | |
| mm²/AWG/kcmil | 30-12 |
| Nominal current I _N | 1 A |
| Nominal voltage U _N | 125 V |

| |
|-----|
| EAC |
|-----|

| |
|--|
| cULus Recognized  |
|--|

Interface module - DFLK-D15 SUB/M/FKCT - 2903054

Accessories

Accessories

System cable

Cable - CABLE-D15SUB/B/S/ 50/KONFEK/S - 2302052



Round shielded cable set, with 15-pos. D-SUB female and male connectors, cable length: 0.5 m

Cable - CABLE-D15SUB/B/S/100/KONFEK/S - 2302065



Round shielded cable set, with 15-pos. D-SUB female and male connectors, cable length: 1 m

Cable - CABLE-D15SUB/B/S/150/KONFEK/S - 2302078



Round shielded cable set, with 15-pos. D-SUB female and male connectors, cable length: 1.5 m

Cable - CABLE-D15SUB/B/S/200/KONFEK/S - 2302081



Round shielded cable set, with 15-pos. D-SUB female and male connectors, cable length: 2 m

Cable - CABLE-D15SUB/B/S/300/KONFEK/S - 2302094



Round shielded cable set, with 15-pos. D-SUB female and male connectors, cable length: 3 m

Interface module - DFLK-D15 SUB/M/FKCT - 2903054

Accessories

Cable - CABLE-D15SUB/B/S/400/KONFEK/S - 2302104



Round shielded cable set, with 15-pos. D-SUB female and male connectors, cable length: 4 m

Cable - CABLE-D15SUB/B/S/600/KONFEK/S - 2302117



Round shielded cable set, with 15-pos. D-SUB female and male connectors, cable length: 6 m

Cable - CABLE D-SUB-S/.../.../... - 2302340



Shielded round cable, assembled with one D-SUB male and one female connector, variable cable length

Cable - CABLE D-SUB-B-B-S/.../.../... - 2302421



Shielded round cable, assembled with two D-SUB female connectors, variable cable length

Cable - CABLE-D-15SUB/F/OE/0,25/S/0,5M - 2926085



Shielded cable with a 15-pos. D-SUB female connector and one open end. The individual wires are labeled 1 to 15 and fitted with ferrules. The braided shield is routed to a separate cable end. Cable length: 0.5 m.

Interface module - DFLK-D15 SUB/M/FKCT - 2903054

Accessories

Cable - CABLE-D-15SUB/F/OE/0,25/S/1,0M - 2926098



Shielded cable with a 15-pos. D-SUB female connector and one open end. The individual wires are labeled 1 to 15 and fitted with ferrules. The braided shield is routed to a separate cable end. Cable length: 1 m.

Cable - CABLE-D-15SUB/F/OE/0,25/S/1,5M - 2926108



Shielded cable with a 15-pos. D-SUB female connector and one open end. The individual wires are labeled 1 to 15 and fitted with ferrules. The braided shield is routed to a separate cable end. Cable length: 1.5 m.

Cable - CABLE-D-15SUB/F/OE/0,25/S/2,0M - 2926111



Shielded cable with a 15-pos. D-SUB female connector and one open end. The individual wires are labeled 1 to 15 and fitted with ferrules. The braided shield is routed to a separate cable end. Cable length: 2 m.

Cable - CABLE-D-15SUB/F/OE/0,25/S/3,0M - 2926124



Shielded cable with a 15-pos. D-SUB female connector and one open end. The individual wires are labeled 1 to 15 and fitted with ferrules. The braided shield is routed to a separate cable end. Cable length: 3 m.

Cable - CABLE-D-15SUB/F/OE/0,25/S/4,0M - 2926137



Shielded cable with a 15-pos. D-SUB female connector and one open end. The individual wires are labeled 1 to 15 and fitted with ferrules. The braided shield is routed to a separate cable end. Cable length: 4 m.

Interface module - DFLK-D15 SUB/M/FKCT - 2903054

Accessories

Cable - CABLE-D-15SUB/F/OE/0,25/S/6,0M - 2926140



Shielded cable with a 15-pos. D-SUB female connector and one open end. The individual wires are labeled 1 to 15 and fitted with ferrules. The braided shield is routed to a separate cable end. Cable length: 6 m.

Cable - CABLE-D-15SUB-F-OE-0,25-S/... - 2900905



Shielded cable with a 15-pos. D-SUB female connector and one open end. The individual wires are labeled 1 to 15 and fitted with ferrules. The braided shield is routed to a separate cable end. Cable length: variable.

Drawings

Dimensioned drawing

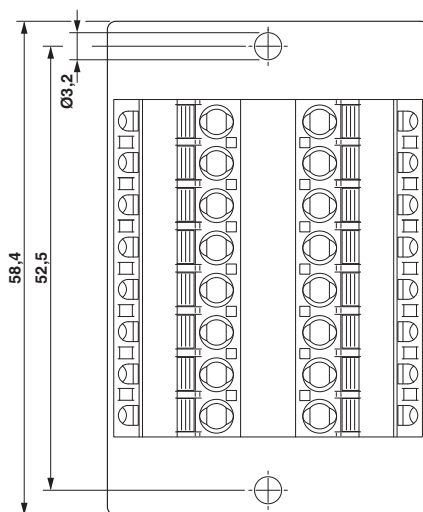

Dimensioned drawing

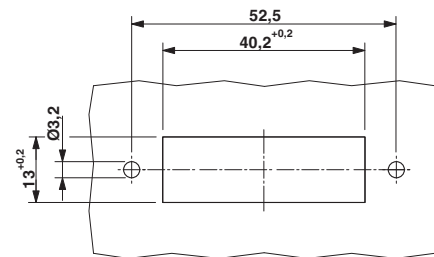

Interface module - DFLK-D15 SUB/M/FKCT - 2903054

Dimensioned drawing

