



**FAG**

## SES519-616-L [↗](#)

### Plummer block housing

Split plummer block housing for various bearing designs. The SNV series will be replaced by the new SES series in 2022.

## Technical information

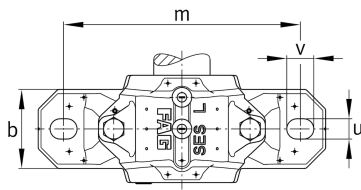

### Main Dimensions & Performance Data

D	170 mm	Outside diameter bearing
a	345 mm	Length base
h <sub>1</sub>	212 mm	Height
g	145 mm	Width housing body
K	68 mm	Width bearing seat
≈m	13.8 kg	Weight

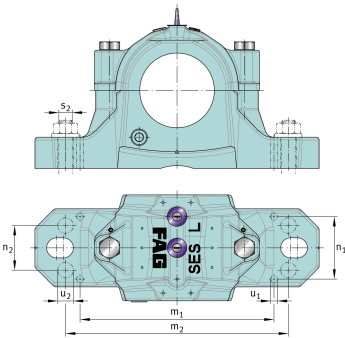
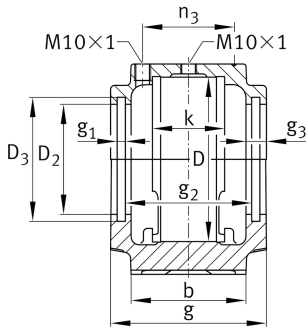
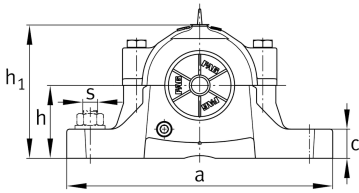

Dimensions

b	100 mm	Width base
c	35 mm	Height base
h	112 mm	Base to shaft centerline height
m	290 mm	Distance fixing bore
s	19.05 mm	Screw size
s	M20	Size of fixing screws
u	22 mm	Width slot
v	28 mm	Length slot
D 2	131 mm	Diameter sealing
D 3	141 mm	Diameter sealing groove
D 5	138.2 mm	Outside diameter sealing labyrinth
g 1	6 mm	Width sealing groove
g 2	125 mm	Distance sealing
g 3	14 mm	Wall thickness
g 4	38 mm	Distance oil lubrication
m 1	250 mm	Distance holes aligned pins m1
n 3	86 mm	Distance lubrication
n 4	128 mm	Distance lubrication sealing
u 1	8 mm	Bore diameter u1
u 2	18 mm	Bore diameter u2