



Part Number : [734153310](#)

Product Description : SMP Plug, Straight, Limited Detent, PCB, Surface Mount, Tape and Reel, 50 Ohms

Series Number : 73406

Status : Active

Product Category : RF / Coaxial Connectors

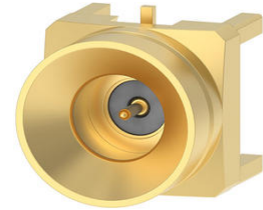

Documents & Resources

Drawings

[734153310_sd.pdf](#)

3D Models and Design Files

[STEP AP242](#)

[SOLIDWORKS](#)

[Creo](#)

[Symbol and Footprint \(Multi-Format\)](#)

Specifications

[PS-89675-332-001.pdf](#)

Product Environment Compliance

Compliance

GADSL/IMDS	Not Relevant
China RoHS	per SJ/T 11365-2006
EU ELV	Not Relevant
Low-Halogen Status	Low-Halogen per IEC 61249-2-21
REACH SVHC	Contains Lead per D(2025)4165-DC (25 June 2025)
EU RoHS	Compliant with Exemption 6(c) per EU 2015/863

[Compliance Statements](#)

- EU RoHS
- REACH SVHC

- Low-Halogen

Industry Documents

- IPC 1752A Class C
- IPC 1752A Class D
- Molex Product Compliance Declaration
- IEC-62474
- chemSHERPA (xml)

Substances of Interest

- PFAS

EU RoHS Certificate of Compliance

Additional Product Compliance Information

Part Details

General

Status	Active
Category	RF / Coaxial Connectors
Series	73406
Description	SMP Plug, Straight, Limited Detent, PCB, Surface Mount, Tape and Reel, 50 Ohms
Product Name	SMP
Style	PCB
Type	Subminiature
UPC	800756618869

Electrical

Frequency	40 GHz
Impedance	50Ω
Power / Voltage	VOLTAGE: 335 Vrms@Sea Level

Physical

Cable Attachment	N/A
Gender	Plug
Keying to Mating Part	N/A
Net Weight	0.743/g
Orientation	Straight

Packaging Type	Embossed Tape on Reel
Panel Mount	No
Panel Mount Method	N/A
PCB Mounting	Surface Mount
PCB Thickness - Recommended	Various
Reverse Polar	No
Wire/Cable Type	N/A

Solder Process Data

Max-Duration	10
Lead-Free Process Capability	REFLOW
Max-Cycle	2
Max-Temp	260