**PBS15-XL**

Plummer block housing unit

Plummer block housing units PBS, sheet steel housing, radial insert ball bearing with eccentric locking collar, P seals

X-life

Technical information

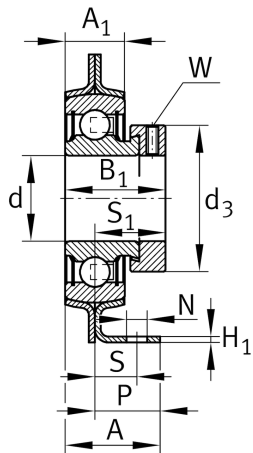
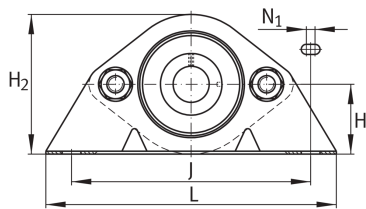

Your current product variant

Material	Steel sheet
----------	-------------

Main Dimensions & Performance Data

d	15 mm	Bore diameter
H ₂	59.6 mm	Height
L	123.8 mm	Length total
C _{0r} G	2,700 N	Load carrying capacity (housing)
≈m	0.32 kg	Weight

Mounting dimensions

J	92 mm	Distance fixing bore
N	10.5 mm	Width (slot)
N ₁	5.6 mm	Distance slot center
S	15 mm	Distance fixing

Dimensions

H	30.2 mm	Distance shaft axis
A	32.5 mm	Width (base)
A ₁	14.2 mm	Width (head)
H ₁	2.6 mm	Height (base)
P	25.4 mm	Distance support



Additional information

GEH40-PBS	Housing
RAE15-XL-NPP-B	Bearing designation

Temperature range

T _{min}	-20 °C	Operating temperature min.
T _{max}	120 °C	Operating temperature max.