

Data sheet Indicator 22 mm.

Part No.: 82-6551.0113

Technical data



| | |
|-----------------------|--|
| Terminal | Soldering terminal, 0.5 x 2.8 mm |
| Shape of illumination | Ring |
| Operating voltage | 12 V AC/DC |
| Lens illumination | illuminative |
| Lens colour | Nature |
| Lens shape | flush |
| Lens material | Aluminium |
| Lens surface | anodised |
| Lens optics | opaque |
| Front bezel shape | flush |
| Front bezel material | Aluminium |
| Weight | 0.018 kg |
| Illumination colour | Red |
| Kind of illumination | Single-LED |
| Operating temperature | - 30 °C ... + 70 °C |
| Approbations | CB, CCC, C UL, UL |
| Climate resistance | Damp heat, 21 days according to IEC 60512-11 |

Dimensions

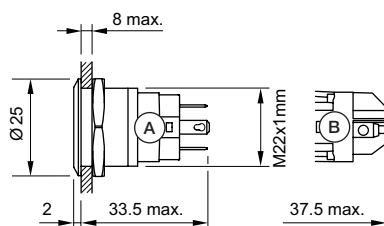

A = Solder terminal
B = Screw terminal

Mounting cut-outs

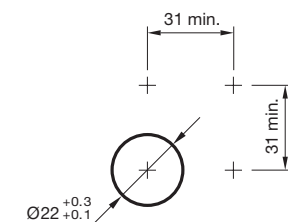

Wiring diagrams

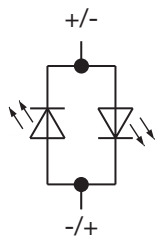

Component layouts

