

3/2 AIR PILOT/SPRING VALVE 1/8 PORT SERIES VTA301

- ✓ Compact design
- ✓ Flow rate 0.18CV
- ✓ Poppet type
- ✓ Multifunctions

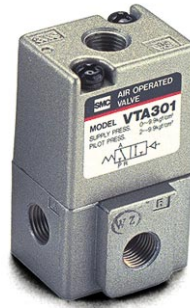

Valves

TECHNICAL SPECIFICATIONS VTA301

Operating Pressure	Vacuum to 10 Bar
Temperature range	0-50°C
Effective orifice (CV)	3.2mm ² (0.18)
Pilot pressure	2 to 10 Bar

1 VALVE 6 FUNCTIONS

(UNIVERSAL PORTING)

Selective porting can provide up to 6 valve functions

Valve function	3-way normally closed	3-way normally open	2-way normally closed
De-energized			
Energized			

Valve function	2-way normally open	Selector	Diverter
De-energized			
Energized			

SYMBOLS

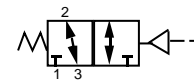

HOW TO ORDER SERIES VTA301

VTA301 - 01

STOCKED PRODUCTS
FOR A LIST OF STOCKED PRODUCTS,
PLEASE SEE THE CURRENT SMC PRICE LIST

DIMENSIONS SERIES VTA301

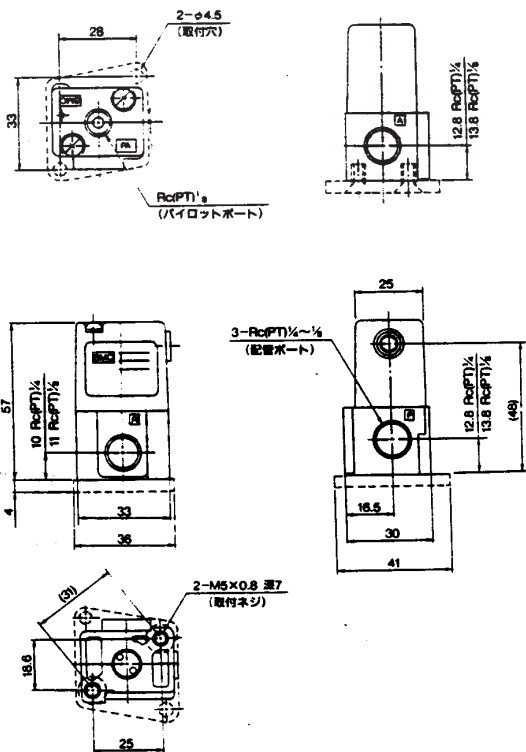

ACCESSORIES VTA301

DXT060-27AFoot bracket

STOCKED PRODUCTS
FOR A LIST OF STOCKED PRODUCTS,
PLEASE SEE THE CURRENT SMC PRICE LIST