

DC Connector, Plug, 5.5x2.5 mm, 2-pole, solder terminal, lockable



### Description

- Solder terminal:  
for cable mounting
- Low Voltage DC Plug and Socket
- DC Plug: 2-pole, straight

### Weblinks

[pdf-datasheet](#), [html-datasheet](#), [General Product Information](#), [RoHS](#), [CHINA-RoHS](#), [REACH](#), [Mating Connectors](#), [e-Shop](#), [SCHURTER-Stock-Check](#), [Distributor-Stock-Check](#)

### Technical Data

Diameter	5.5 mm / 2.5 mm	Allowable Operation Temp.	-20 °C to 70 °C
Number of Poles	2-pole	Terminal	solder terminal nickel-plated
Ratings DC	0.5 A / 12 VDC		lockable
Dielectric Strength	500 VDC	Style	straight
Insulation Resistance	> 100 MΩ @ 500 VDC	Lifetime	5000 Insertions

### Dimensions

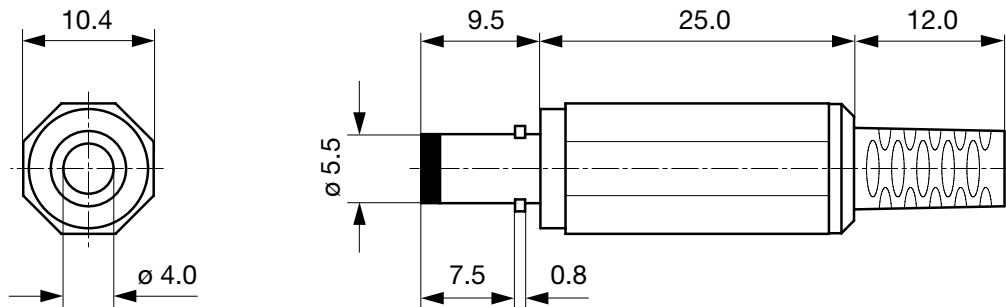

Cable diameter max. 4.0 mm

### All Variants

Product group	Diameter [mm]	Number of Poles	Terminal	Order Number
DC Plug/Socket	5.5	2-pole	solder terminal	4840.1211

Availability for all products can be searched real-time: <http://www.schurter.com/en/Stock-Check/Stock-Check-SCHURTER>

**Packaging unit** 100 Pcs

## Mating Outlets/Connectors

## Category / Description

[DC Plug/Socket Overview complete](#)

DC Connector, Socket, 5.7 mm, 2.35 mm, 2-pole, solder terminals for PCB, lockable

4840.2212

[DC Plug/Socket further types to 4840 DC-Stecker, verschiedene](#)