

Rectangular Type

DC

3-wire

Basic series
1,5 mm embeddable

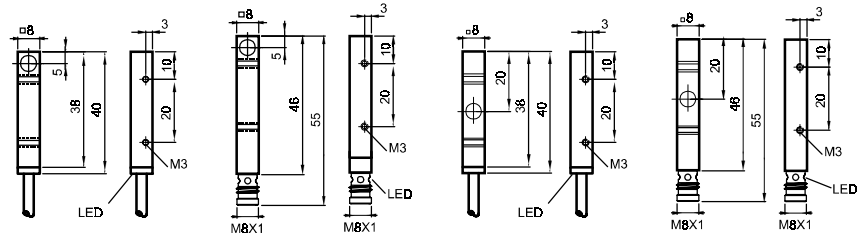

Operating dist. s_n , mounting		1,5 mm, embeddable	1,5 mm, embeddable	1,5 mm, embeddable	1,5 mm, embeddable
PNP	Make function	NBB1,5-F41-E2	NBB1,5-F41-E2-V3	NBB1,5-F41A-E2	NBB1,5-F41A-E2-V3
	Break function	NBB1,5-F41-E3	NBB1,5-F41-E3-V3	NBB1,5-F41A-E3	NBB1,5-F41A-E3-V3
NPN	Make function				
	Break function				
Assured operat. dist. s_a [mm]		0 ...1,215	0 ...1,215	0 ...1,215	0 ...1,215
Reduction factor	r_{V2A}	0,75	0,75	0,75	0,75
	r_{AI}	0,45	0,45	0,45	0,45
	r_{Cu}	0,35	0,35	0,35	0,35
Operating voltage U_B [V]		10 ...30	10 ...30	10 ...30	10 ...30
Operational current I_L [mA]		100	100	100	100
Switching frequency [Hz]		1500	1500	1500	1500
No-load supply current [mA]		15	15	15	15
Voltage drop [V]		3	3	3	3
Short circuit protection		pulsing	pulsing	pulsing	pulsing
Reverse polarity protection		yes	yes	yes	yes
Output indicator		LED, yellow	LED, yellow	LED, yellow	LED, yellow
Operating temperature [°C]		-25 ...70	-25 ...70	-25 ...70	-25 ...70
In compliance with		EN60947-5-2	EN60947-5-2	EN60947-5-2	EN60947-5-2
Protection to IEC 60529		IP 67	IP 67	IP 67	IP 67
Connection		2 m, PVC-cable	V3- connector	2 m, PVC-cable	V3- connector
Conductor cross section		0,14 mm ²	-	0,14 mm ²	-
Housing material		Nickel plated brass	Nickel plated brass	Nickel plated brass	Nickel plated brass
Sensing face		PBT	PBT	PBT	PBT

Standard symbol / connection:

