

KEMET, SS, Proximity, SMD, Pyroelectric Infrared, Detection Up To 5 Meters

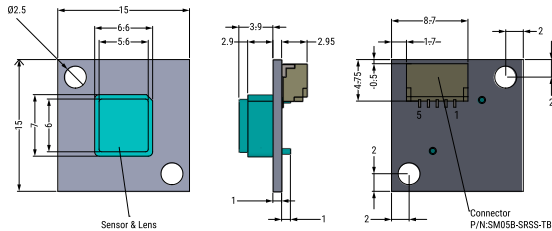

General Information	
Series:	SS
Type:	Proximity
Style:	SMD
Description:	Sensor Module with Lens
Features:	Detection Up To 5 Meters
RoHS:	Yes
Qualifications:	REACH

Dimensions	
L	15mm NOM
W	15mm NOM

Packaging Specifications	
Packaging:	Tray, Box
Packaging Quantity:	200
Weight:	800 mg

Specifications	
Temperature Range:	-40/+70°C
Voltage DC:	3 VDC (Output, Detection), 0.0 VDC (Output, Non-Detection), 3.5 - 5.5 (Supply Voltage)
Current:	800 uA MAX (Consumption)
Miscellaneous:	Field of View: Horizontal +/- 37 degree, Vertical +/-28 degrees. Detection Output Voltage: 0.2 Seconds. Warm Up Time: 30 Sec (MAX)