

Large friction hinges - adjustable

Model : 72-1-4148



Large size friction hinge to maintain a lid / door in position.

The friction torque is adjustable with a hex key.

Available with a choice of studs or holes.

3 other versions available: with spring, with detent function or free swinging.

A full product data sheet is available on our website.

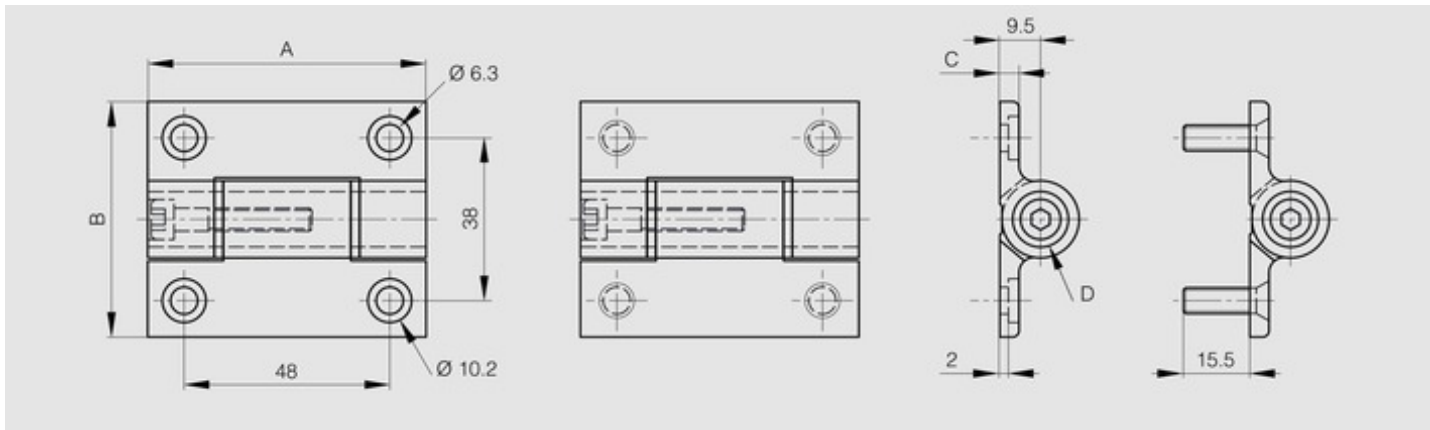

| | |
|------------------|--------------------|
| Material | 6060 T5 alu |
| Finish | black anodised |
| A (length) | 65 |
| D (pin diameter) | 13 |
| B (width) | 55 |
| C | 4.5 |
| Weight (g) | 78 |
| Opening angle | 225 |
| Note | fixing by M6 studs |
| Material | aluminium |
| Functions | friction hinges |
| Torque | 0 - 5 N.m |