

SYMBOL DEFINITION		TOTAL NO OF INSPECTIONS REQUIRED	
A DIMENSION WITHOUT AN INSPECTION REPORT SYMBOL DOES NOT REQUIRE INSPECTION. IT MAY BE CONTROLLED ON THE INDIVIDUAL COMPONENT DRAWING.		22	
	LAST NO. USED	19	

MISSING SYMBOLS		DWS STATUS		REVISION HISTORY		AUTH	
DATE	STG	REV	N/P	CHG	ZONE	DATE	BY
31JUL02	R	05	-	-	-	CLEARED REV COLUMN; RELEASED 15443663	228344 CJP
170C02	R	06	-	-	-	ALL PARTS - UPDATED PDM ATTRIBUTES	227307 EVV
25FEO3	R	07	-	-	-	15443663 - OBSOLETE	237063 MAC
16AP03	R	08	-	-	-	ALL PARTS - ADDED APPLICATION, TYPICAL CABLE SEAL AND TYPICAL SEALING CAVITY CONFIG TO CHART	239445 TLD
20JL03	R	09	-	-	-	15326268, 15326269, 15355563, AND 15373413 - ADDED TERMINAL MAKE STRAIGHTNESS AND TERMINAL CRIMP STRAIGHTNESS VIEWS.	242518 BRB
01MR04	R	10	-	-	-	15373413 - UPDATED PDM ATTRIBUTES	252269 EES
040C04	R	11	-	-	-	15326268 - 69, 15355563 & 15373413 - ADDED STAMP DIE I.D	259308 OPS
22SE08	R	12	-	-	-	13722265 & 13722267 - RELEASED	406110 JOA
01DE08	R	13	-	-	-	15326268, 15326269, 15355563, 15373413 - UPDATED MATERIAL CALLOUT	406833 MH
18MR09	R	14	-	-	-	13722265 & 13722267 - UPDATED PDM ATTRIBUTES	407578 LVR
160C09	R	15	-	-	-	13722265 & 13722267 - ADDED LABEL OF SILVER PLATING ZONE	409243 FKV
29MR10	R	16	-	-	-	ALL ACTIVE PARTS - UPDATED PDM ATTRIBUTES	410409 FRE
16AU10	R	17	-	-	-	ALL ACTIVE PARTS - ADDED PLATING NOTE, UPDATED MAT'L CALLOUT AND ADDED CONTACT AREA & CRIMP AREA COLUMNS ON CHART	411632 JRL
060C10	R	18	-	-	-	ALL ACTIVE PARTS - UPDATED PLATING NOTES	412129 CBG
23AU11	R	19	-	-	-	ALL ACTIVE PARTS - ALTERNATIVE MAT'L SIZE WAS MAT'L SIZE AND ADDED PREFERRED MAT'L SIZE COLUMN	415183 AGM
28SE11	R	20	-	-	-	13722265-67 - ALTERNATIVE MAT'L SIZE WAS 0.3 X 35.75 AND PREFERRED MAT'L SIZE WAS EMPTY	415603 BLG

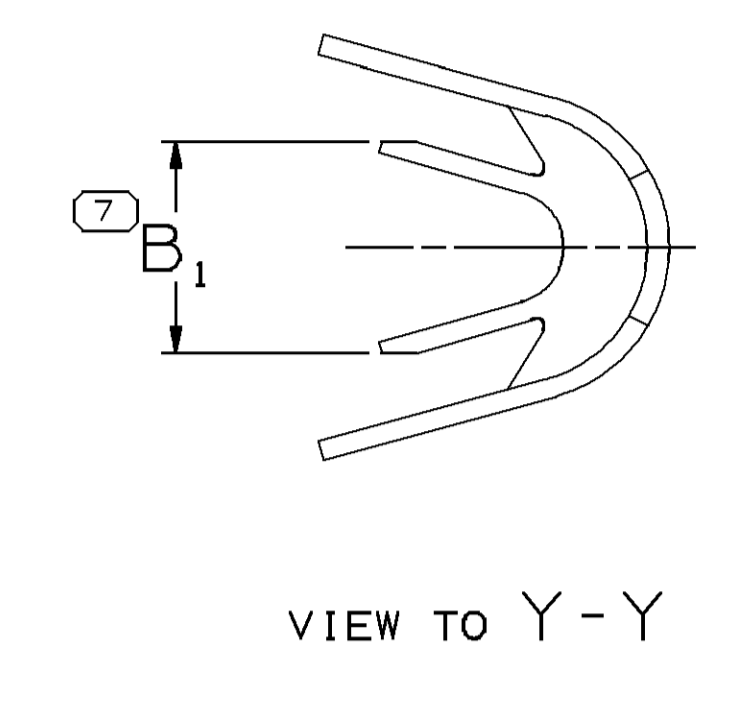

19 SILVER PLATING 8.19 TO 12.13 FOR 13722265 AND 13722267

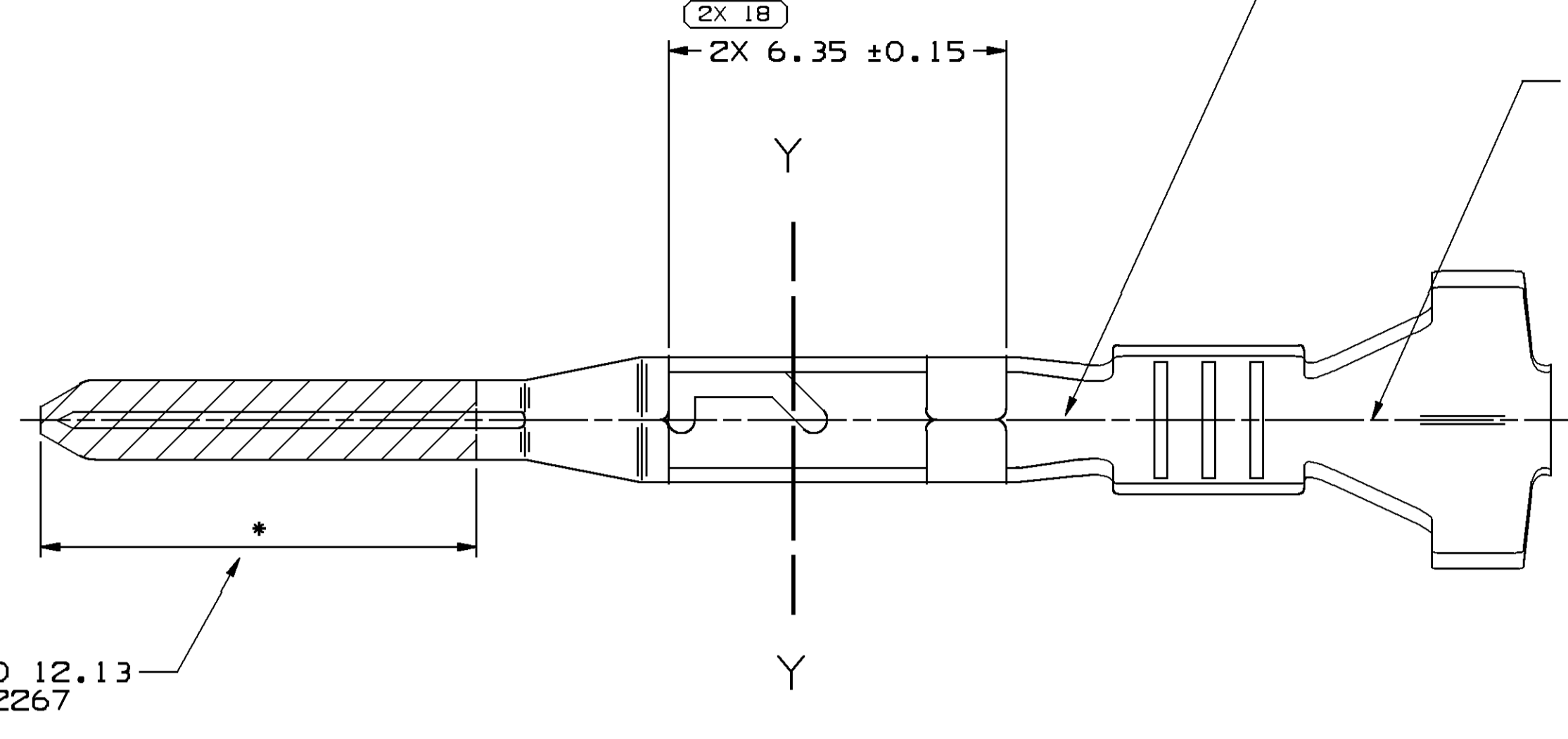
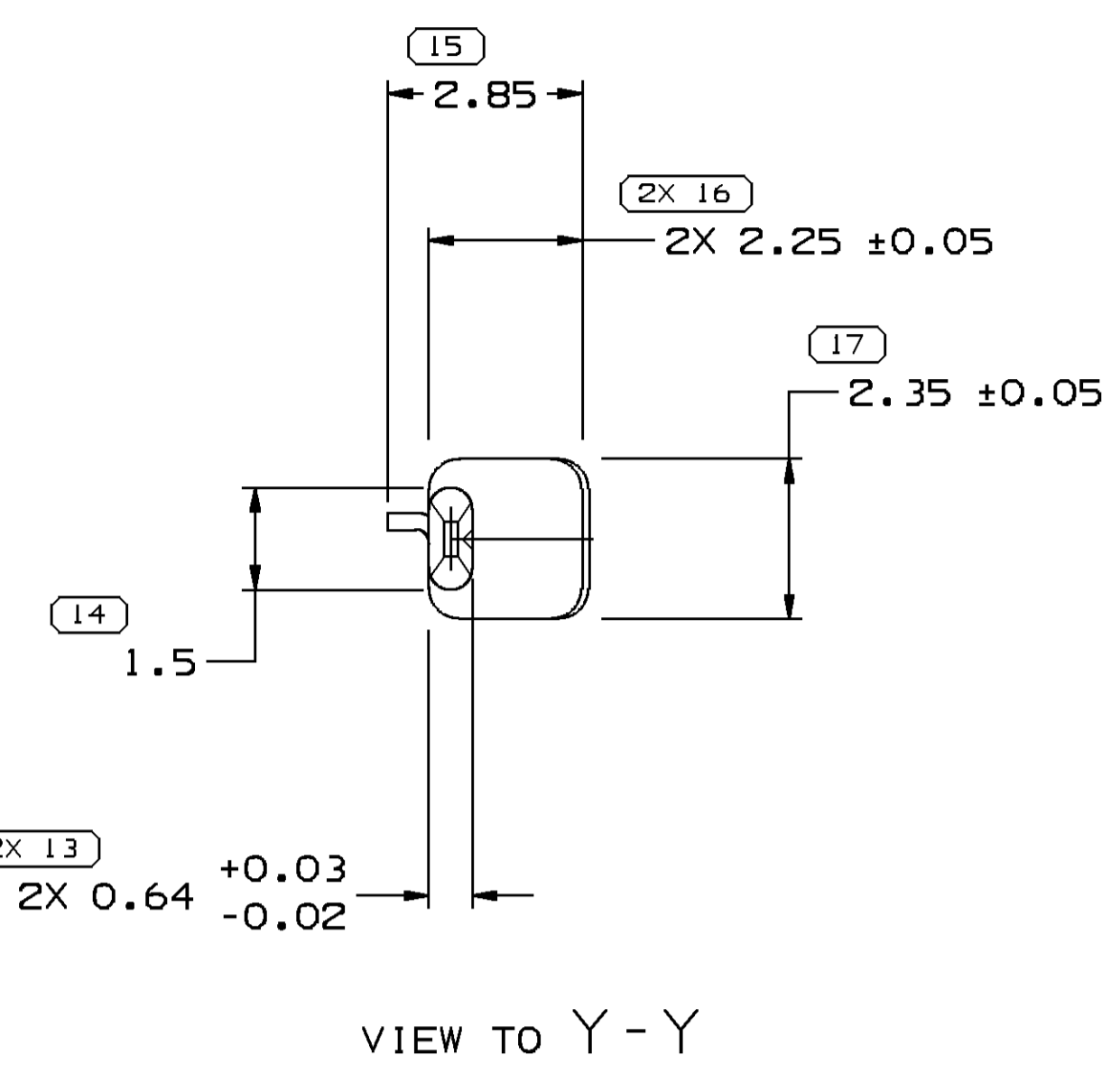
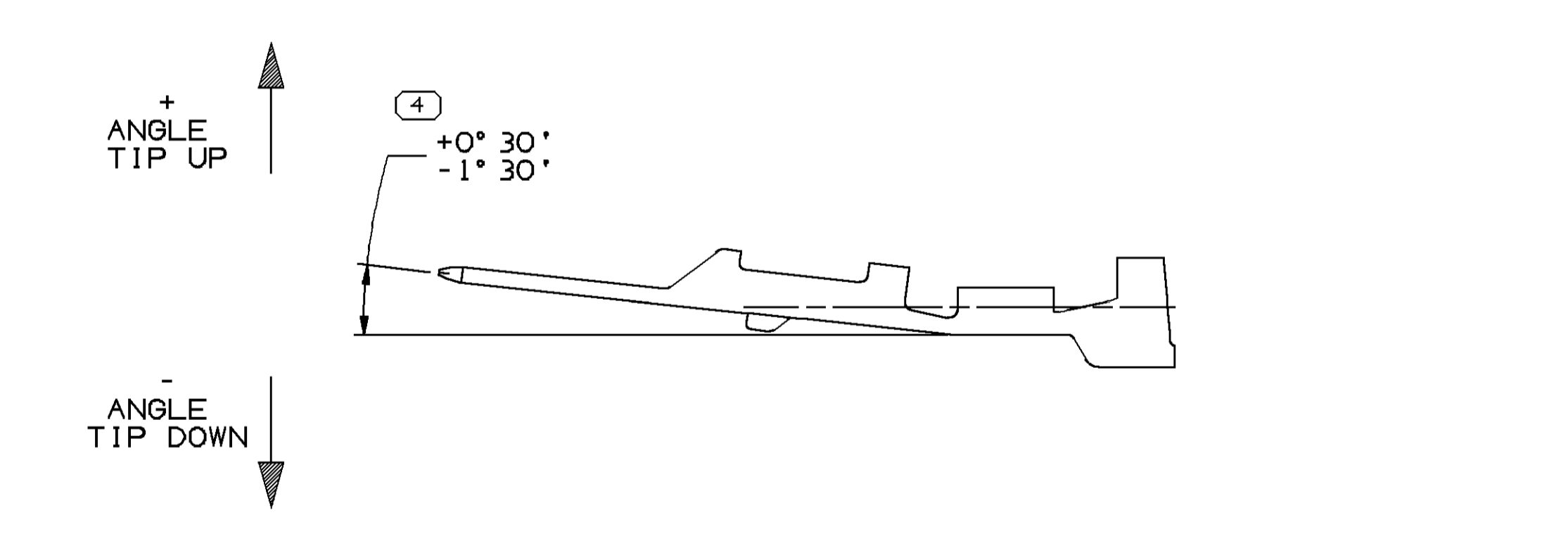
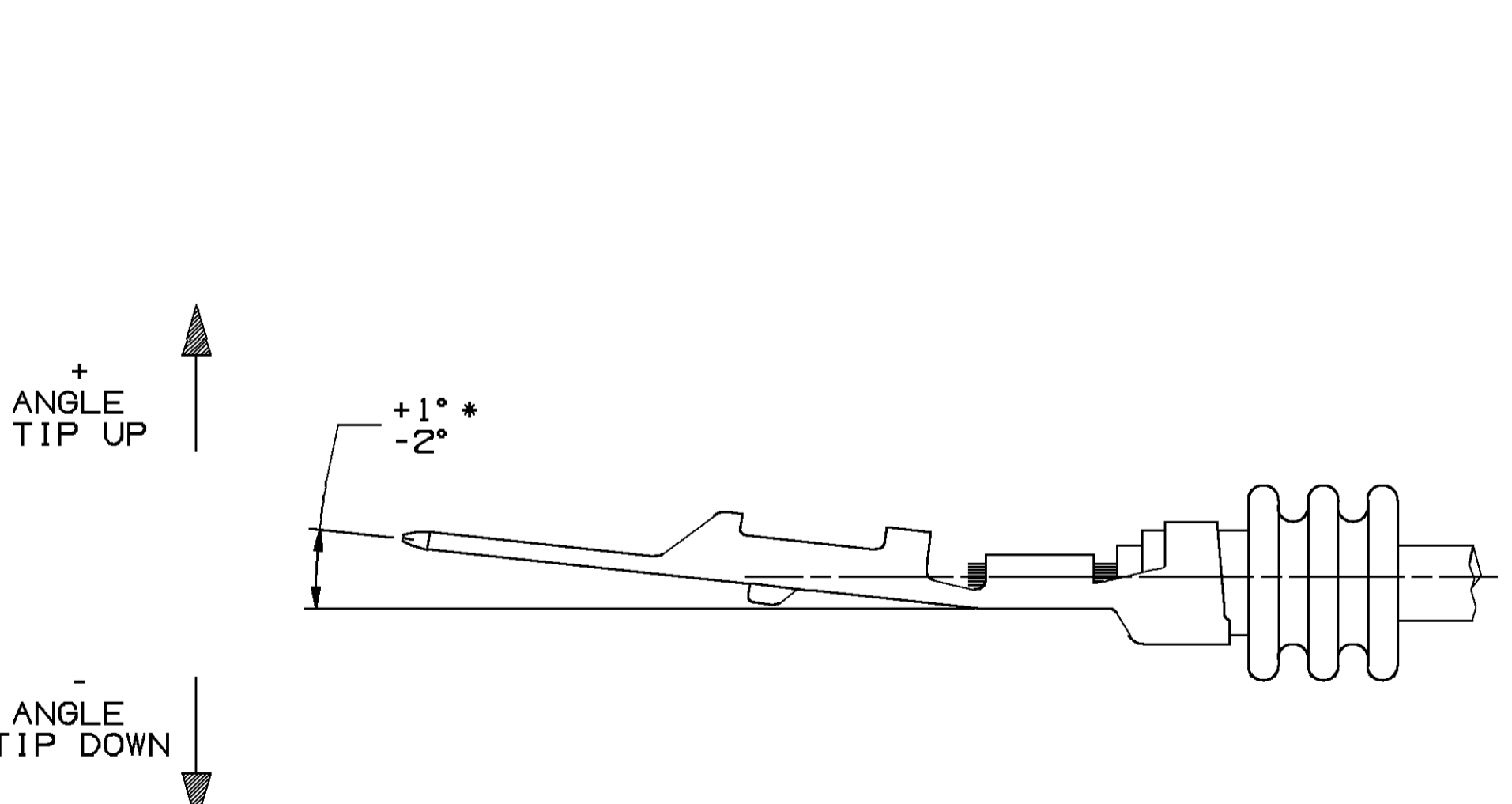
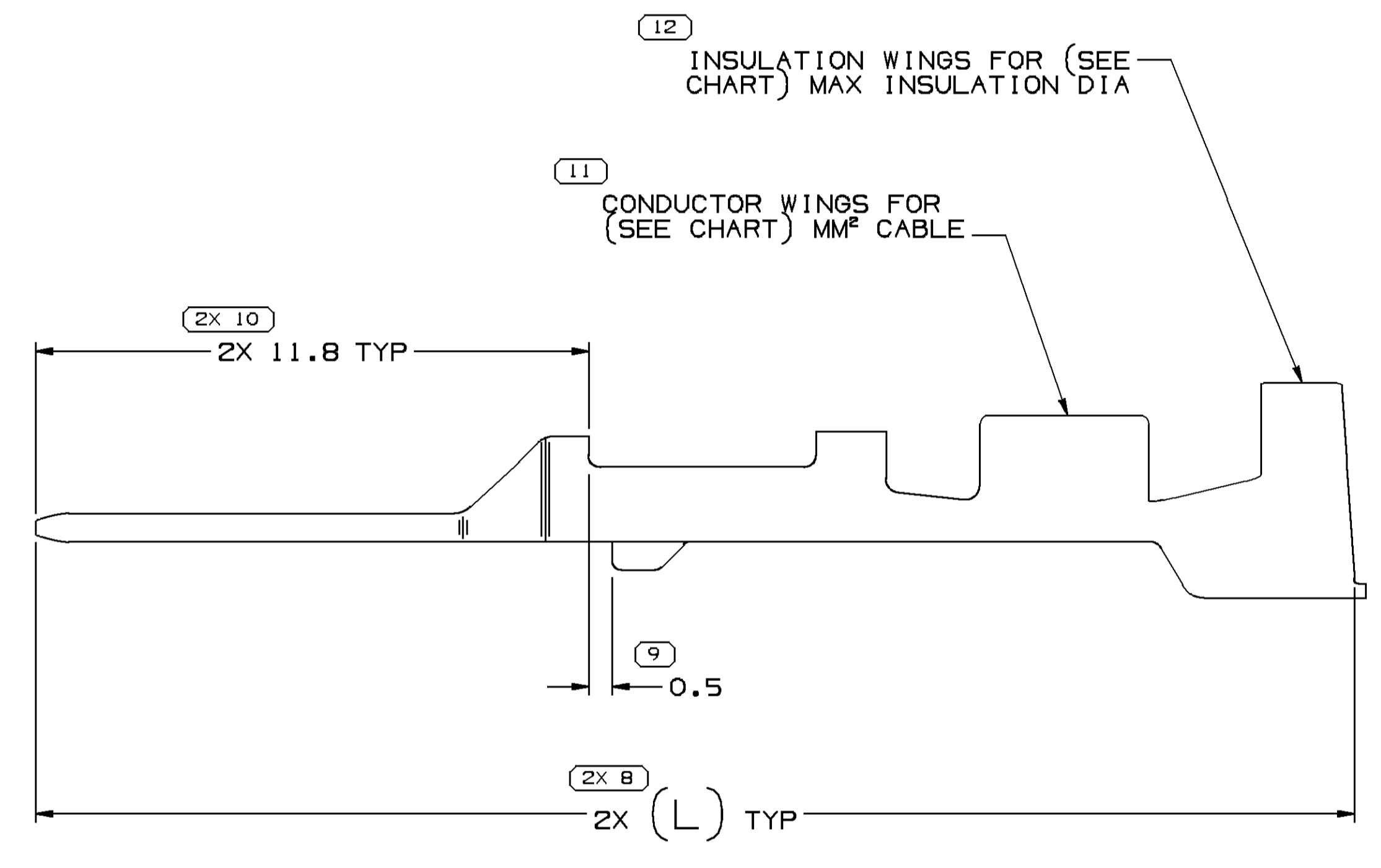
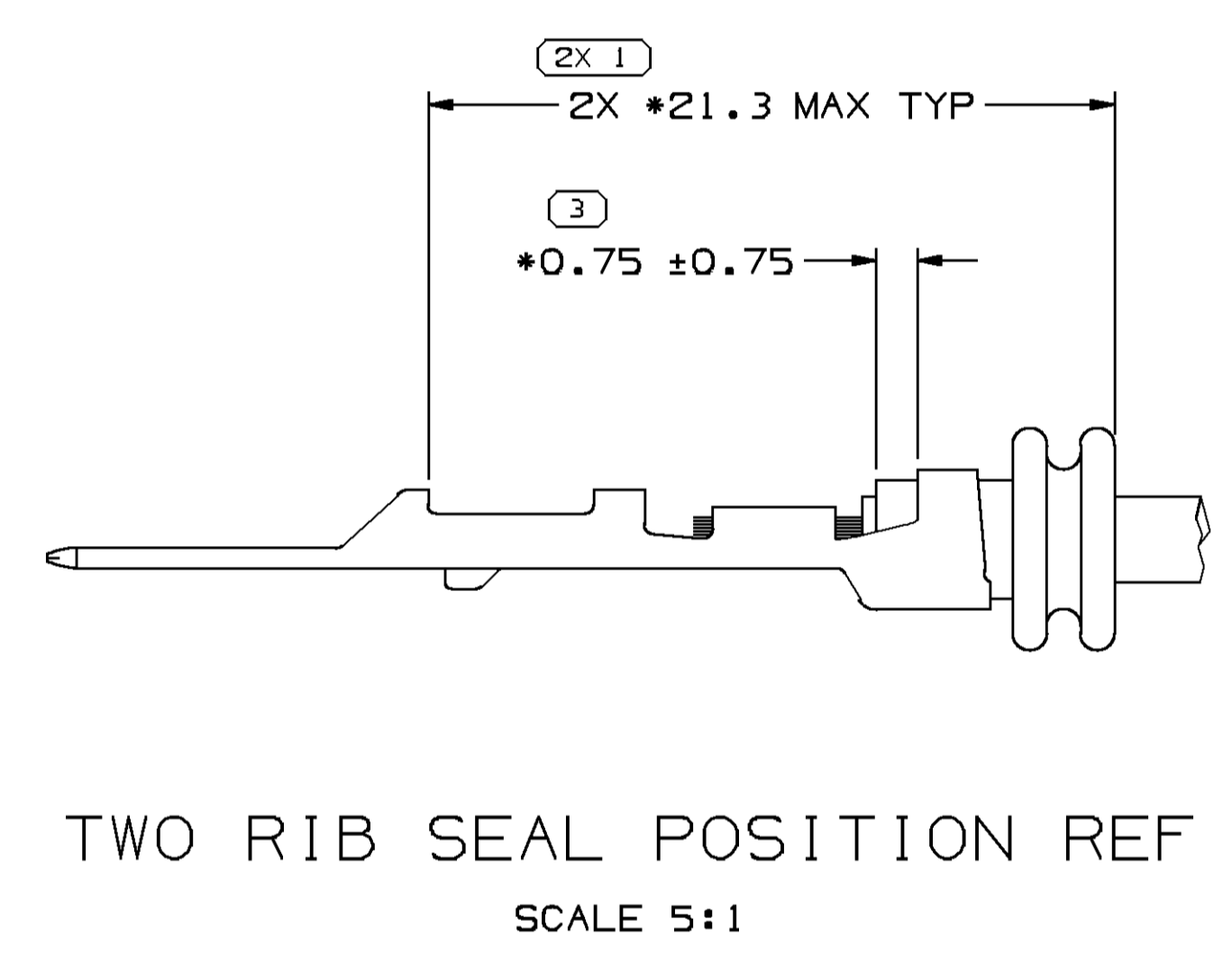

TERMINAL, SEAL AND CABLE ALIGNMENT MEASURED FROM BOTTOM OF CORE CRIMP. SCALE 5:1

TERMINAL ALIGNMENT (TERMINAL MAKE) MEASURED FROM BOTTOM OF CORE WING. SCALE 5:1

- NOTES
- UNLESS OTHERWISE SPECIFIED AND/OR INDICATED: DIMENSIONS ARE TO FACE OF VIEW SHOWN AND AUTOMATICALLY ROUNDED BY COMPUTER FOR INSPECTION (SEE MATH MODEL FOR PRECISE DIMENSIONS). FOR ALL OTHER DIMENSIONS NOT SHOWN BUT REQUIRED FOR TOOL BUILD, SEE MATH MODEL FOR PRECISE TOOL PATH DATA.
  - REFERENCE MATING COMPONENTS OR EQUIVALENT: TERMINAL 12191818
  - \* DENOTES DIMENSIONS MADE AT CUT OFF AND CRIMP DIE.
  - PLATING TYPE:
    - REFLOW TIN 1.9-3.3 MICROMETERS THICK WITH A COPPER UNDERPLATE 0.5 MICROMETER TO 1.0 MICROMETER THICK.
    - SILVER 3.5-6.0 MICROMETERS THICK OVER 0.13-0.25 MICROMETERS THICK NICKEL UNDERPLATE.
    - MATE TIN ELECTROPLATE 1.9-7.0 MICROMETERS THICK WITH A NICKEL UNDERPLATE 0.13-0.25 MICROMETERS THICK.
- PLATING TYPE INFORMATION SHOWN ABOVE IS REFERENCE ONLY. PLATING REQUIREMENTS ARE CONTAINED IN APPLICABLE MATERIAL SPECIFICATION.

PART NO	REV	N/P	STATUS	PREFERRED MAT'L SIZE	ALTERNATIVE MAT'L SIZE	MAT'L DESCRIPTION	SIZE (MM²)	ID	DIA	TYPE	B <sub>1±0.2</sub>	(L)	APPLICATION	TYPICAL CABLE SEAL	TYPICAL SEALING CAVITY CONFIGURATION	CONTACT AREA PLATING TYPE	CRIMP AREA PLATING TYPE
13722267	01	AG	-	0.3 X 35.75	-	COPPER ALLOY	0.35 - 0.5	21	1.85 - 1.2±0.15	201	2.1	28.15	SEALED (GT)	12191226 OR EQUIVALENT	Ø 4 ROUND	11	111
13722265	01	AG	-	0.3 X 35.75	-	COPPER ALLOY	0.75 - 1	17	2.25 - 1.7±0.15	201	2.65	28.15	SEALED (GT)	12191227 OR EQUIVALENT	Ø 4 ROUND	11	111
15443663	01	AC	OBSOLETE	-	-	-	0.75 - 0.8	19	2.02 - 1.7	201	2.65	28.15	SEALED (MINI)	15305351 OR EQUIVALENT	3.2 X 4 OVAL	-	-
15373413	01	AM	-	0.3 X 35.75	0.3 X 36.12	COPPER ALLOY	0.75 - 0.8	18	2.02 - 1.7	201	2.65	28.15	SEALED (MINI)	15305351 OR EQUIVALENT	3.2 X 4 OVAL	1	1
15355563	01	AL	-	0.3 X 35.75	0.3 X 36.12	COPPER ALLOY	0.35 - 0.5	21	1.85 - 1.2	201	2.1	28.15	SEALED (MINI)	12191229 OR EQUIVALENT	3.2 X 4 OVAL	1	1
15326269	02	AK	-	0.3 X 35.75	0.3 X 36.12	COPPER ALLOY	0.75 - 1	17	2.25 - 1.7±0.15	201	2.65	28.15	SEALED (GT)	12191227 OR EQUIVALENT	Ø 4 ROUND	1	1
15326268	02	AK	-	0.3 X 35.75	0.3 X 36.12	COPPER ALLOY	0.35 - 0.5	21	1.85 - 1.2±0.15	201	2.1	28.15	SEALED (GT)	12191226 OR EQUIVALENT	Ø 4 ROUND	1	1

DIMENSIONAL RANGE (MM)		CHART ID
FROM	0	> 12
TO	12	1

TOLERANCE UNLESS OTHERWISE SPECIFIED	
Ø	±0.2
ANGULAR TOLERANCE	±2°

THIRD ANGLE PROJECTION	DO NOT SCALE

**DELPHI**  
DELPHI PACKARD ELECTRICAL/ELECTRONIC ARCHITECTURE  
WARREN, OH

OR DATE

APV01 H. CASTRILLON 18AP97  
APV02 PEDRO YABUR 24AP97  
APV03 S.C. HSIEH 12MY97  
APV04

SUBSTANCES OF CONCERN AND RECYCLED CONTENT PER DELPHI (0949901)

MATERIAL SEE CHART

DRAWING NAME  
TAXI TERM M GT 150 SEALED

DRAWING NUMBER  
15304703

SIZE A0 SCALE 10:1 FRAME NO 1 OF 1 SHEET NO 2 OF 2 STG REV N/P R 20 -