**PBS30-XL**

Plummer block housing unit

Plummer block housing units PBS, sheet steel housing, radial insert ball bearing with eccentric locking collar, P seals

X-life

Technical information

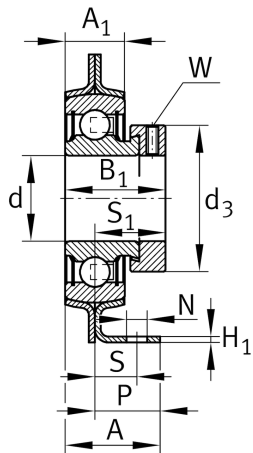
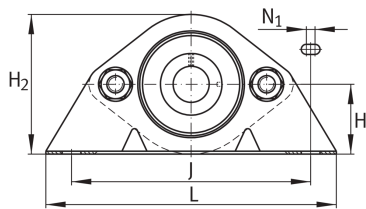

Your current product variant

| | |
|----------|-------------|
| Material | Steel sheet |
|----------|-------------|

Main Dimensions & Performance Data

| | | |
|-------------------|---------|----------------------------------|
| d | 30 mm | Bore diameter |
| H ₂ | 85 mm | Height |
| L | 159 mm | Length total |
| C _{0r} G | 3,600 N | Load carrying capacity (housing) |
| ≈m | 0.79 kg | Weight |

Mounting dimensions

| | | |
|----------------|---------|----------------------|
| J | 119 mm | Distance fixing bore |
| N | 13.5 mm | Width (slot) |
| N ₁ | 8 mm | Distance slot center |
| S | 16 mm | Distance fixing |

Dimensions

| | | |
|----------------|---------|---------------------|
| H | 42.9 mm | Distance shaft axis |
| A | 38.9 mm | Width (base) |
| A ₁ | 17.4 mm | Width (head) |
| H ₁ | 3.4 mm | Height (base) |
| P | 30.2 mm | Distance support |



Additional information

| | |
|----------------|---------------------|
| GEH62-PBS | Housing |
| RAE30-XL-NPP-B | Bearing designation |

Temperature range

| | | |
|------------------|--------|----------------------------|
| T _{min} | -20 °C | Operating temperature min. |
| T _{max} | 120 °C | Operating temperature max. |