

Product Datasheet

RS Bobbin Mount – Type B



Their elasticity is much greater in all the directions parallel to the armatures than in the perpendicular direction. The rubber works based on compression or shear depending on the direction it is placed in at installation time. This direction is made according to the use and the objective.

It is therefore installed with nuts or screws depending on the model chosen, with one part attached to the fixed chassis and the other to the machine to be suspended.

The AMC Mecanocaucho® bobbins are particularly suitable for installation on small motor-pumps, motor-ventilators, driers, sieves, compactors, washing machines, electrical motors, on-board control panels, measuring apparatuses, control cabinets, microphones, fluorescent tubes, etc.

Technical data

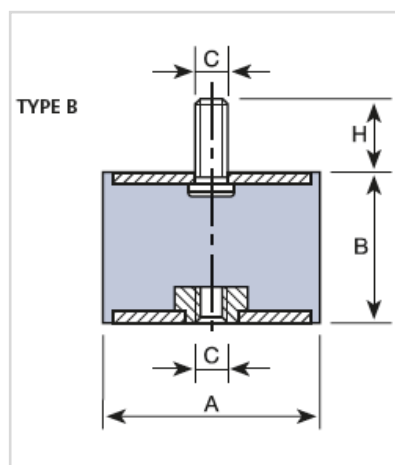

RS Ref:	AMC Ref:	A	B	C	H	COMPRESSION		SHEAR	
						LOAD max. daN	DEFLECT. mm	LOAD max. daN	DEFLECT. mm
8112378	121012	16	15	M-5	12	20	3	2,5	2
8112390	121022	20	15	M-6	16,5	35	2,5	5	2,5
8112454	121023	20	20	M-6	16,5	30	4,5	5	3,5
8112463	121172	25,5	15	M-6	18	60	2,5	8	2,5
8112460	121034	25,5	25	M-8	20	50	5	8	4,5
8112476	121036	25,5	40	M-8	20	50	10	10	6
8112489	121041	30	15	M-8	20	90	3	11	2,5
8112479	121042	30	22	M-8	20	80	4,5	11	4
8112592	121199	40	45	M-8	20	120	11	9	20
8112473	121051	40	20	M-10	25	160	4	3	20
8112498	121063	50	45	M-10	25	190	11	25	9
8112485	121072	60	36	M-10	25	300	8	30	7
8112482	121073	60	45	M-10	25	250	10	30	9
8112491	121082	70	50	M-10	25	350	10	35	11