

**FAG****6003-2RSR-C3**

Deep groove ball bearing

Deep groove ball bearing 60...-2RSR, single row, seals, steel sheet metal cage

## Technical information

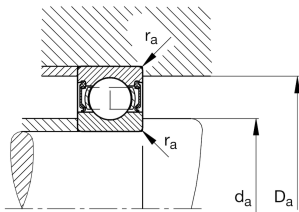
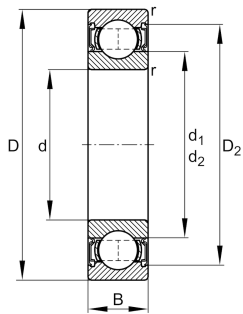

## Your current product variant

Sealing	2RSR	Contact seal on both sides
Cage	JN	Steel sheet metal
Tolerance class	PN	Normal (PN)
Dimensional / heat stabilization	SN	Rings dimensional stabilized up to 120°
Lubricant	GA14	Ball bearing grease, low noise
Radial internal clearance	C3 (Group 3)	Internal clearance larger than CN
Bore type	Z	Cylindrical

## Main Dimensions &amp; Performance Data

d	17 mm	Bore diameter
D	35 mm	Outside diameter
B	10 mm	Width
C <sub>r</sub>	6,400 N	Basic dynamic load rating, radial
C <sub>0r</sub>	3,250 N	Basic static load rating, radial
C <sub>ur</sub>	162 N	Fatigue load limit, radial
n <sub>G</sub>	11,800 1/min	Limiting speed
≈m	39.5 g	Weight

## Mounting dimensions

d <sub>a min</sub>	19 mm	Minimum diameter shaft shoulder
D <sub>a max</sub>	33 mm	Maximum diameter of housing shoulder
r <sub>a max</sub>	0.3 mm	Maximum fillet radius



Dimensions

$r_{min}$	0.3 mm	Minimum chamfer dimension
$D_1$	29.51 mm	Shoulder diameter outer ring
$D_2$	30.81 mm	Caliber diameter outer ring
$d_1$	22.65 mm	Shoulder diameter inner ring





Temperature range

$T_{min}$	-20 °C	Operating temperature min.
$T_{max}$	100 °C	Operating temperature max.

Calculation factors

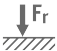
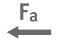
$f_0$	14.3	Calculation factor
-------	------	--------------------

Characteristics

-  Radial load
-  Axial load in one direction
-  Axial load in two directions
-  Lifetime lubrication, freedom from maintenance
-  Grease Lubrication
-  Sealed on both sides