



RTUE60-XL

Take-up housing unit

Take-up housing units RTUE, cast iron housing, radial insert ball bearing with eccentric locking collar, R seals

X-life

Technical information

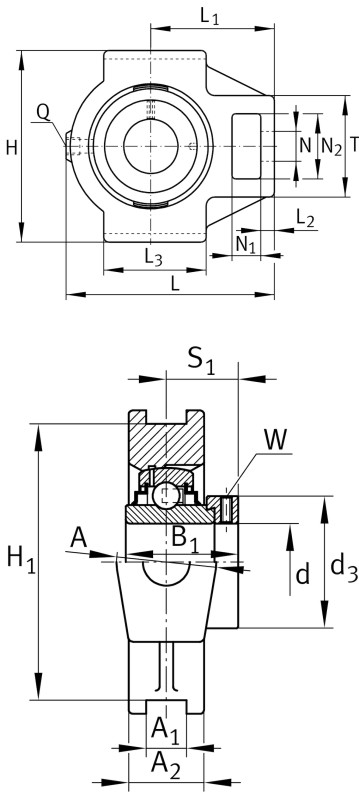

Your current product variant

Material	GG	Grey cast iron
----------	----	----------------

Main Dimensions & Performance Data

d	60 mm	Bore diameter
---	-------	---------------

H	146 mm	Height
---	--------	--------

L	186 mm	Length total
---	--------	--------------

B 1	77.9 mm	Locking collar total width
-----	---------	----------------------------

≈m	4.74 kg	Weight
----	---------	--------

Mounting dimensions

A 1	22 mm	Width guidance groove
-----	-------	-----------------------

H13		Width guidance groove clearance
-----	--	---------------------------------

H 1	130 mm	Distance guidance grooves
-----	--------	---------------------------

0.15 mm		Upper distance guidance groove tolerance
---------	--	--

-0.15 mm		Lower distance guidance groove tolerance
----------	--	--

N	35 mm	Fixing bore
---	-------	-------------



Dimensions

L ₁	118 mm	Distance shaft axis
L ₂	19 mm	Length fixed link
L ₃	100 mm	Length guidance groove
A	60 mm	Width housing fixing side
N ₁	32 mm	Width recess
N ₂	63.5 mm	Height recess
S ₁	46.9 mm	Distance of raceway to locking collar
T	102 mm	Height housing fixing side
Q	M6	Connection thread for lubrication
A ₂	44 mm	Width housing

Additional information

TUE12	Housing
GE60-XL-KRR-B	Bearing designation

Temperature range

T _{min}	-20 °C	Operating temperature min.
T _{max}	120 °C	Operating temperature max.