



FAG

6216-J20AA-C3 [🔗](#)

Deep groove ball bearing

Deep groove ball bearing 62...J20AA, single row, steel sheet metal cage, ceramic coated

Technical information

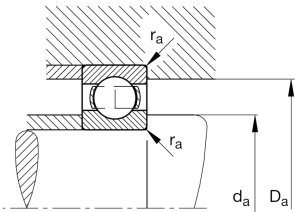
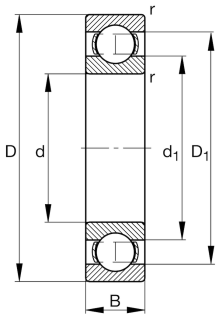

Your current product variant

Sealing	Without	Not sealed
Cage	JN	Steel sheet metal
Tolerance class	PN	Normal (PN)
Dimensional / heat stabilization	S0	Rings dimensional stabilized up to 150°
Lubricant	Without	Bearing not greased
Radial internal clearance	C3 (Group 3)	Internal clearance larger than CN
Coating	J20AA	current insulation, outer ring ceramic coated
Bore type	Z	Cylindrical

Main Dimensions & Performance Data

d	80 mm	Bore diameter
D	140 mm	Outside diameter
B	26 mm	Width
C _r	77,000 N	Basic dynamic load rating, radial
C _{0r}	55,000 N	Basic static load rating, radial
C _{ur}	3,650 N	Fatigue load limit, radial
n _G	7,300 1/min	Limiting speed
n _{gr}	5,500 1/min	Reference speed
≈m	1.438 kg	Weight



Mounting dimensions

$d_{a\min}$	91 mm	Minimum diameter shaft shoulder
$D_{a\max}$	129 mm	Maximum diameter of housing shoulder
$r_{a\max}$	2 mm	Maximum fillet radius

Dimensions

r_{\min}	2 mm	Minimum chamfer dimension
D_1	121.8 mm	Shoulder diameter outer ring
d_1	98.84 mm	Shoulder diameter inner ring







Temperature range

T_{\min}	-30 °C	Operating temperature min.
T_{\max}	150 °C	Operating temperature max.

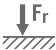
Calculation factors

f_0	15	Calculation factor
-------	----	--------------------

Characteristics

-  Radial load
-  Axial load in one direction
-  Axial load in two directions
-  Grease Lubrication
-  Oil Lubrication
-  Not sealed
-  Current insulated