

Datasheet

**Stock No:** [917-6361](#) , [917-6370](#) , [917-6373](#) , [917-6377](#) , [917-6386](#) ,  
[917-6389](#) , [917-6399](#) , [917-6395](#)

## RS Pro Logic Module and Accessories



### Specifications:

- Supports upto 48 I/Os (32 digital inputs & 16 Relay Outputs)
- 250 Lines of ladder programming
- 16 soft text messages, Time Switches, Compare Counters, Timers and Counters
- Daylight saving feature available
- Backlit LCD Screen for display & modification of pre-selected parameters of function blocks, viewing I/O status and programming of the device
- PC software for programming, online & offline simulation, documentations & printing
- Designed for use in automation and commercial & Industrial sectors

RS Stock No	917-6361	917-6370	
Parameters			
Supply Voltage	110-240 VAC	12-24 VDC	
Supply Variation	-20% to +10% of supply		
Frequency	50/60Hz		
Power Consumption	~5W		
Digital Inputs	8	6	
Analog Inputs	N/A	2 (Can be used as Digital Inputs)	
Digital Input range	(0-40VAC) OFF, (80-265VAC) ON	(0-4 VDC) OFF, (8-26.4 VDC) ON	
Analog Inputs Range	N/A	0 to 10 VDC	
Digital Output	Relay Output	4 SPNO	
	Contact Rating	8A @ 240 VAC / 5A @ 30 VDC (Resistive)	
	Electrical Life	10 <sup>5</sup>	
	Mechanical Life	10 <sup>7</sup>	
Utilization Category	AC-15	Rated Voltage (Ue): 120/240 V, Rated Current (Ie): 3.0/1.5 A	
	DC-13	Rated Voltage (Ue): 24/125/250 V, Rated Current (Ie): 2.0/0.22/0.1 A	
I/O Extensions (Max)	3		
Power Reserve (For Clock Only)	7 yrs. (at -10°C to 55°C)		
Modbus Communication	Yes (RTU)(Slave)		
DST	Settable		
Lines for ladder Programming	250		
Function Blocks	Timers	16 (on Delay, Interval, Cyclic ON-OFF, OFF Delay)	
	Counters	16 (up / down, retentive selectable)	
	Time Switches	16 (weekly / daily)	
	Compare Counters	16	
	Analog Functions	N/A	12
	Soft Text Messages	16 Priority driven	
	Auxiliary relays	64	
	Hour Meter	4	
Operating Temperature	-10°C To + 55°C		
Storage Temperature	-25°C To + 70°C		
Humidity (Non Condensing)	95% (Rh)		
Enclosure	Flame retardant UL 94-V0		
Dimension (W x H x D) (in mm)	72 X 90 X 65		
Weight (unpacked) Approx.	230g		
Mounting	Base / DIN Rail		
Degree of Protection	IP 20 for Terminals, IP 40 for Enclosure		
Certification	  		
<b>EMI / EMC</b>			
Harmonic Current Emissions	IEC 61000-3-2	Ed. 3.2 (2009-04) Class A	
ESD	IEC 61000-4-2	Ed. 2.0 (2008-12) Level II	
Radiated Susceptibility	IEC 61000-4-3	Ed. 3.2 (2010-04) Level III	
Electrical Fast Transients	IEC 61000-4-4	Ed. 3.0 (2012-04) Level IV	
Surges	IEC 61000-4-5	Ed. 2.0 (2005-11) Level IV	
Conducted Susceptibility	IEC 61000-4-6	Ed. 3.0 (2008-10) Level III	
Voltage Dips & Interruptions (AC)	IEC 61000-4-11	Ed. 2.0 (2004-03) All 7 Levels	
Voltage Dips & Interruptions (DC)	IEC 61000-4-29	Ed. 1.0 (2000-08) All 5 Levels	
Conducted Emissions	CISPR 14-1	Ed. 5.2 (2011-11) Class A	
Radiated Emissions	CISPR 14-1	Ed. 5.2 (2011-11) Class A	

<b>Environmental</b>		
Cold heat	IEC 60068-2-1	Ed. 6.0 (2007-03)
Dry Heat	IEC 60068-2-2	Ed. 5.0 (2007-07)
Vibration	IEC 60068-2-6	Ed. 7.0 (2007-12) 5g
Repetitive Shock	IEC 60068-2-27	Ed. 4.0 (2008-02) 40g, 6ms
Non-Repetitive Shock	IEC 60068-2-27	Ed. 4.0 (2008-02) 30g, 15ms

<b>Ordering Information</b>	<b>Description</b>
<b>RS Stock No</b>	110 – 240 VAC Base Module with Display
<a href="#">917-6361</a>	110 – 240 VAC Base Module Without Display
<a href="#">917-6373</a>	12 – 24 VDC Base Module With Display
<a href="#">917-6370</a>	12 – 24 VDC Base Module Without Display
<a href="#">917-6377</a>	110 – 240 VAC Extension Unit
<a href="#">917-6386</a>	12 – 24 VDC Extension Unit
<a href="#">917-6389</a>	Memory Card
<a href="#">917-6399</a>	USB Programming Cable
<a href="#">917-6395</a>	

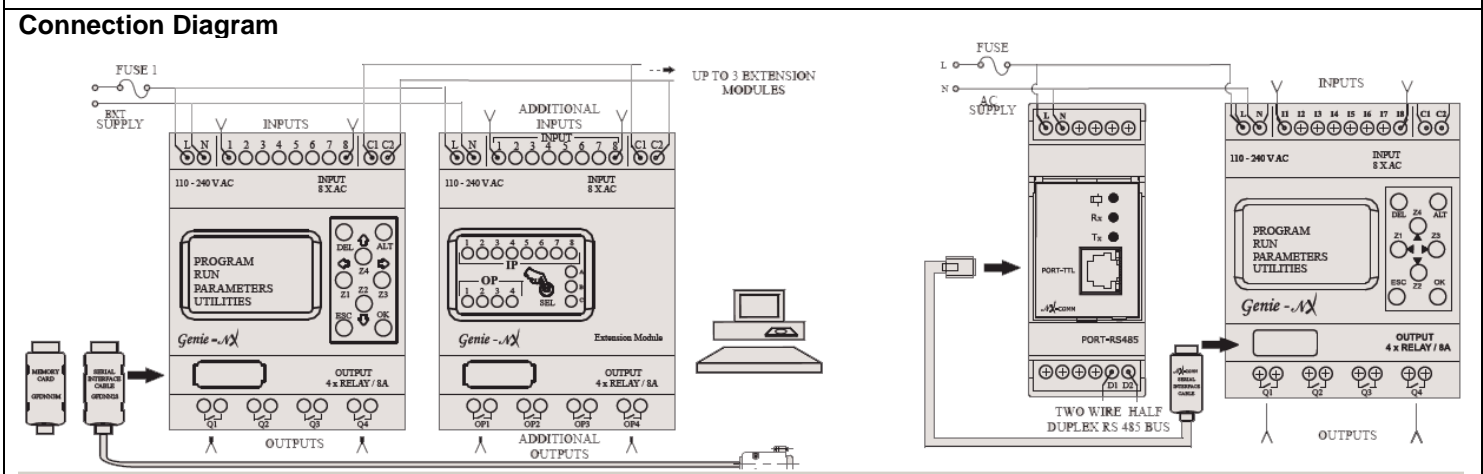
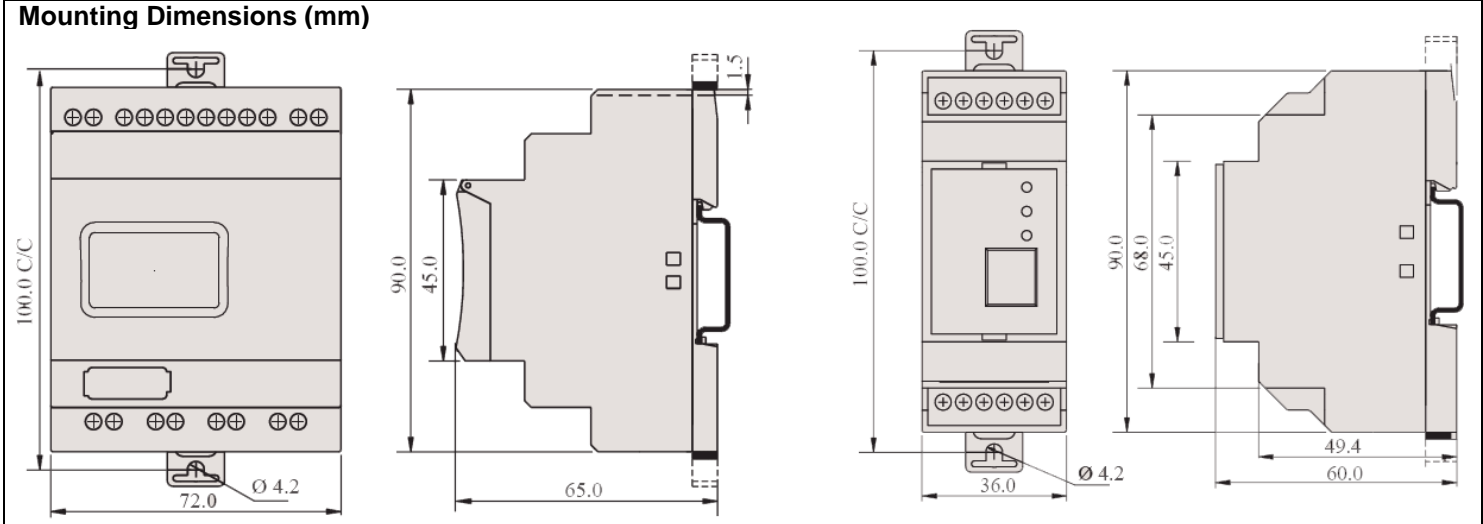

**Terminal Torque & Capacity**

	Torque - 1.1 N.m (10 Lb.in)
Ø 3.5...5.0 mm	Terminal screw - M3.5
	Solid Wire - 2 X 0.2...2.5 mm <sup>2</sup>
AWG	1 X 24 to 10