



Xitanium LED Driver Indoor Dimmable

Xitanium LED Driver 30W/0.70A-42V DIM

LED driver indoor 10W dimmable is a dedicated driver to deliver power to 3 pcs of 700mA LEDs in series, suitable for nominal 220V to 240V, 50Hz and 60Hz mains supply. The driver is to be mounted inside or outside luminaires for indoor use and class II applications. The output must be connected to the 3 LEDs in series LED driver indoor 30W dim is a dedicated driver to deliver power to 6 ~ 12 pcs of 700mA LEDs in series, suitable for nominal 220V to 240V, 50Hz and 60Hz mains supply. The driver is to be mounted inside luminaires for indoor use and class II applications. The output must be connected to the 6 ~ 12 LEDs in series Both drivers convert AC mains to constant current output by an AC/DC transition. Users can connect a trailing edge dimmer at the input side to dim the LEDs' light output

Product data

• Product Data

Order code	064185 30
Full product code	871016306418530
Full product name	Xitanium LED Driver 30W/ 0.70A-42V DIM
Order product name	Xitanium LED Driver 30W/ 0.70A-42V DIM
Pieces per pack	1
Packing configuration	20
Packs per outerbox	20
Bar code on pack - EAN1	8710163064185
Bar code on outerbox - EAN3	8710163064215
Logistic code(s) - 12NC	913710053866
Net weight per piece	0.115 kg

• General Characteristics

Housing	L150x40x28
Input Frequency	50/60 Hz
IP Classification	20
Number of LEDs	6 (min), 12 (max) x

• Operating Characteristics

Efficiency Range	85 %
Output Power Range	0-30 W
Power Factor (100% load)	0.95 -
Input Power max	0-35 W
Output Voltage Range	18-42 V

Output Current Range (mA)	700
Dimming range	100-25 %
Dimmable	Yes
Input Current max	170 mA

• Wiring Characteristics

Connector type input terminal	Insert
Connector type output terminal	Insert

• Temperature Characteristics

T-case maximum	80 C
T-Storage	-40 (min), 85 (max) C
Operating Temperature	-20 (min), 50 (max) C

• Approval&Application Char's

CE marking	Yes
------------	-----

• Product Dimensions

Length A1	150 mm
Width B1	40 mm
Height C1	28 mm
Fixing Hole Diameter D1	4.2 mm
Fixing Hole Distance	136 mm
Length A2	

Xtanium LED Driver Indoor Dimmable

Dimensional drawing

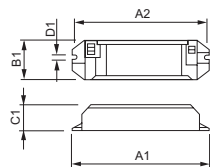

Product	A1 (Norm)	A2 (Norm)	B1 (Norm)	B2 (Norm)	C1 (Norm)	D1 (Norm)
LED Driver 30W/0.70A-42V DIM	150	136	40	-	28	4.2



© 2011 Koninklijke Philips Electronics N.V.
All rights reserved.

Specifications are subject to change without notice. Trademarks are the property of Koninklijke Philips Electronics N.V. or their respective owners.

www.philips.com/lighting

2011, January 11
data subject to change