

Top View of Assembly

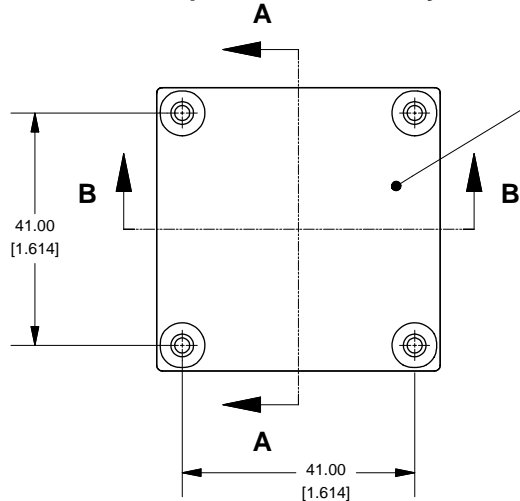

SECTION A-A End View of Assembly

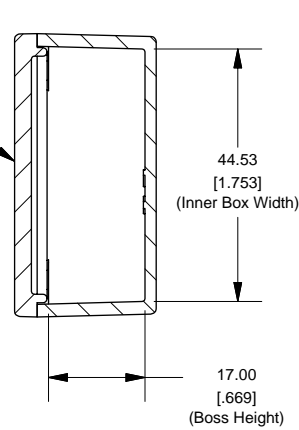

SECTION B-B Side View of Assembly

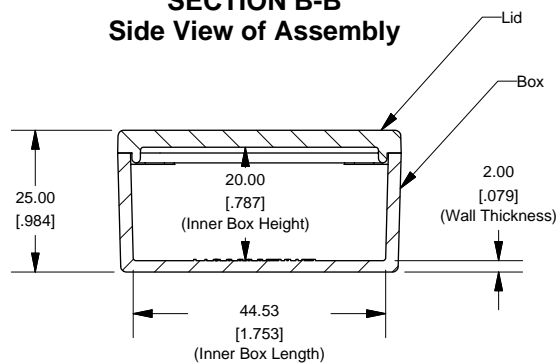

Top View Looking Inside Box

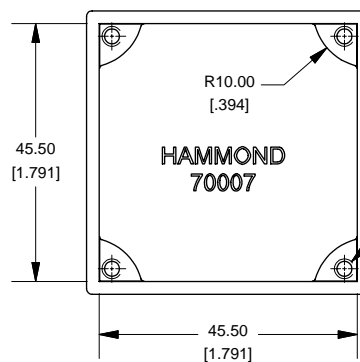

6-32 UNC - 2B ∇ 10.00
(Threaded Holes)

Lid

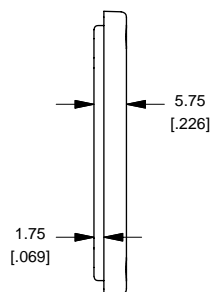
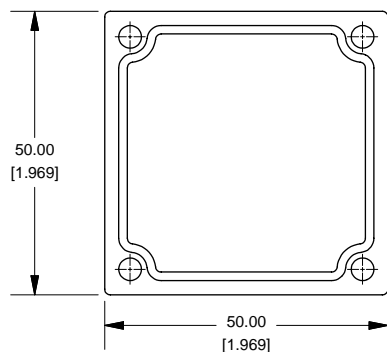

70007 (Basic)

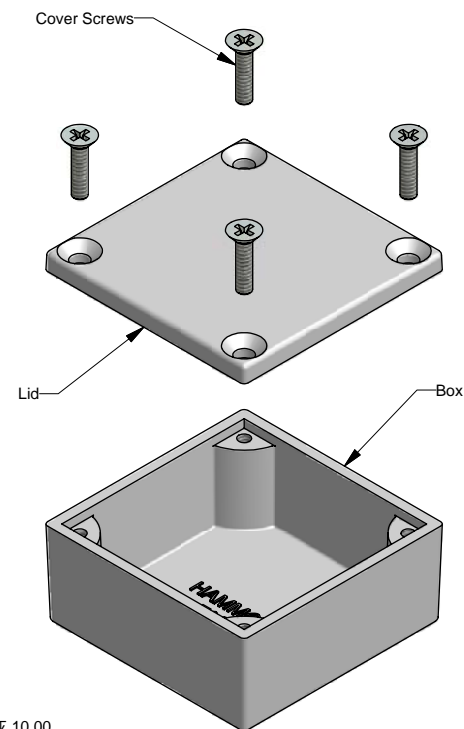

NOTE

Purchased assembly includes box, lid and 4 cover screws.
Box and lid are made from Diecast Aluminum Alloy (alloy type 360.1).

PART NUMBERS

70007 Enclosure	
Unfinished	70007
Black Textured Powder Paint	70007BK
70007 Liquid Resistant Enclosure (Silicon Factory Installed Gasket)	
Unfinished	70007W
Black Textured Powder Paint	70007WBK
ACCESSORIES	
Unfinished	
Cover Screws (Pkg 100)	
[6-32 x 1/2" Nickel Plated Screws]	1590MS100
Black Textured Powder Paint	
Cover Screws (Pkg 50)	
[6-32 x 1/2" Stainless Steel Black Screws]	1590MS50BK



www.hammondmfg.com