

**Ordering number C12500\_MIRA-M**

Family	Mira	FWHM	31 degrees
Type	Lens	Efficiency	85 %
LED	CXA15	cd/lm	2.000
Color	Clear	Gerber File	Available
Diameter	32.4 mm		
Height	14.7 mm		
Style	Round		
Optic Material	PC		
Holder Material	-		
Fastening	-		
Status	Ready		

**Ordering number CN13144\_MIRA-M**

Family	Mira	FWHM	31 degrees
Type	Pack	Efficiency	(simulated) 0 %
LED	CXA15	cd/lm	1.790
Color	Black	Gerber File	Available
Diameter	34.2 mm		
Height	16.15 mm		
Style	Round		
Optic Material	PC		
Holder Material	PC		
Fastening	Screw		
Status	Ready		

**Ordering number C12501\_MIRA-W**

Family	Mira	FWHM	39 degrees
Type	Lens	Efficiency	80 %
LED	CXA15	cd/lm	1.400
Color	Clear	Gerber File	Available
Diameter	32.4 mm		
Height	14.7 mm		
Style	Round		
Optic Material	PC		
Holder Material	-		
Fastening	-		
Status	Ready		

**Ordering number CN13145\_MIRA-W**

Family	Mira	FWHM	42 degrees
Type	Pack	Efficiency	(simulated) 0 %
LED	CXA15	cd/lm	1.200
Color	Black	Gerber File	Available
Diameter	34.2 mm		
Height	16.15 mm		
Style	Round		
Optic Material	PC		
Holder Material	PC		
Fastening	Screw		
Status	Ready		

**Ordering number C12502\_MIRA-WW**

Family	Mira	FWHM	53 degrees
Type	Lens	Efficiency	84 %
LED	CXA15	cd/lm	1.100
Color	Clear	Gerber File	Available
Diameter	32.4 mm		
Height	14.7 mm		
Style	Round		
Optic Material	PC		
Holder Material	-		
Fastening	Glue		
Status	Ready		

**Ordering number CN13146\_MIRA-WW**

Family	Mira	FWHM	57 degrees
Type	Pack	Efficiency	(simulated) 0 %
LED	CXA15	cd/lm	0.820
Color	Black	Gerber File	Available
Diameter	34.2 mm		
Height	16.15 mm		
Style	Round		
Optic Material	PC		
Holder Material	PC		
Fastening	Screw		
Status	Ready		

**NOTE: The typical divergence will be changed by different color, chip size and chip position tolerance. The typical total divergence is the full angle measured where the luminous intensity is half of the peak value.**



## PRODUCT DATASHEET

### Mira series

last update 12/4/2013

#### GENERAL INFORMATION

- Product series especially designed & optimized for CXA15 series of LEDs.
- Special care taken to make light distribution as uniform as possible.
- Lens material optical grade PC with high UV and temperature resistance (120 degrees of Celcius / 248 degrees of Fahrenheit). Allows use of high current and temperature conditions.

Please find more information about used materials from below:

[http://ledil.fi/sites/default/files/Documents/Technical/Material/PC%20Makrolon%202400\\_2407\\_2456\\_2458-UL.pdf](http://ledil.fi/sites/default/files/Documents/Technical/Material/PC%20Makrolon%202400_2407_2456_2458-UL.pdf)

- Optic holder molded by high quality PC material (120 degees of Celcius / 248 degrees of Fahrenheit).

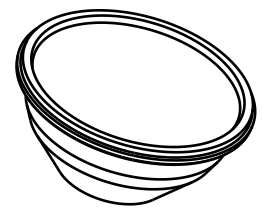

Isometric view

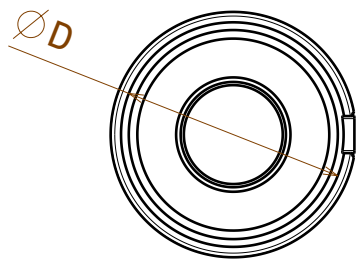

Bottom view

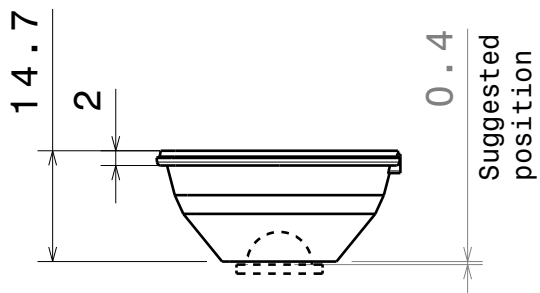

Front view

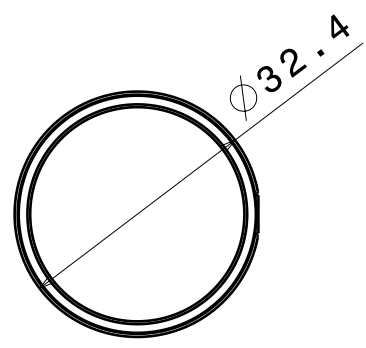

Top view

Dimension D:  
 - C12500\_MIRA-M 29,7mm  
 - C12501\_MIRA-W 28,4mm  
 - C12502\_MIRA-VW 28,4mm

Material: PC

This drawing is our property.  
 It can't be reproduced  
 or communicated without  
 our written agreement.



Ledil Oy  
 Salorankatu 10  
 FIN 24240 SALO  
 Finland

**DRAWING TITLE**

Datasheet MIRA lens

<b>DRAWN BY</b> mav	<b>DATE</b> 02.04.2012			
<b>CHECKED BY</b> sn	<b>DATE</b> 02.04.2012	<b>SIZE</b> A4	<b>DRAWING NUMBER</b> -	<b>REV</b> 1
<b>DESIGNED BY</b> mav	<b>DATE</b> 29.11.2011	<b>SCALE</b> 1:1	<b>WEIGHT (g)</b>	<b>SHEET</b> 1/1