

Ø
16.5
25
40

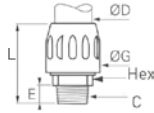

MALE STUD FITTING - BSP TAPER

| Transair® | ØD | C | Hex | E | ØG | L | Kg |
|------------|------|--------|-----|------|------|------|-------|
| 6605 17 13 | 16.5 | R1/4 | 20 | 9.5 | 34 | 62,5 | 0.100 |
| 6605 17 21 | 16.5 | R1/2 | 24 | 12 | 34 | 65 | 0.110 |
| 6605 25 21 | 25 | R1/2 | 30 | 15 | 44.5 | 70 | 0.166 |
| 6605 25 27 | 25 | R3/4 | 30 | 16 | 44.5 | 71 | 0.176 |
| 6605 25 34 | 25 | R1" | 38 | 16 | 44.5 | 71 | 0.230 |
| 6605 40 34 | 40 | R1" | 41 | 16 | 67 | 111 | 0.585 |
| 6605 40 42 | 40 | R1"1/4 | 41 | 19.5 | 67 | 111 | 0.510 |
| 6605 40 49 | 40 | R1"1/2 | 50 | 24.5 | 67 | 115 | 0.625 |

Ø
50
63

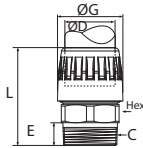

| Transair® | ØD | C | Hex | E | ØG | L | Kg |
|------------|----|--------|-----|------|----|-----|-------|
| 6605 50 49 | 50 | R1"1/2 | 65 | 22.9 | 80 | 121 | 0.567 |
| 6605 50 48 | 50 | R2" | 65 | 27.2 | 80 | 125 | 0.587 |
| 6605 63 48 | 63 | R2" | 80 | 27.2 | 91 | 123 | 0.587 |
| 6605 63 47 | 63 | R2"1/2 | 80 | 30.5 | 91 | 127 | 0.605 |

Ø
25
40
50

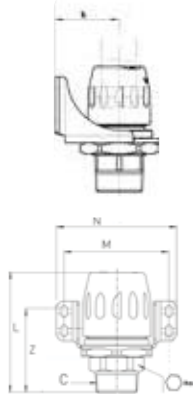

MALE STUD FITTING WITH FIXING PLATE - BSP TAPER

| Transair® | ØD | C | Hex | k | L | M | N | Z | Kg |
|------------|----|--------|-----|----|-----|-----|-----|----|-------|
| 6615 25 21 | 25 | R1/2 | 27 | 46 | 87 | 87 | 102 | 60 | 0.465 |
| 6615 25 27 | 25 | R3/4 | 27 | 46 | 87 | 87 | 102 | 60 | 0.485 |
| 6615 25 34 | 25 | R1" | 34 | 46 | 91 | 87 | 102 | 64 | 0.575 |
| 6615 40 42 | 40 | R1"1/4 | 50 | 46 | 121 | 105 | 120 | 75 | 0.993 |
| 6615 40 49 | 40 | R1"1/2 | 50 | 46 | 121 | 105 | 120 | 75 | 1.106 |
| 6615 50 49 | 50 | R1"1/2 | 65 | 90 | 127 | 117 | 132 | 72 | 0.642 |
| 6615 50 48 | 50 | R2" | 65 | 90 | 131 | 117 | 132 | 73 | 0.719 |

Ø
16.5
25
40
50
63

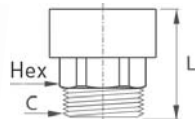

MALE THREADED NUT - BSP TAPER

| Transair® | ØD | C | Hex | L | Kg |
|------------|------|--------|-----|----|-------|
| 6611 17 21 | 16.5 | R1/2 | 23 | 41 | 0.150 |
| 6611 25 21 | 25 | R1/2 | 27 | 43 | 0.172 |
| 6611 25 27 | 25 | R3/4 | 27 | 45 | 0.210 |
| 6611 25 34 | 25 | R1" | 36 | 49 | 0.250 |
| 6611 40 34 | 40 | R1" | 41 | 53 | 0.410 |
| 6611 40 42 | 40 | R1"1/4 | 50 | 61 | 0.480 |
| 6611 40 49 | 40 | R1"1/2 | 50 | 61 | 0.500 |
| 6611 40 48 | 40 | R2" | 60 | 65 | 0.620 |
| 6611 50 49 | 50 | R1"1/2 | 65 | 79 | 0.237 |
| 6611 50 48 | 50 | R2" | 65 | 85 | 0.295 |
| 6611 63 48 | 63 | R2" | 80 | 83 | 0.359 |
| 6611 63 47 | 63 | R2"1/2 | 80 | 87 | 0.372 |

6611 male threaded stud fittings can be used with all Transair® pipe-to-pipe stud connectors (as a replacement for the standard nuts) for Ø16.5 to Ø63mm.