

# Actuator

61-  
0030.02

Distribution by  
Rs-online



<https://rs-online.eao.com/component/61-0030.0...>

Your product:

---



## 61-0030.02 Actuator

### FRONT

|                              |               |
|------------------------------|---------------|
| <b>Front dimension:</b>      | 24 mm x 18 mm |
| <b>Front form:</b>           | Rectangular   |
| <b>Front bezel colour:</b>   | Black         |
| <b>Front bezel material:</b> | Plastic       |

### MOUNTING

|                          |                |
|--------------------------|----------------|
| <b>Mounting cut-out:</b> | Ø 16 mm        |
| <b>Mounting type:</b>    | Panel mounting |

### MECHANICAL CHARACTERISTICS

|                           |                                |
|---------------------------|--------------------------------|
| <b>Terminal:</b>          | Plug-in terminal, 2.8 x 0.5 mm |
| <b>Tightening torque:</b> | Max. 0.5 Nm                    |
| <b>Weight:</b>            | 0.007 kg                       |

### AMBIENT CONDITION

|                               |   |
|-------------------------------|---|
| <b>IP Protection:</b>         | IP40 rear side, according to EN IEC 60529, IP67 front side, according to EN IEC 60529 |
| <b>Operating temperature:</b> | - 25 °C ... + 55 °C   |
| <b>Storage temperature:</b>   | - 40 °C ... + 85 °C   |

### CERTIFICATE

**REACH:** REACH compliant

**RoHS:** RoHS compliant

**OTHER**

**Short Description:** Actuator, Ø 16 mm, 24 mm x 18 mm, Rectangular, Black, Plastic, Plug-in terminal, 2.8 x 0.5 mm

**Internal size:** 21,5 mm x 15,3 mm

**Housing colour:** Black

**Housing material:** Plastic, according to UL 94 V0, self-extinguishing

**Wiring diagrams:**

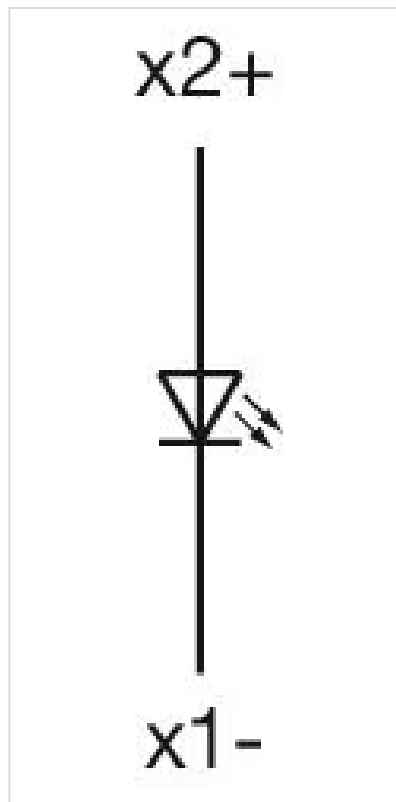

**Mounting cut-outs:**

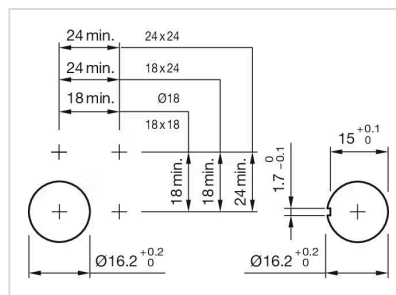

**Dimension drawings:**

