

stud couplings

0114 female stud coupling, parallel BSP

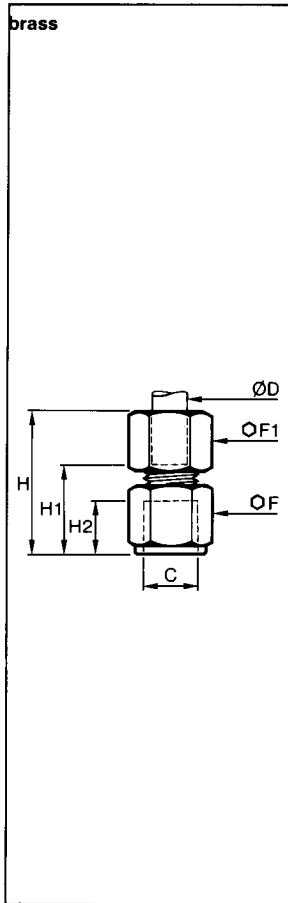
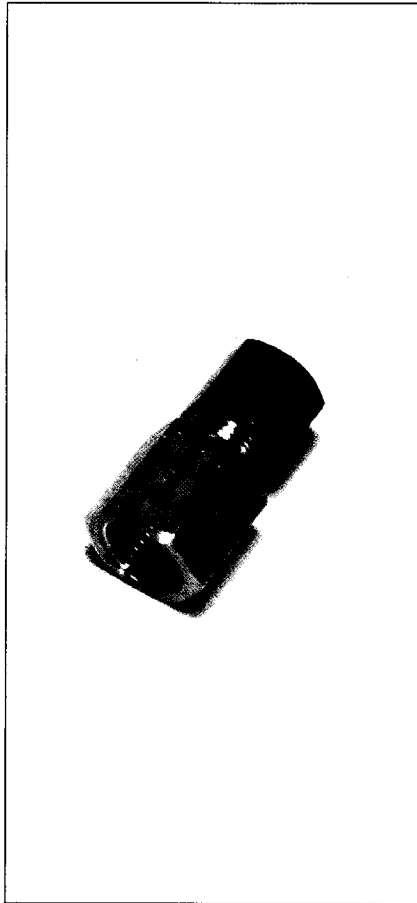

| ØD | C | | F | F1 | H maxi | H1 | H2 | Δkg |
|----|-----|------------|----|----|-----------|------|------|-------|
| 4 | 1/8 | 0114 04 10 | 14 | 10 | 26 | 16,5 | 9,5 | 0,021 |
| 4 | 1/4 | 0114 04 13 | 17 | 10 | 30 | 20,5 | 13,5 | 0,029 |
| 5 | 1/8 | 0114 05 10 | 14 | 12 | 28 | 17 | 9,5 | 0,024 |
| 5 | 1/4 | 0114 05 13 | 17 | 12 | 31 | 21 | 13,5 | 0,033 |
| 6 | 1/8 | 0114 06 10 | 14 | 13 | 28 | 17 | 9,5 | 0,025 |
| 6 | 1/4 | 0114 06 13 | 17 | 13 | 32 | 21 | 13,5 | 0,034 |
| 6 | 3/8 | 0114 06 17 | 22 | 13 | 32 | 21,5 | 14 | 0,051 |
| 8 | 1/8 | 0114 08 10 | 14 | 14 | 29 | 16,5 | 9,5 | 0,027 |
| 8 | 1/4 | 0114 08 13 | 17 | 14 | 33 | 20,5 | 13,5 | 0,035 |
| 8 | 3/8 | 0114 08 17 | 22 | 14 | 34 | 21 | 14 | 0,052 |
| 10 | 1/4 | 0114 10 13 | 17 | 19 | 37 | 21,5 | 13,5 | 0,051 |
| 10 | 3/8 | 0114 10 17 | 22 | 19 | 37 | 22 | 14 | 0,069 |
| 10 | 1/2 | 0114 10 21 | 27 | 19 | 42 | 26,5 | 18,5 | 0,100 |
| 12 | 1/4 | 0114 12 13 | 19 | 22 | 36 | 20,5 | 13,5 | 0,069 |
| 12 | 3/8 | 0114 12 17 | 22 | 22 | 37 | 22 | 14 | 0,077 |
| 12 | 1/2 | 0114 12 21 | 27 | 22 | 42 | 26,5 | 18,5 | 0,109 |
| 14 | 1/4 | 0114 14 13 | 22 | 24 | 36 | 18,5 | 13,5 | 0,084 |
| 14 | 3/8 | 0114 14 17 | 22 | 24 | 38 | 21 | 14 | 0,081 |
| 14 | 1/2 | 0114 14 21 | 27 | 24 | 43 | 25,5 | 18,5 | 0,112 |
| 15 | 3/8 | 0114 15 17 | 22 | 24 | 38 | 21 | 14 | 0,077 |
| 15 | 1/2 | 0114 15 21 | 27 | 24 | 43 | 25,5 | 18,5 | 0,109 |
| 16 | 1/4 | 0114 16 13 | 24 | 27 | 36 | 18 | 13,5 | 0,110 |
| 16 | 3/8 | 0114 16 17 | 24 | 27 | 38 | 20,5 | 14 | 0,106 |
| 16 | 1/2 | 0114 16 21 | 27 | 27 | 44 | 26 | 18,5 | 0,129 |
| 18 | 3/8 | 0114 18 17 | 27 | 30 | 39 | 19,5 | 14 | 0,141 |
| 18 | 1/2 | 0114 18 21 | 27 | 30 | 45 | 26 | 18,5 | 0,146 |
| 18 | 3/4 | 0114 18 27 | 32 | 30 | 46 | 27 | 19,5 | 0,168 |
| 20 | 3/8 | 0114 20 17 | 30 | 32 | 38 | 18 | 14 | 0,162 |
| 20 | 1/2 | 0114 20 21 | 30 | 32 | 44,5 | 24 | 18,5 | 0,174 |
| 20 | 3/4 | 0114 20 27 | 32 | 32 | 47 | 26,5 | 19,5 | 0,171 |
| 22 | 3/4 | 0114 22 27 | 32 | 36 | 48 | 26,5 | 19,5 | 0,201 |
| 25 | 3/4 | 0114 25 27 | 36 | 41 | 50,5 | 26 | 19,5 | 0,298 |

0109 male stud elbow, taper BSP

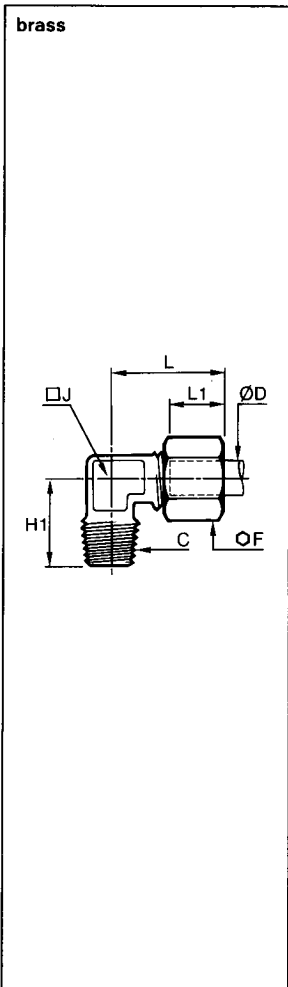
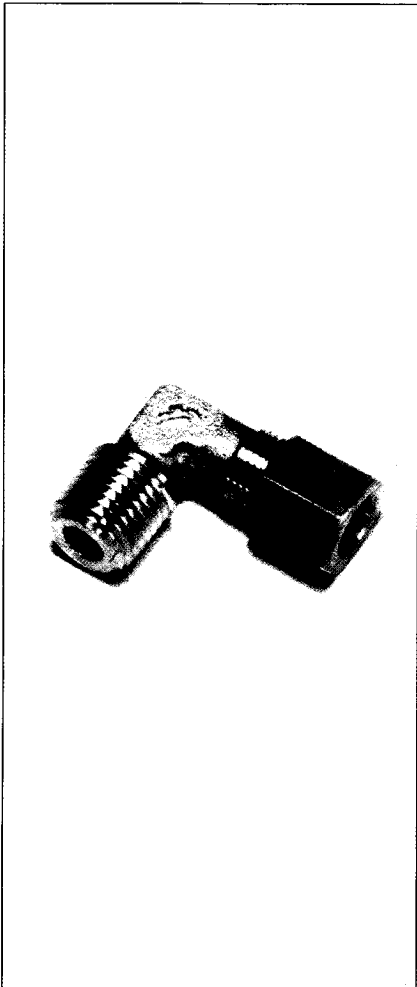

| ØD | C | | F | H1 | J | L maxi | L1 | Δkg |
|----|-----|------------|----|------|----|-----------|------|-------|
| 4 | 1/8 | 0109 04 10 | 10 | 17 | 8 | 19 | 9,5 | 0,017 |
| 4 | 1/4 | 0109 04 13 | 10 | 20 | 10 | 19 | 11 | 0,024 |
| 5 | 1/8 | 0109 05 10 | 12 | 17,5 | 8 | 21 | 11 | 0,019 |
| 5 | 1/4 | 0109 05 13 | 12 | 21,5 | 10 | 22 | 12 | 0,029 |
| 6 | 1/8 | 0109 06 10 | 13 | 18 | 8 | 22 | 11 | 0,021 |
| 6 | 1/4 | 0109 06 13 | 13 | 21,5 | 10 | 22 | 12 | 0,030 |
| 8 | 1/8 | 0109 08 10 | 14 | 18,5 | 10 | 28 | 15 | 0,028 |
| 8 | 1/4 | 0109 08 13 | 14 | 22 | 10 | 28 | 15 | 0,033 |
| 8 | 3/8 | 0109 08 17 | 14 | 24 | 12 | 28 | 15 | 0,044 |
| 10 | 1/4 | 0109 10 13 | 19 | 25 | 12 | 30 | 14,5 | 0,052 |
| 10 | 3/8 | 0109 10 17 | 19 | 25,5 | 12 | 30 | 14,5 | 0,061 |
| 10 | 1/2 | 0109 10 21 | 19 | 32 | 19 | 36 | 21 | 0,105 |
| 12 | 1/4 | 0109 12 13 | 22 | 26 | 15 | 30 | 15 | 0,074 |
| 12 | 3/8 | 0109 12 17 | 22 | 27 | 15 | 30 | 15 | 0,077 |
| 12 | 1/2 | 0109 12 21 | 22 | 32 | 19 | 36 | 21 | 0,117 |
| 14 | 3/8 | 0109 14 17 | 24 | 30 | 19 | 35 | 18 | 0,103 |
| 14 | 1/2 | 0109 14 21 | 24 | 32 | 19 | 35 | 18 | 0,107 |
| 15 | 3/8 | 0109 15 17 | 24 | 30 | 19 | 35 | 18 | 0,104 |
| 15 | 1/2 | 0109 15 21 | 24 | 32 | 19 | 35 | 18 | 0,104 |
| 16 | 3/8 | 0109 16 17 | 27 | 30 | 19 | 39 | 21 | 0,118 |
| 16 | 1/2 | 0109 16 21 | 27 | 33,5 | 19 | 39 | 21 | 0,134 |
| 16 | 3/4 | 0109 16 27 | 27 | 36,5 | 23 | 41 | 23 | 0,186 |
| 18 | 1/2 | 0109 18 21 | 30 | 35,5 | 23 | 41 | 21,5 | 0,175 |
| 18 | 3/4 | 0109 18 27 | 30 | 36,5 | 23 | 41 | 21,5 | 0,201 |
| 20 | 1/2 | 0109 20 21 | 32 | 36,5 | 23 | 42 | 21,5 | 0,174 |
| 20 | 3/4 | 0109 20 27 | 32 | 38 | 23 | 42 | 21,5 | 0,214 |
| 22 | 3/4 | 0109 22 27 | 36 | 40 | 27 | 50 | 30 | 0,294 |
| 22 | 1" | 0109 22 34 | 36 | 44 | 27 | 50 | 30 | 0,322 |
| 25 | 3/4 | 0109 25 27 | 41 | 43 | 27 | 54 | 30 | 0,330 |
| 25 | 1" | 0109 25 34 | 41 | 44 | 27 | 54 | 30 | 0,360 |
| 28 | 3/4 | 0109 28 27 | 42 | 46 | 32 | 54 | 30 | 0,364 |
| 28 | 1" | 0109 28 34 | 42 | 48 | 32 | 54 | 30 | 0,380 |

Taper metric threads or Briggs NPT threads are available to special order, subject to minimum quantities.

stud couplings

0109 male stud elbow, NPT

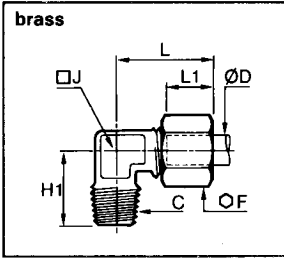
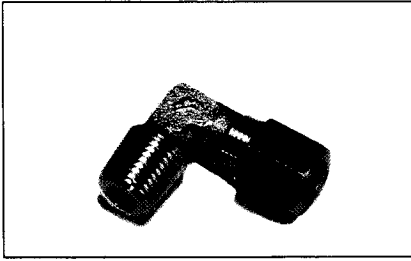

| Ø D | C | | F | H1 | J | L maxi | L1 | Δkg |
|-----|-----|------------|----|------|----|-----------|------|-------|
| 6 | 1/8 | 0109 06 11 | 13 | 18 | 8 | 22 | 11 | 0,021 |
| 6 | 1/4 | 0109 06 14 | 13 | 21,5 | 10 | 22 | 12 | 0,030 |
| 8 | 1/8 | 0109 08 11 | 14 | 18,5 | 10 | 28 | 15 | 0,028 |
| 8 | 1/4 | 0109 08 14 | 14 | 22 | 10 | 28 | 15 | 0,033 |
| 10 | 1/4 | 0109 10 14 | 19 | 25 | 12 | 30 | 14,5 | 0,052 |

0108 male stud branch tee, taper BSP

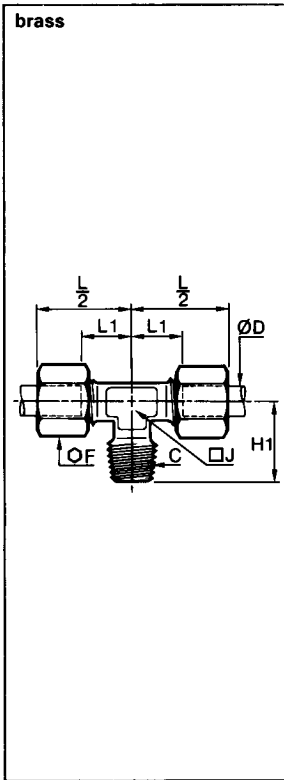
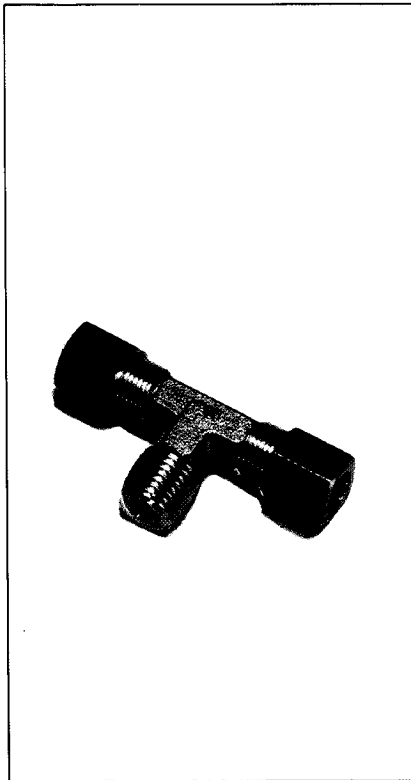

| Ø D | C | | F | H1 | J | L 2 | L1 | Δkg |
|-----|-----|------------|----|------|----|--------|------|-------|
| 4 | 1/8 | 0108 04 10 | 10 | 17 | 8 | 19 | 9,5 | 0,026 |
| 5 | 1/8 | 0108 05 10 | 12 | 17,5 | 8 | 21 | 11 | 0,034 |
| 6 | 1/8 | 0108 06 10 | 13 | 18 | 8 | 22 | 11 | 0,033 |
| 6 | 1/4 | 0108 06 13 | 13 | 21,5 | 10 | 27 | 16 | 0,050 |
| 8 | 1/8 | 0108 08 10 | 14 | 18,5 | 10 | 28 | 15 | 0,046 |
| 8 | 1/4 | 0108 08 13 | 14 | 22 | 10 | 28 | 15 | 0,049 |
| 8 | 3/8 | 0108 08 17 | 14 | 24 | 12 | 28 | 15 | 0,063 |
| 10 | 1/4 | 0108 10 13 | 19 | 25 | 12 | 30 | 14,5 | 0,085 |
| 10 | 3/8 | 0108 10 17 | 19 | 25,5 | 12 | 30 | 14,5 | 0,093 |
| 12 | 1/4 | 0108 12 13 | 22 | 26 | 15 | 30 | 15 | 0,115 |
| 12 | 3/8 | 0108 12 17 | 22 | 27 | 15 | 30 | 15 | 0,118 |
| 14 | 3/8 | 0108 14 17 | 24 | 30 | 19 | 35 | 18 | 0,156 |
| 14 | 1/2 | 0108 14 21 | 24 | 32 | 19 | 35 | 18 | 0,193 |
| 15 | 3/8 | 0108 15 17 | 24 | 30 | 19 | 35 | 18 | 0,145 |
| 15 | 1/2 | 0108 15 21 | 24 | 32 | 19 | 35 | 18 | 0,156 |
| 16 | 3/8 | 0108 16 17 | 27 | 30 | 19 | 39 | 21 | 0,190 |
| 16 | 1/2 | 0108 16 21 | 27 | 33,5 | 19 | 39 | 21 | 0,200 |
| 18 | 1/2 | 0108 18 21 | 30 | 35,5 | 23 | 41 | 21,5 | 0,264 |
| 18 | 3/4 | 0108 18 27 | 30 | 36,5 | 23 | 41 | 21,5 | 0,270 |
| 20 | 3/4 | 0108 20 27 | 32 | 38 | 23 | 42 | 21,5 | 0,280 |
| 22 | 3/4 | 0108 22 27 | 36 | 40 | 27 | 50 | 29 | 0,440 |
| 22 | 1" | 0108 22 34 | 36 | 44 | 27 | 50 | 29 | 0,477 |

Taper metric threads or Briggs NPT threads are available to special order, subject to minimum quantities.

0103 male stud run tee, taper BSP

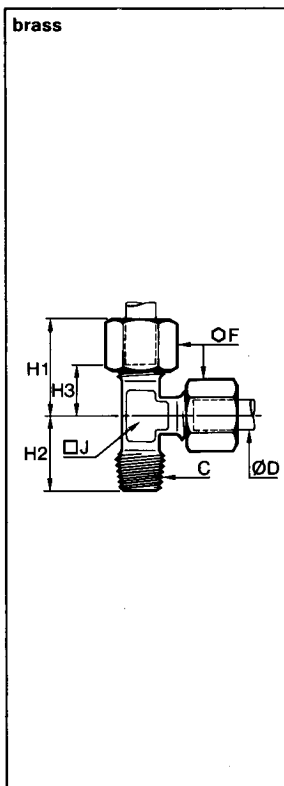
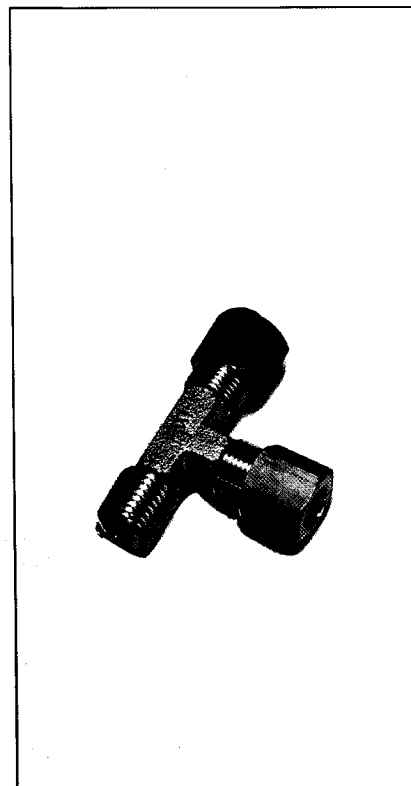

| Ø D | C | | F | H1 maxi | H2 | H3 | J | Δkg |
|-----|-----|------------|----|------------|------|------|----|-------|
| 4 | 1/8 | 0103 04 10 | 10 | 19 | 17 | 9,5 | 8 | 0,026 |
| 5 | 1/8 | 0103 05 10 | 12 | 21 | 17,5 | 11 | 8 | 0,031 |
| 6 | 1/8 | 0103 06 10 | 13 | 22 | 18 | 11 | 8 | 0,031 |
| 6 | 1/4 | 0103 06 13 | 13 | 27 | 21,5 | 16 | 10 | 0,049 |
| 8 | 1/8 | 0103 08 10 | 14 | 28 | 18,5 | 15 | 10 | 0,044 |
| 8 | 1/4 | 0103 08 13 | 14 | 28 | 22 | 15 | 10 | 0,050 |
| 8 | 3/8 | 0103 08 17 | 14 | 28 | 24 | 15 | 12 | 0,062 |
| 10 | 1/4 | 0103 10 13 | 19 | 30 | 25 | 14,5 | 12 | 0,085 |
| 10 | 3/8 | 0103 10 17 | 19 | 30 | 25,5 | 14,5 | 12 | 0,092 |
| 12 | 1/4 | 0103 12 13 | 22 | 30 | 26 | 15 | 15 | 0,113 |
| 12 | 3/8 | 0103 12 17 | 22 | 30 | 27 | 15 | 15 | 0,120 |
| 14 | 3/8 | 0103 14 17 | 24 | 35 | 30 | 18 | 19 | 0,156 |
| 14 | 1/2 | 0103 14 21 | 24 | 35 | 32 | 18 | 19 | 0,166 |
| 15 | 3/8 | 0103 15 17 | 24 | 35 | 30 | 18 | 19 | 0,141 |
| 15 | 1/2 | 0103 15 21 | 24 | 35 | 32 | 18 | 19 | 0,151 |
| 16 | 3/8 | 0103 16 17 | 27 | 39 | 30 | 21 | 19 | 0,189 |
| 16 | 1/2 | 0103 16 21 | 27 | 39 | 33,5 | 21 | 19 | 0,199 |
| 18 | 1/2 | 0103 18 21 | 30 | 41 | 35,5 | 21,5 | 23 | 0,263 |
| 18 | 3/4 | 0103 18 27 | 30 | 41 | 36,5 | 21,5 | 23 | 0,281 |
| 20 | 3/4 | 0103 20 27 | 32 | 42 | 38 | 21,5 | 23 | 0,295 |
| 22 | 3/4 | 0103 22 27 | 36 | 50 | 40 | 29 | 27 | 0,428 |

Taper metric threads or Briggs NPT threads are available to special order, subject to minimum quantities.