

Connector assembly frame - HC-CIF-B10-BFWD-FH-AL - 1404220

Please be informed that the data shown in this PDF Document is generated from our Online Catalog. Please find the complete data in the user's documentation. Our General Terms of Use for Downloads are valid (<http://phoenixcontact.com/download>)



HEAVYCON plug assembly frame, lower part with double locking latch, for housing without double locking latch or HC-CIF-..HFFD.. upper part, for type B10 contact inserts, for NS35/7,5 DIN rails

Why buy this product

- ✓ Sturdy metal version
- ✓ Open base, pre-assembled cable harnesses can be used
- ✓ Standardized design; both PE sheets for inserts are connected conductively
- ✓ Safe capacitive PE even when connected slightly askew



Key commercial data

Packing unit	1 pc
GTIN	 4 046356 681926
Weight per Piece (excluding packing)	173.7 g
Custom tariff number	85389099
Country of origin	Poland

Technical data

Dimensions

Length	93.5 mm
Width	56 mm

Ambient conditions

Ambient temperature (operation)	-40 °C ... 125 °C
---------------------------------	-------------------

General

Type	For B10
Material	Cast aluminum, uncoated
Locking latch material	High-grade steel, handle: PA-GF
Assembly instructions	A double locking latch is not mounted, which means that an assembled cable set can be used more easily

Connector assembly frame - HC-CIF-B10-BFWD-FH-AL - 1404220

Classifications

eCl@ss

eCl@ss 4.0	27140816
eCl@ss 4.1	27140816
eCl@ss 5.0	27143424
eCl@ss 5.1	27143424
eCl@ss 6.0	27143424
eCl@ss 7.0	27440209

ETIM

ETIM 3.0	EC002310
ETIM 4.0	EC002310
ETIM 5.0	EC002310

UNSPSC

UNSPSC 6.01	43172601
UNSPSC 7.0901	39121416
UNSPSC 11	43172601
UNSPSC 12.01	39121408
UNSPSC 13.2	39121408

Approvals

Approvals

Approvals

EAC

Ex Approvals

Approvals submitted

Approval details

EAC

Drawings

Connector assembly frame - HC-CIF-B10-BFWD-FH-AL - 1404220

Dimensioned drawing

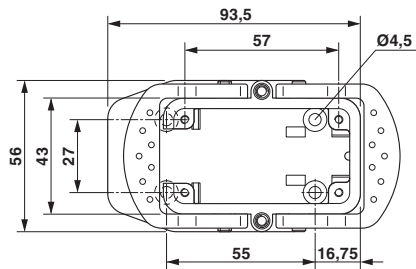

Dimensioned drawing

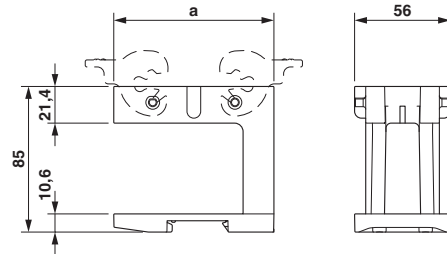

Dimensional drawing top view