



1.5/2.8 Connector System

TE Internal #: 1326359-1
11 Position Housing, Housing for Female Terminals, Wire-to-Board / Wire-to-Wire, 5 mm [.197 in] Centerline, Black, Signal, 1.5/2.8 Connector System

[View on TE.com >](#)

Connectors > Automotive Connectors > Automotive Housings

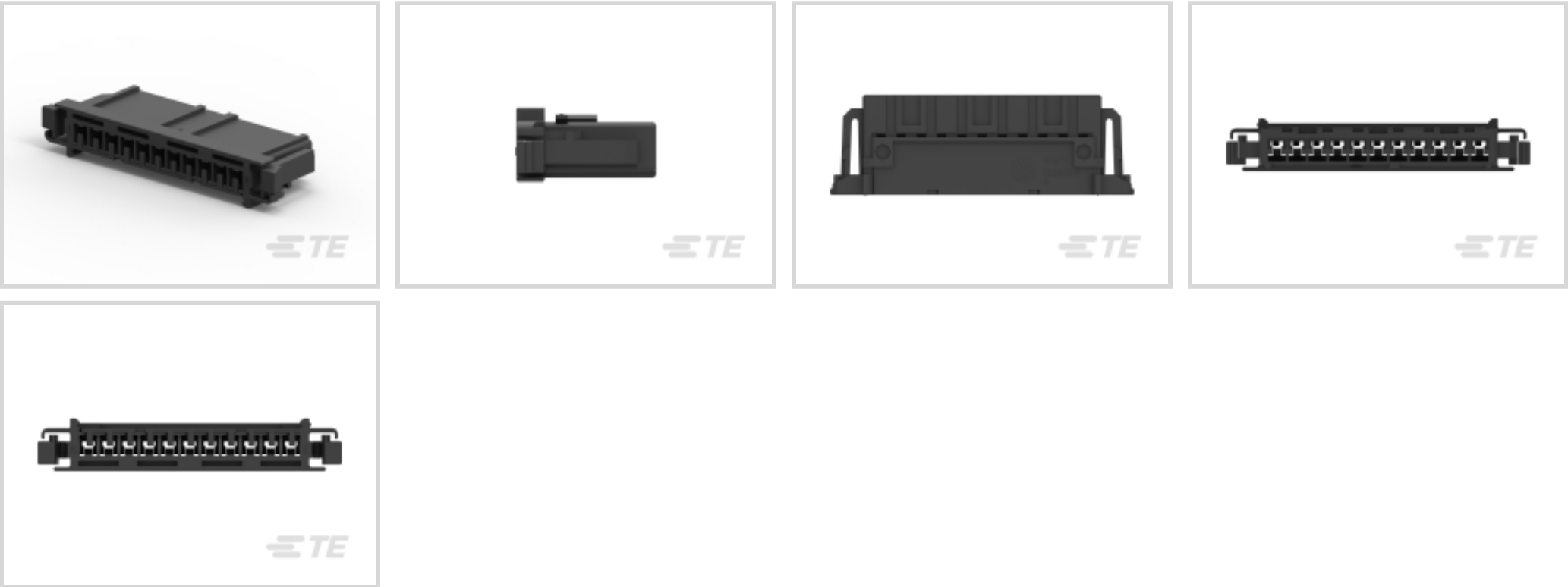

Number of Positions: 11
Connector & Housing Type: Housing for Female Terminals
Mating Tab Width: 2.8 mm [.11 in]
Connector System: Wire-to-Board, Wire-to-Wire
Centerline (Pitch): 5 mm [.197 in]

Features

Product Type Features

Mixed & Hybrid Connector	No
Connector Shape	Rectangular
Connector & Housing Type	Housing for Female Terminals
Connector System	Wire-to-Board, Wire-to-Wire
Sealable	No
Primary Locking Feature	Integrated in Housing

Configuration Features

Number of Positions	11
Number of Rows	1

Body Features

Cable Exit Angle	180°
Primary Product Color	Black
Connector & Keying Code	A

Contact Features



Contact Size	2.8mm
Contact Type	Receptacle
Mating Tab Width	2.8 mm[.11 in]

Mechanical Attachment

Terminal Position Assurance	Yes
Mating Alignment Type	Keyed
Mating Alignment	With
Connector Mounting Type	Cable Mount (Free-Hanging)

Housing Features

Housing Material	PBT
Centerline (Pitch)	5 mm[.197 in]

Dimensions

Product Width	24.7 mm[.972 in]
Product Length	75.13 mm[2.95 in]
Connector Height	25.85 mm[.978 in]

Operation/Application

Circuit Application	Signal
---------------------	--------

Industry Standards

Compatible With Agency/Standards Products	SAE/USCAR-2
---	-------------

Packaging Features

Packaging Method	Package
Packaging Quantity	1

Other

Connector Position Assurance Capable	No
--------------------------------------	----

Product Compliance

For compliance documentation, visit the product page on TE.com>

EU RoHS Directive 2011/65/EU	Compliant
EU ELV Directive 2000/53/EC	Compliant
China RoHS 2 Directive MIIT Order No 32, 2016	No Restricted Materials Above Threshold
EU REACH Regulation (EC) No. 1907/2006	Current ECHA Candidate List: JAN 2025 (247)



Candidate List Declared Against: JAN 2025 (247)
Does not contain REACH SVHC

Halogen Content	Low Halogen - Br, Cl, F, I < 900 ppm per homogenous material. Also BFR/CFR/PVC Free
Solder Process Capability	Not reviewed for solder process capability

Product Compliance Disclaimer

This information is provided based on reasonable inquiry of our suppliers and represents our current actual knowledge based on the information they provided. This information is subject to change. The part numbers that TE has identified as EU RoHS compliant have a maximum concentration of 0.1% by weight in homogenous materials for lead, hexavalent chromium, mercury, PBB, PBDE, DBP, BBP, DEHP, DIBP, and 0.01% for cadmium, or qualify for an exemption to these limits as defined in the Annexes of Directive 2011/65/EU (RoHS2). Finished electrical and electronic equipment products will be CE marked as required by Directive 2011/65/EU. Components may not be CE marked. Additionally, the part numbers that TE has identified as EU ELV compliant have a maximum concentration of 0.1% by weight in homogenous materials for lead, hexavalent chromium, and mercury, and 0.01% for cadmium, or qualify for an exemption to these limits as defined in the Annexes of Directive 2000/53/EC (ELV). Regarding the REACH Regulation, the information TE provides on SVHC in articles for this part number is based on the latest European Chemicals Agency (ECHA) 'Guidance on requirements for substances in articles' posted at this URL: <https://echa.europa.eu/guidance-documents/guidance-on-reach>

Compatible Parts



TE Part # CAT-A11-T273
1.5/2.8 CONNECTOR SYSTEM, RECPT AND TAB

Also in the Series | 1.5/2.8 Connector System



Automotive Connector Caps & Covers (3)



Automotive Headers(1)



Automotive Housings(24)

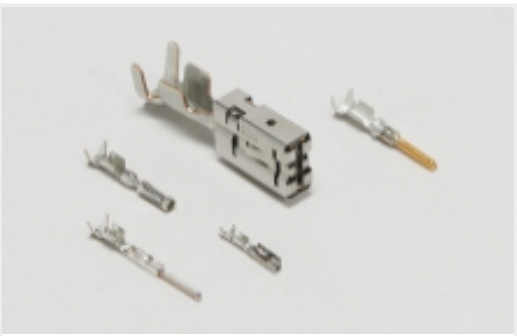

Automotive Terminals(47)



Insertion & Extraction Tools(1)

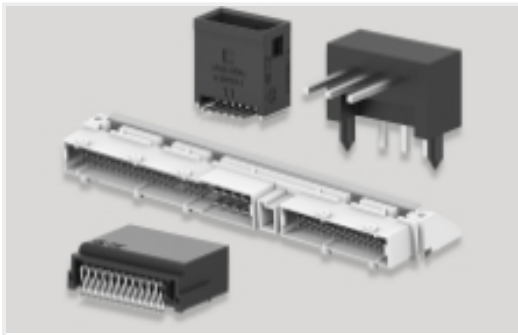

PCB Headers & Receptacles(1)

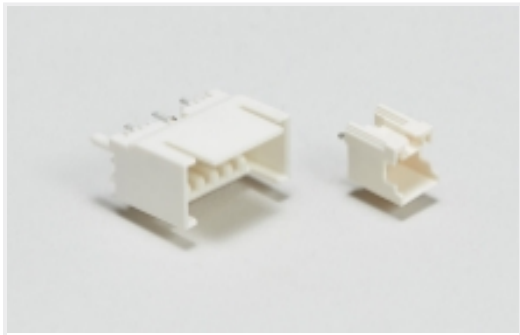

Wire-to-Board Headers & Receptacles (1)

Customers Also Bought

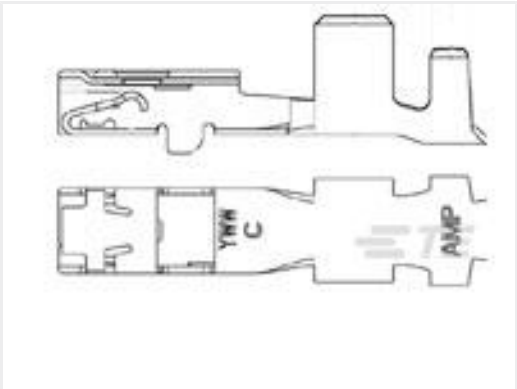

TE Part #1326030-7
2.8MM RECP,UNSEAL,14-16AWG,REV



TE Part #1-2177198-1
COVER,10 POS. MQS,BL



TE Part #2-1393366-2
GET-SOCKET TERMINAL, SILVER VE



TE Part #1379218-2
COVER FOR 5W MPQ+MQS HSG



TE Part #638551-1
CONTACT,FEMALE,0.64MM,SN,18-20

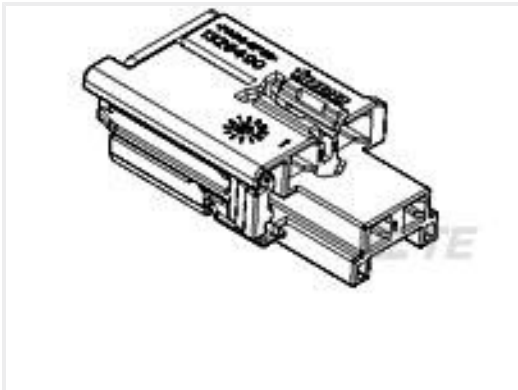

TE Part #1326490-3
4P JPT/MT3 PLUG W/LATCH,GRAY



TE Part #171892-1
9CIR MIC PLUG HSG

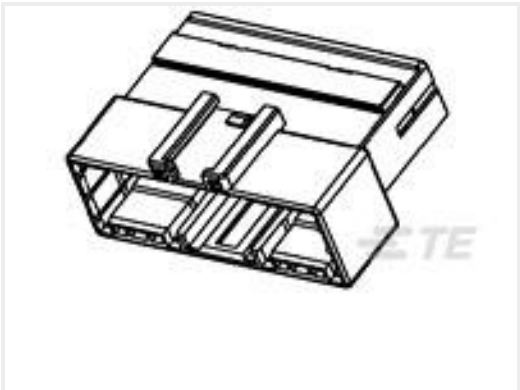

TE Part #936129-1
090III 10P CAP ASSY



TE Part #1745005-1
18 POS. REC. HSG. 2.54 MM PITC



TE Part #1326362-1
26WAY LAC "COMMON" SHIELD ASMB

Documents

Product Drawings

11P 2.8MM LVG-HNG PLUG - KEY A

English

CAD Files

Customer View Model

ENG_CVM_CVM_1326359-1_D.2d_dxf.zip

English

3D PDF



3D

Customer View Model

[ENG_CVM_CVM_1326359-1_D.3d_igs.zip](#)

English

Customer View Model

[ENG_CVM_CVM_1326359-1_D.3d_stp.zip](#)

English

By downloading the CAD file I accept and agree to the [Terms and Conditions](#) of use.

Instruction Sheets

[Instruction Sheet \(U.S.\)](#)

English