

Productgegevensblad

## LUHR 25

Lineaire lagereenheid zonder seals

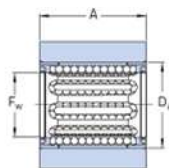

LUHR  
With double lip seal

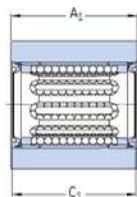

LUJR  
With shaft seals

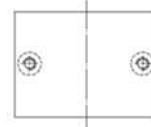
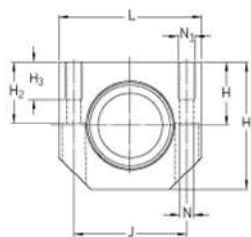

A [mm]:	40
D = Da [mm]:	35
Fw [mm]:	25
H [mm]:	27
H1 [mm]:	54
H2 [mm]:	26
H3 [mm]:	18
J [mm]:	48
L [mm]:	62
N [mm]:	6.6
N1:	M8
Kogelbanen [#]:	7
Cdyn [N]:	2120

Datum: 21/05/2020

The contents of this report are the copyright of the publisher and may not be reproduced (even extracts) unless permission is granted. Every care has been taken to ensure the accuracy of the information contained in this report but no liability can be accepted for any loss or damage whether direct, indirect or consequential arising out of the use of the information contained herein.

Productgegevensblad

## LUHR 25

Lineaire lagereenheid zonder seals

C0 [N]:	1560
Gewicht [kg]:	0.25
A1[mm]:	49
C1[mm]:	48

**Datum:** 21/05/2020

The contents of this report are the copyright of the publisher and may not be reproduced (even extracts) unless permission is granted. Every care has been taken to ensure the accuracy of the information contained in this report but no liability can be accepted for any loss or damage whether direct, indirect or consequential arising out of the use of the information contained herein.