

RS PRO SP17 In-Line Cable Mount Connector

Features

- Threaded Coupling
- IP68
- 2-10 Poles
- Plug & Socket Set
- Cable to Cable Connections

RS Stock No.:

0304392
0304394
0304395
0304397
0304398
0304401
0304402
0304404
0304405
0304407
0304408
0304409



RS PRO is the own brand of RS. The RS PRO Seal of Approval is your assurance of professional quality, a guarantee that every part is rigorously tested, inspected, and audited against demanding. Making RS PRO the Smart Choice for our customers.

The RS Pro SP17 series is a range of lightweight but robust waterproof connectors, which are sealed to IP68. Threaded coupling ensures a secure connection, even in the harshest environments. Plugs and receptacles are available with either male pins or female sockets. These products are ideal for use in outdoor applications where a secure, waterproof connection is required. Updated shell offering an improved seal, which increases reliability and durability.

## General Specifications

<b>Housing Material</b>	PC, Nylon66, Fire Resistance: V-0
<b>Size</b>	SP17
<b>Cable outer diameter range</b>	6-10mm
<b>Body Orientation</b>	Straight
<b>Colour</b>	Black
<b>Temperature Range</b>	-40~ +85°C
<b>Mounting Type</b>	In-Line Cable Mount
<b>Mating Cycle</b>	500
<b>Application</b>	Outdoor Lighting, LED Screens, Outdoor Security Cameras, and Industrial Control Systems.

## Solder Contact Options

Number of contact	2	3	4	2B	3B	4B	5	7	9	10
Male contact face view										

## Crimp Contact Options

SF16, SA16, SP17, SY17 WS16, WF16, WY16	1 cable to cable only	2	3	4
Male contact face view				

## Electrical Specifications

# SP17 In-Line Cable Mount Connector



RS Article Number (Set)	0304392		0304395	
RS Article Number (Individual)	SP1710/P2-1N-B-NP	SP1711C/S2-1N-B-NP	SP1710/P3-1N-B-NP	SP1711C/S3-1N-B-NP
Specification	2 Pin	2 Pin	3 Pin	3 Pin
Rated Current (A)	10	10	10	10
Contact Diameter (Ø mm)	1.5	1.5	1.5	1.5
Rated Voltage (AC.V)	500	500	500	500
Test Voltage (AV.V) 1 min	1500	1500	1500	1500
Contact Resistance (m Ω)	2.5	2.5	2.5	2.5
Wire Size (mm <sup>2</sup> / AWG)	≤2/14	≤2/14	≤2/14	≤2/14
Contact Gender	Male	Female	Male	Female
Shell Type	Plug	Receptacle	Plug	Receptacle
Termination	Solder	Solder	Solder	Solder

RS Article Number (Set)	0304401		0304404	
RS Article Number (Individual)	SP1710/P4-1N-B-NP	SP1711C/S4-1N-B-NP	SP1710/P4B-1N-B-NP	SP1711C/S4B-1N-B-NP
Specification	4 Pin	4 Pin	4 Pin (B)	4 Pin (B)
Rated Current (A)	5	5	15	15
Contact Diameter (Ø mm)	1	1	2	2
Rated Voltage (AC.V)	500	500	500	500
Test Voltage (AV.V) 1 min	1500	1500	1500	1500
Contact Resistance (m Ω)	5	5	2.5	2.5
Wire Size (mm <sup>2</sup> / AWG)	≤0.75/18	≤0.75/18	≤2/14	≤2/14
Contact Gender	Male	Female	Male	Female
Shell Type	Plug	Receptacle	Plug	Receptacle
Termination	Solder	Solder	Solder	Solder

## Electrical Specifications

RS Article Number (Set)	0304407		0304408	
RS Article Number (Individual)	SP1710/S5-1N-B-NP	SP1711C/P5-1N-B-NP	SP1710/S7-1N-B-NP	SP1711C/P7-1N-B-NP
Specification	5 Pin	5 Pin	7 Pin	7 Pin
Rated Current (A)	5	5	5	5
Contact Diameter (Ø mm)	5	5	7	7
Rated Voltage (AC.V)	500	500	400	400
Test Voltage (AV.V) 1 min	1500	1500	1200	1200
Contact Resistance (m Ω)	5	5	5	5
Wire Size (mm <sup>2</sup> / AWG)	≤0.75/18	≤0.75/18	≤0.75/18	≤0.75/18
Contact Gender	Female	Male	Female	Male
Shell Type	Plug	Receptacle	Plug	Receptacle
Termination	Solder	Solder	Solder	Solder

RS Article Number (Set)	0304409		0304405	
RS Article Number (Individual)	SP1710/S9-1N-B-NP	SP1711C/P9-1N-B-NP	SP1710/S10-1N-B-NP	SP1711C/P10-1N-B-NP
Specification	9 Pin	9 Pin	10 Pin	10 Pin
Rated Current (A)	5	5	5	5
Contact Diameter (Ø mm)	9	9	10	10
Rated Voltage (AC.V)	400	400	400	400
Test Voltage (AV.V) 1 min	1200	1200	1200	1200
Contact Resistance (m Ω)	5	5	5	5
Wire Size (mm <sup>2</sup> / AWG)	≤0.75/18	≤0.75/18	≤0.75/18	≤0.75/18
Contact Gender	Female	Male	Female	Male
Shell Type	Plug	Receptacle	Plug	Receptacle
Termination	Solder	Solder	Solder	Solder

RS Article Number (Set)	0304394		0304397	
RS Article Number (Individual)	SP1710/P2-3N-B-NP	SP1711C/S2-3N-B-NP	SP1710/P3-3N-B-NP	SP1711C/S3-3N-B-NP
Specification	2 Pin	2 Pin	3 Pin	3 Pin
Rated Current (A)	10	10	10	10
Contact Diameter (Ø mm)	1.5	1.5	1.5	1.5
Rated Voltage (AC.V)	500	500	500	500
Test Voltage (AV.V) 1 min	1500	1500	1500	1500
Contact Resistance (m Ω)	2.5	2.5	2.5	2.5
Contact Gender	Male	Female	Male	Female
Shell Type	Plug	Receptacle	Plug	Receptacle
Termination	Crimp	Crimp	Crimp	Crimp

RS Article Number (Set)	0304398		0304402	
RS Article Number (Individual)	SP1710/P3-3N-SHELL-B-NP	SP1711C/S3-3N-SHELL-B-NP	SP1710/P4-3N-B-NP	SP1711C/S4-3N-B-NP
Specification	3 Pin	3 Pin	4 Pin	4 Pin
Rated Current (A)	10	10	5	5
Contact Diameter (Ø mm)	1.5	1.5	4	4
Rated Voltage (AC.V)	500	500	400	400
Test Voltage (AV.V) 1 min	1500	1500	1200	1200
Contact Resistance (m Ω)	2.5	2.5	5	5
Contact Gender	Male	Female	Male	Female
Shell Type	Plug	Receptacle	Plug	Receptacle
Termination	Crimp (not included)	Crimp (not included)	Crimp	Crimp

**Protection Category**

IP Rating

IP68

## Dimensional Line Drawings

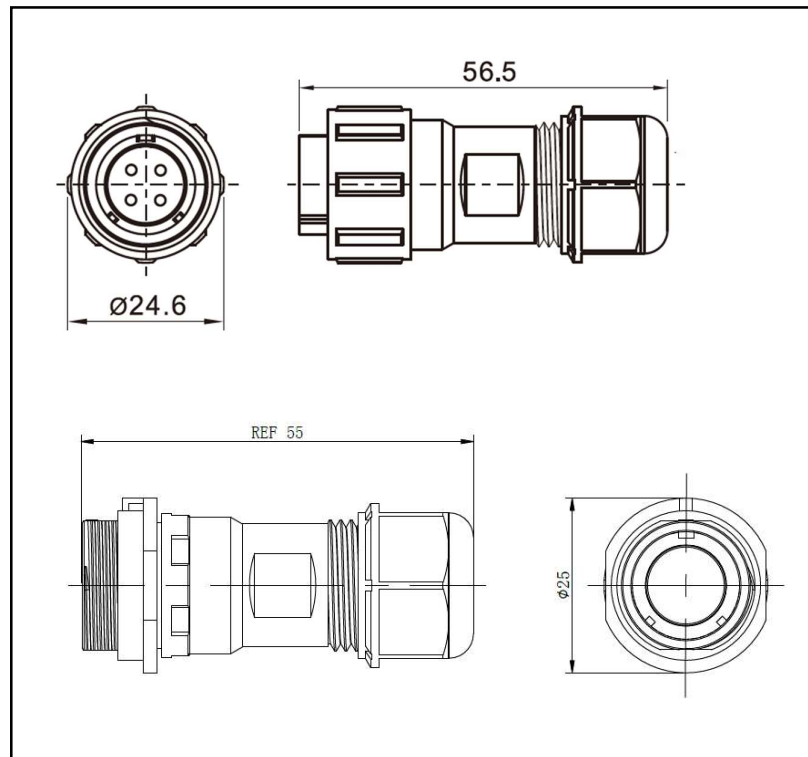

Connection Diagrams / Assembly Diagrams / Illustrations / Accessories