

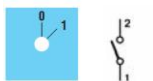

Part No	Description	Front Plate (mm)
GX2090U	20A AC1 One Pole - One Wafer - Scheme 90	48x48
GX2091U	20A AC1 Two Pole - One Wafer - Scheme 91	48x48
GX2010U	20A AC1 Three Pole - Two Wafers - Scheme 10	48x48
GX2092U	20A AC1 Four Pole - Two Wafers - Scheme 92	48x48

90 - One-pole ON/OFF switch



Number of wafers: 1  
Switching angle: 60°

91 - Two-pole ON/OFF switch

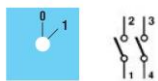

Number of wafers: 1  
Switching angle: 60°

10 - Three-pole ON/OFF switch

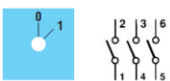

Number of wafers: 2  
Switching angle: 60°

92 - Four-pole ON/OFF switch

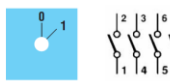

Number of wafers: 2  
Switching angle: 60°

### General characteristics

- IEC 16 to 40A conventional free air thermal current Ith ratings
- Extended mechanical and electrical life
- Rotation angles: 30°, 45°, 60° and 90°
- Silver-alloy dual-breaking contacts
- Direct (positive) opening action ⊖; safety function according to IEC/EN 60947-5-1
- IEC IP65 front degree of protection; IEC IP20 protection of contacts

### Example of U version switch mounting

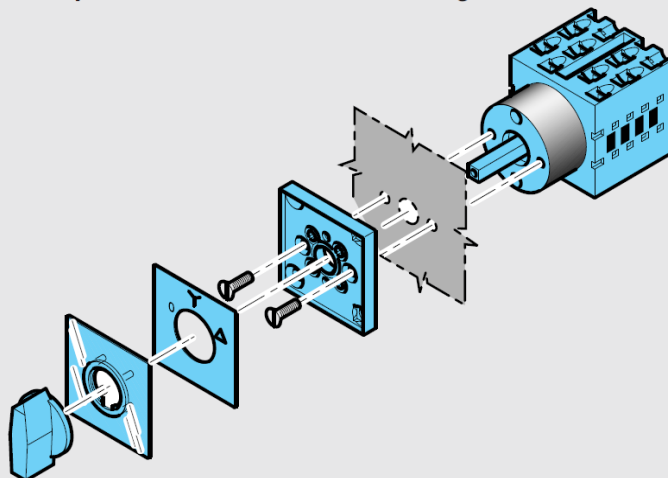

### Certifications and compliance

Certifications obtained: EAC; UL Listed, for USA and Canada (File E155982) as Manual Motor Controllers. Compliant with standards: IEC/EN 60947-1, IEC/EN 60947-3, IEC/EN 60947-5-1, IEC/EN 61058-1, UL508, CSA C22.2 n° 14.

TYPE		GX16	GX20
Mechanical life	cycles	5x10 <sup>6</sup>	5x10 <sup>6</sup>
Terminal screw	M	3	3
Tightening torque	max Nm	0.5	0.8
Conductor cross section	max. r/f	2 mm <sup>2</sup>	2.5/2.5
	2 AWG	14/14	14/14
r: rigid/solid f: flexible/stranded	min. r/f	2 mm <sup>2</sup>	0.5/0.5
	2 AWG	20/20	20/20

TYPE		GX16	GX20	
Rated insulation voltage U <sub>i</sub>	IEC/EN	V	690	
	UL/CSA	V	600	
Rated impulse withstand voltage U <sub>imp</sub>	IEC/EN 60947-3	kV	6	
	Conventional free air thermal current I <sub>th</sub> IEC/EN	A	16	
	UL/CSA (general purpose use)	A	12	
	Rated operating voltage (switch disconnect)	V	440	
Operational impulse voltage (switch disconnect)		kV	4	
	Maximum fuse size for short-circuit protection	10kA	A	
In (gG)	25kA	A	16	
	50kA	A	-	
	63kA	A	-	
Short-time withstand current I <sub>cw</sub>	1sec	A	250	
	Rated operational current I <sub>e</sub>	AC1/AC21A (IEC/EN)	A	
AC15 (IEC/EN)	110V	A	10	
	220-230V	A	8	
	380-400V	A	4	
	660-690V	A	3	
Motor power for switches in AC utilisation categories AC3 (IEC/EN)	220-230V	kW	3.5	
	3 phases	380-440V	kW	4.5
	500-690V	kW	5.5	
1 phase (2 poles)	110V	kW	0.55	
	220-230V	kW	1.5	
AC23A (IEC/EN)	380-440V	kW	2.2	
	220-230V	kW	3.7	
3 phases	380-440V	kW	6.5	
	500-690V	kW	7.5	
	1 phase (2 poles)	110V	kW	0.75
220-230V	kW	1.8	2.2	
	380-440V	kW	3	3.5
	Motor power for direct-on-line control (UL/CSA-DOL) 3 phases	120V	HP	1.5
230V	HP	3	3	
	480V	HP	5	5
	600V	HP	5	5
	1 phase (2 poles)	120V	HP	0.75
230V	HP	1	1.5	
Motor power for switches in DC utilisation categories 1 contact DC21A	48V	A	16	
	60V	A	16	
I <sub>e</sub>	110V	A	4	
	220V	A	0.5	
	440V	A	0.25	0.25
	DC23A	24V	A	16(1)
48V		A	16(2)	
I <sub>e</sub>	60V	A	16(3)	
	110V	A	10(3)	
	220V	A	7(4)	
No. of contacts connected in series are indicated in brackets			8(4)	