

## RefLED ES50 V3

RefLED ES50 V3 5W 345lm 865 36° SL

0027435



### Range Features

- Up to 90% energy saving comparing to halogen.
- High light output - real retrofit for the halogen lamps (36W, 50W and 60W replacements).
- Perfect shape and size for a perfect fit in your luminaire.
- Choice of beam angles to suit lighting needs (36 degree or ultra wide beam 110 degree).
- Available in different colour temperatures: 2700K Homelight, 3000K Warm white, 4000K Cool white and 6500K Daylight.
- Dimmable option available on approved dimmers \*.
- Highly efficient - up to 71Lm/W.
- Average rated life of 15,000 hours.
- 3 year Warranty.

## PRODUCT OVERVIEW

Lamp finish	White
Lamp shape	GU10/ES50
Colour temperature (K)	6500
CRI (Ra)	80
Dimmable	No
EAN code	5410288274355
Energy class	A+
Equivalent watt (W)	50
Cap/Base	GU10
Beam angle(°)	36
Type	RefLED ES50 V3
Watt (Nominal) (W)	5
Light colour	865 Daylight
Ordering number	0027435
Efficacy (Rated) (lm/w)	69
Average life (Rated) (h)	15000
Luminous flux (Rated) (lm)	345
Technology	LED
Voltage (V)	220-240
Colour consistency (SDCM)	6

## DATA TABLE

### General data

Average life (Nominal) (h)	15000
Control gear required	No
Lamp finish	White

## RefLED ES50 V3

RefLED ES50 V3 5W 345lm 865 36° SL

**0027435**

<b>Lamp shape</b>	GU10/ES50
<b>Control gear availability</b>	No
<b>Dimmable</b>	No
<b>EAN code</b>	5410288274355
<b>Energy class</b>	A+
<b>Energy saving lamp</b>	Yes
<b>General application</b>	Hospitality; Residential & Consumer
<b>Intended purpose</b>	General lighting
<b>Cap/Base</b>	GU10
<b>Lamp mercury content (mg)</b>	0
<b>Type</b>	RefLED ES50 V3
<b>No. of switching cycles before premature failure (min)</b>	12500
<b>Optimal operating condition (°C)</b>	25
<b>Ordering number</b>	0027435

Up to 90% energy saving comparing to halogen.  
 High light output - real retrofit for the halogen lamps (36W, 50W and 60W replacements).  
 Perfect shape and size for a perfect fit in your luminaire.  
 Choice of beam angles to suit lighting needs (36 degree or ultra wide beam 110 degree).  
 Available in different colour temperatures: 2700K Homelight, 3000K Warm white, 4000K Cool white and 6500K Daylight.  
 Dimmable option available on approved dimmers \*.  
 Highly efficient - up to 71Lm/W.  
 Average rated life of 15,000 hours.  
 3 year Warranty.

<b>Product name</b>	RefLED ES50 V3 5W 345lm 865 36° SL
<b>Average life (Rated) (h)</b>	15000
<b>Special purpose lamp</b>	No
<b>Starting time (max) (s)</b>	<0,5
<b>Technology</b>	LED
<b>Transformer required</b>	No
<b>Warm-up time to 60% of full light (max) (s)</b>	< 2s => 95%

**Product features**

Good every day quality from a brand you can trust. RefLED ES50 V3 delivers a cost effective solution to replacing halogen GU10 with LED offering 345lm of light equivalent to a 50W halogen lamp while extending lamp life to 15,000 hours. GU10 cap. 36 degree beam angle in daylight 6500K. Backed by a 3 year warranty. CCSMD Technology delivers a halogen look lens with high efficiency and good thermal control.

### Optical data

<b>Chromaticity coordinate X</b>	0.312
<b>Chromaticity coordinate Y</b>	0.324
<b>Colour temperature (K)</b>	6500

## RefLED ES50 V3

RefLED ES50 V3 5W 345lm 865 36° SL

**0027435**

<b>CRI (Ra)</b>	80
<b>Beam angle(°)</b>	36
<b>Light colour</b>	865 Daylight
<b>Lumen maintenance at end of nominal life (%)</b>	70
<b>Luminous flux (Nominal) (lm)</b>	345
<b>Peak intensity (cd)</b>	810
<b>Luminous flux (Rated) (lm)</b>	345
<b>Suitable for accent lighting</b>	Yes
<b>Beam angle (Rated) (°)</b>	36
<b>Adjustable chromaticity</b>	No
<b>Colour consistency (SDCM)</b>	6

### Electrical data

<b>Current (A)</b>	44
<b>Equivalent watt (W)</b>	50
<b>kWh per 1000 hours burning time</b>	5
<b>Lamp power factor</b>	0.5
<b>Watt (Nominal) (W)</b>	5
<b>Efficacy (Rated) (lm/w)</b>	69
<b>Watt (Rated) (W)</b>	0
<b>Voltage (V)</b>	220-240

### Physical data

<b>Max. Lamp Diameter (mm) - D</b>	50
<b>Lamp Length (mm) - C/L</b>	54
<b>Lamp dimension equal to filament lamp equivalent</b>	Yes
<b>Designed for optimum use in non standard conditions</b>	No
<b>Fluorescent lamp replacement</b>	No

## TECHNICAL DRAWINGS

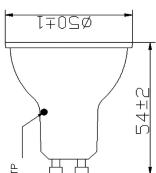

## RefLED ES50 V3

RefLED ES50 V3 5W 345lm 865 36° SL

**0027435**

